



7 Maple Gardens

, Bath, BA2 3AG

£525,000

A three bedroomed 1950s semi-detached house tucked away in a sought after cul-de-sac location on the southern slopes of Bath, just below Bear Flat. There is great potential to add a side and rear extension to the property, plans approved.

- Semi-detached house
- Three bedrooms
- Kitchen/Diner
- Two Reception Rooms
- Three double bedrooms
- Utility area
- Driveway parking
- Planning approved for side & rear extension as well as loft conversion

Viewing

Please contact our Bath Stone Property Office on 01225422224 if you wish to arrange a viewing appointment for this property or require further information.



Floor Plan

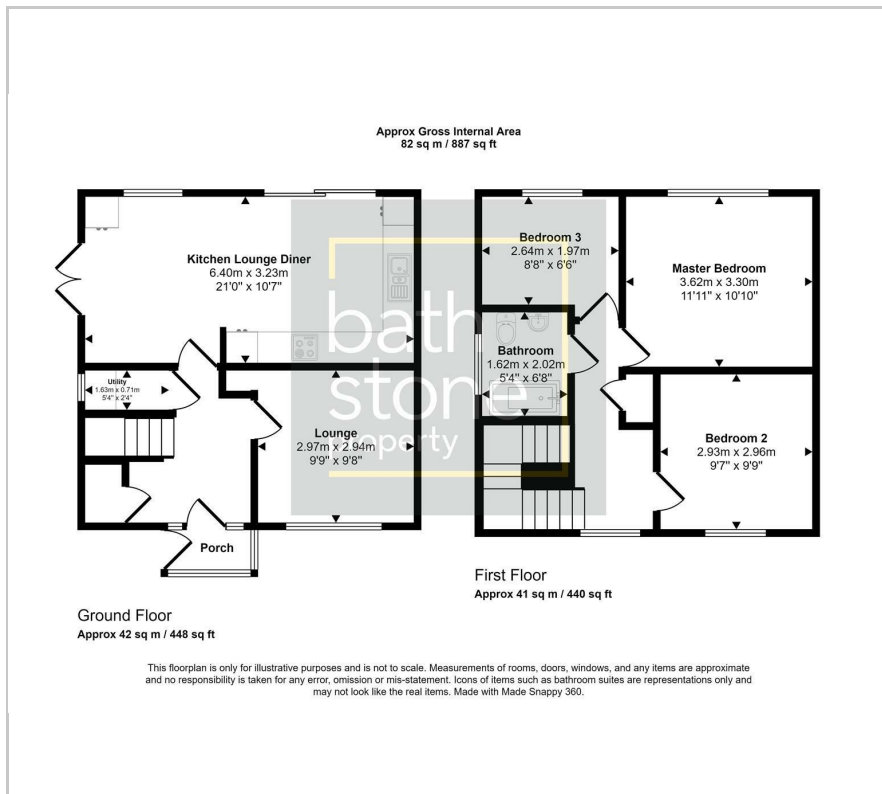

Area Map



Energy Efficiency Graph

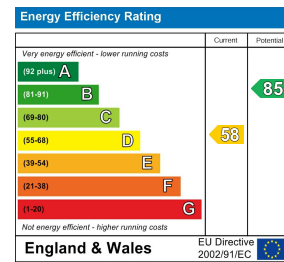

These particulars, whilst believed to be accurate are set out as a general outline only for guidance and do not constitute any part of an offer or contract. Intending purchasers should not rely on them as statements of representation of fact, but must satisfy themselves by inspection or otherwise as to their accuracy. No person in this firm's employment has the authority to make or give any representation or warranty in respect of the property.