



## 145 The Hollow

Southdown, BATH, BA2 1NJ

Price £310,000

NO ONWARD CHAIN!

A modern end of terrace house offering off-street parking, good access to local amenities and a short walk to Bath University bus route. Offering a great opportunity for first-time buyers or as a rental investment.

- End Terrace House built 1970s
- Large kitchen with dining area
- 3 bedrooms
- Easy to maintain gardens
- Close to shops and local amenities
- Good bus connections nearby

### Viewing

Please contact our Bath Stone Property Office on 01225422224 if you wish to arrange a viewing appointment for this property or require further information.





## Floor Plan

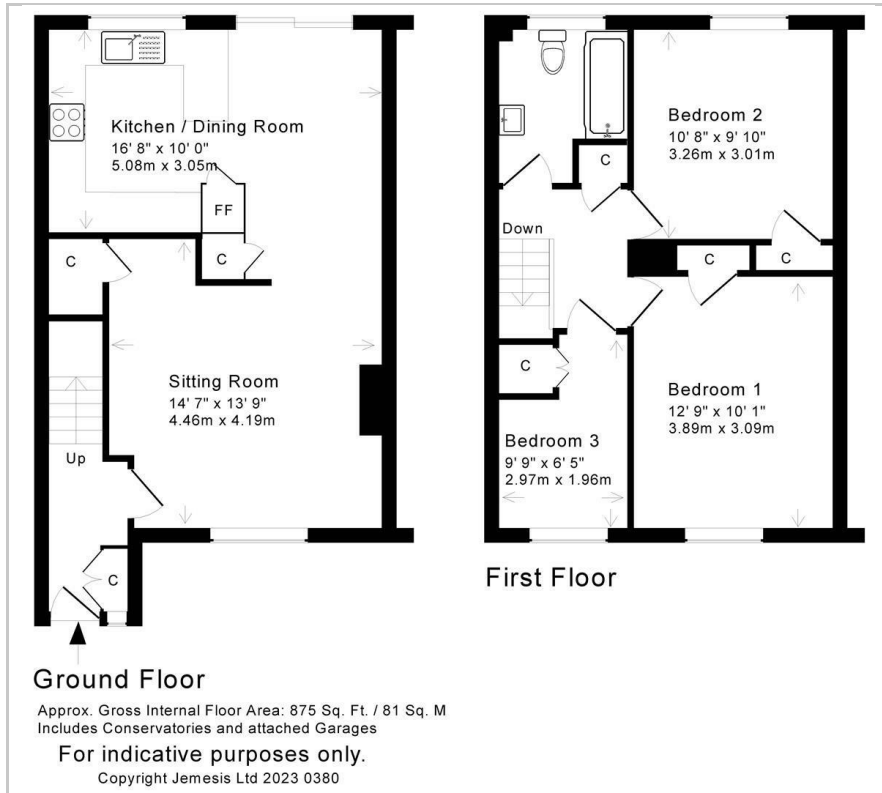

## Area Map



## Energy Efficiency Graph

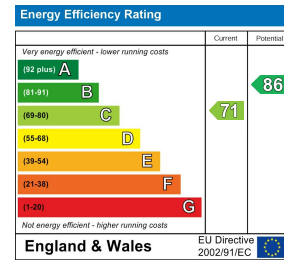

These particulars, whilst believed to be accurate are set out as a general outline only for guidance and do not constitute any part of an offer or contract. Intending purchasers should not rely on them as statements of representation of fact, but must satisfy themselves by inspection or otherwise as to their accuracy. No person in this firm's employment has the authority to make or give any representation or warranty in respect of the property.