



FOR SALE

2 Ballabrooie Park Peel Road, Douglas, Isle Of Man, Iom, IM1 5EG

£168,000

2 Patrick Street, Peel, Isle of Man, IM5 1AZ
 Tel: 01624 678876
 Email: hello@graysestateagents.com
www.graysestateagents.com





GRAY'S
 ESTATEAGENTS.COM

THE PROPERTY

A fabulous light and airy first floor apartment which benefits from modern fixtures and fittings. The apartment is situated in a sought after location being a short walk to Douglas town centre yet benefitting from a private development surrounded by mature shrubs and trees. Access into the apartment is via a communal hallway with stairs leading up to the apartments entrance. The accommodation in brief:- Entrance hall, spacious sitting room, kitchen, double bedroom and family bathroom. Outside there is a parking space and communal garden area.

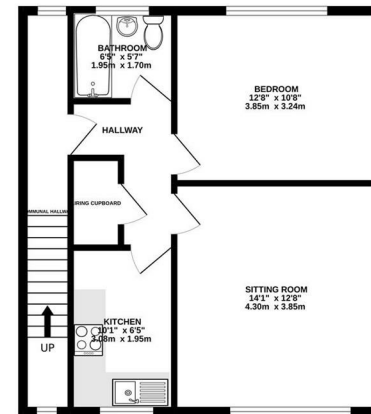
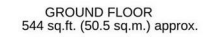

- First floor spacious apartment
- Views over looking surrounding grounds with mature shrubs and trees
- Modern kitchen with space for a full height fridge freezer
- Modern family bathroom
- Ideal for first time buyer of buy to let investor
- Sought after location within a private development
- Spacious sitting room
- Double bedroom with nice views at the rear
- Allocated parking space



TOTAL FLOOR AREA: 544 sq ft (50.5 sq m.) approx.

While every attempt has been made to ensure the accuracy of the description contained here, measurement of doors, windows, stairs and any other items are approximate and no responsibility is taken for any omission or misstatement. This plan is for descriptive purposes only and should be used as such for any prospective purchaser. The services, systems and appliances shown have not been tested and no guarantee as to their operation or efficiency can be given.

Made with Metrcan 1/10/92