



Jonathan Fitzpatrick
VILLAGE & COUNTRY HOMES

17 Monckton Drive Southwell NG25 0AW

£495,000 Freehold

Tel 01623 392676
Email mail@jfea.co.uk
Visit jfea.co.uk



A spacious 2/3 bedroom 2/3 reception room detached bungalow situated within this highly sought cul se sac location close to Southwell town centre and numerous local amenities. The property occupies a superb landscaped plot and is offered for sale in good decorative order throughout - but would benefit from some cosmetic updates. Features include a spacious entrance hallway and lounge, en suite shower room to the master bedroom, family bathroom, two further double bedrooms (one could be used as a dining room) plus single garage and generous driveway parking. No onward chain.

Southwell is a charming north Nottinghamshire market town, well known for its historical significance, picturesque surroundings, and excellent shopping facilities. The town's local events, markets, and festivals contribute to its vibrant community spirit and essential services like schools, healthcare facilities, and transportation options are all close by.





Asking price : £495,000 Freehold

Council tax band E

Flood Risk : Very Low

Gas central heating / double glazing / mains drainage

Newark Northgate railway station
(to London Kings Cross) approx. 8.5 miles

Viewing by appointment through
Jonathan Fitzpatrick Village & Country Homes
64 Main Street Farnsfield NG22 8EF

Telephone 01623 392676

Email : mail@jfea.co.uk

Web : jfea.co.uk

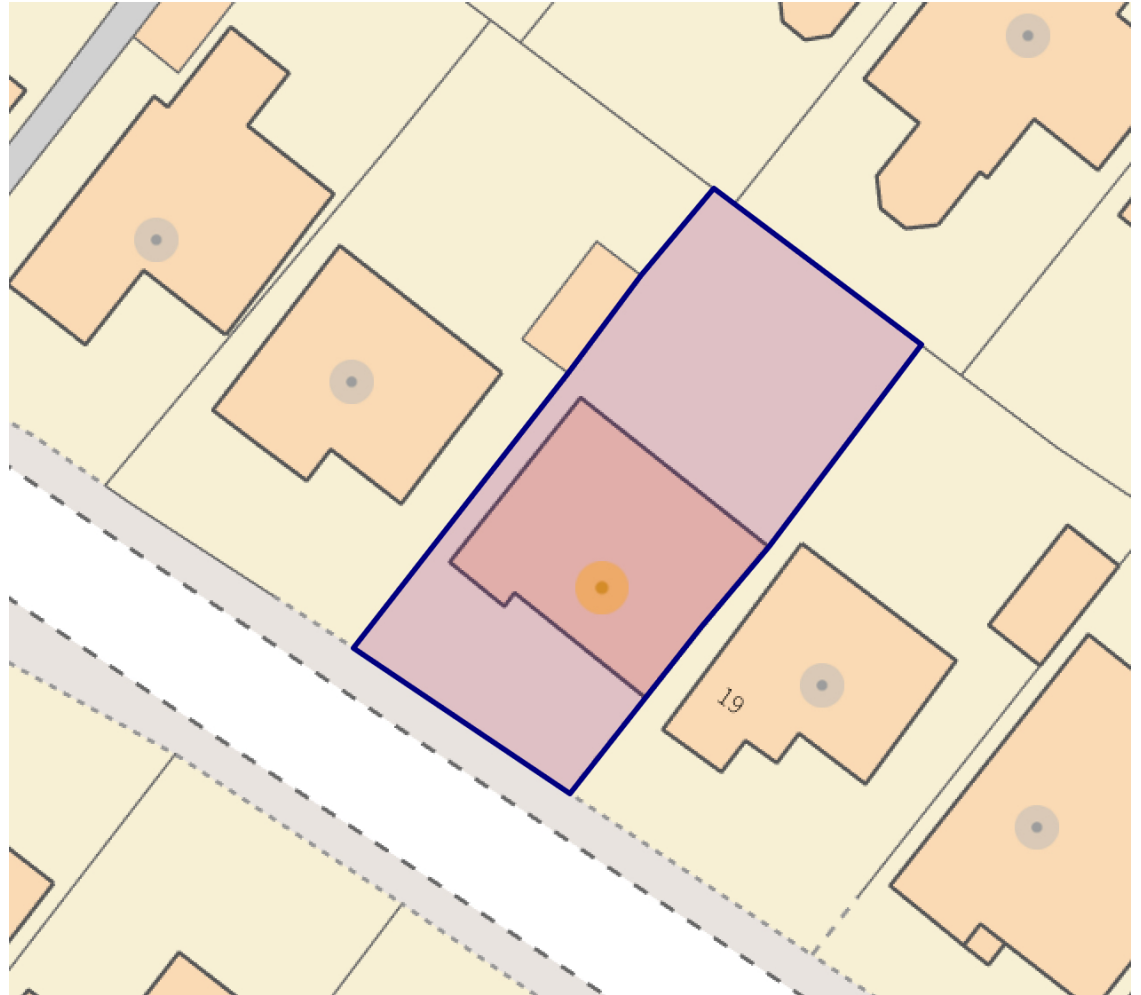

Energy performance certificate (EPC)

17 Monckton Drive
SOUTHWELL
NG25 0AW

Energy rating

D

Valid until:

11 April 2034

Certificate
number:

0360-2620-8340-2894-
4615

17 Monckton Drive, Southwell, NG25 0AW

Approximate Gross Internal Area

1356 sq ft - 126 sq m

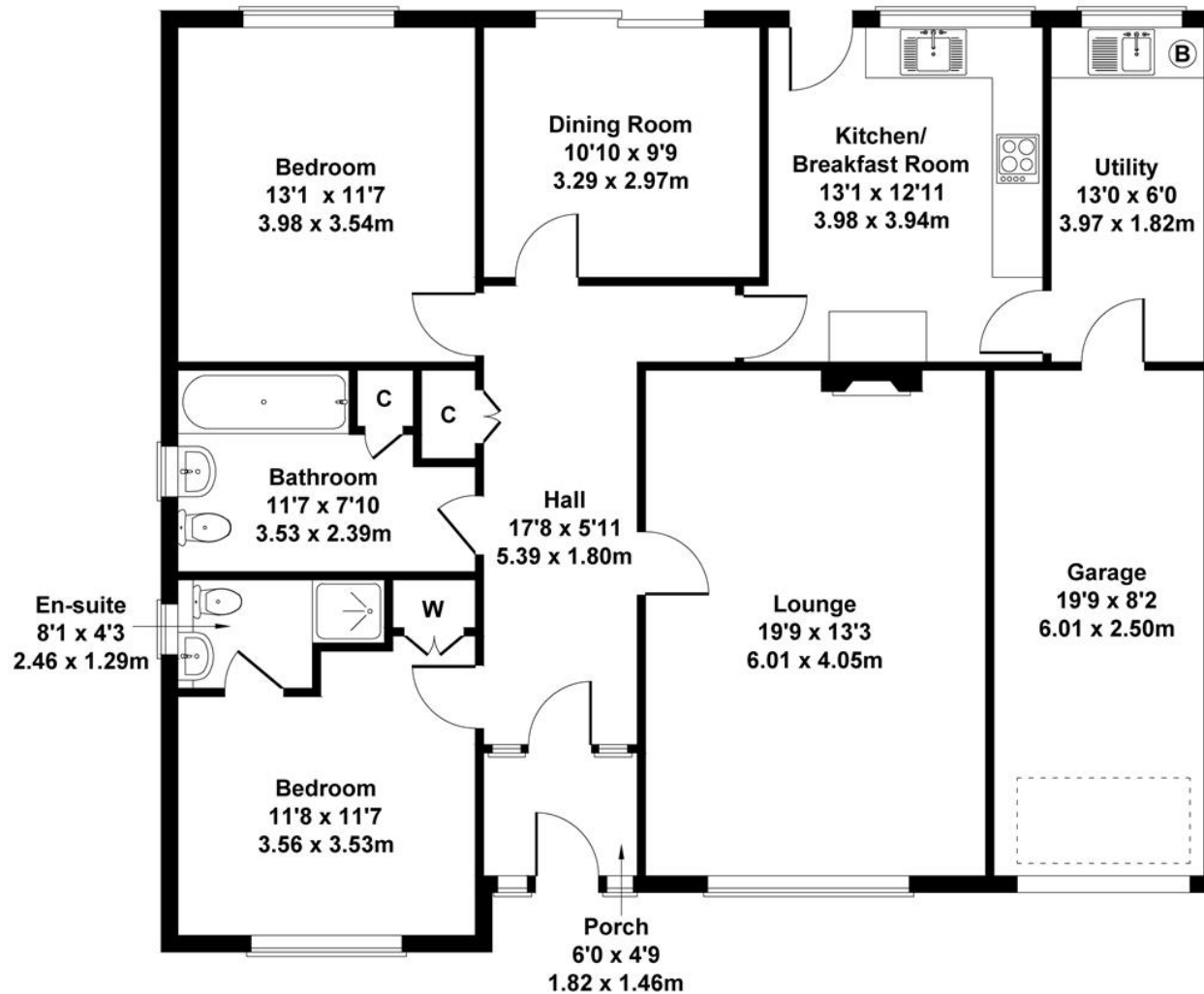

Not to Scale. Produced by The Plan Portal 2024
For Illustrative Purposes Only.