



9 Broomfield Lane Farnsfield NG22 8LQ

Offers over £209,950 Freehold

JF

Jonathan Fitzpatrick
VILLAGE & COUNTRY HOMES



A rarely available 4 bedroom terrace house situated on a popular and conveniently located road close to Farnsfield village shops, primary school, tennis club and Southwell Trail nature reserve. The property is offered for sale with immediate vacant possession and comprises entrance hall, lounge, dining room, breakfast kitchen, downstairs shower room, first floor w/c, 4 bedrooms (three with fitted wardrobes) and attached garden store/outbuilding. Outside there is an immaculately maintained private west facing rear garden and passageway access to the front of the property which has further potential for off road parking (subject to planning consent). Competitively priced to appeal to buyers in strong purchasing positions. Gas central heating, double glazing, all main services / council tax band B

Viewing by appointment. Please call our office on **01623 392676** or email mail@jfea.co.uk
Jonathan Fitzpatrick Village & Country Homes 64 Main Street Farnsfield NG22 8EF





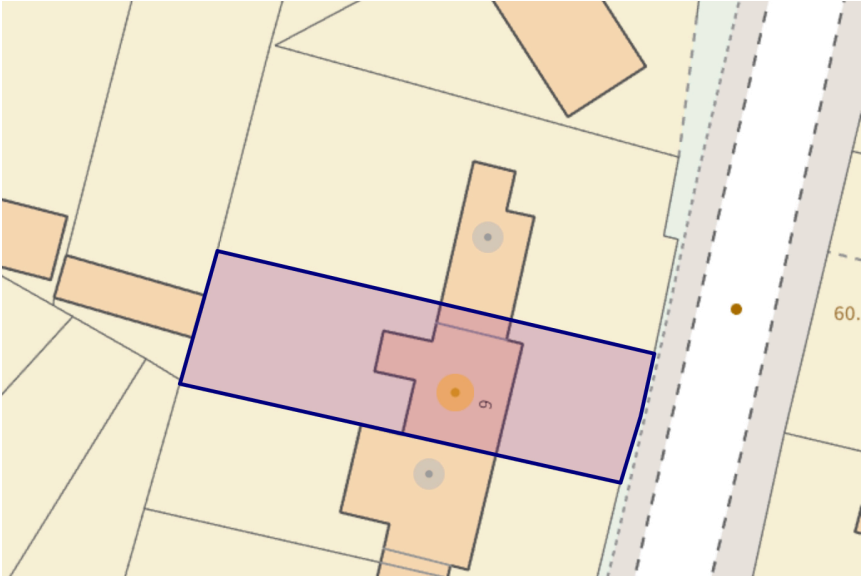

9 Broomfield Lane, Farnsfield, NG22 8LQ

Approximate Gross Internal Area
1227 sq ft - 114 sq m

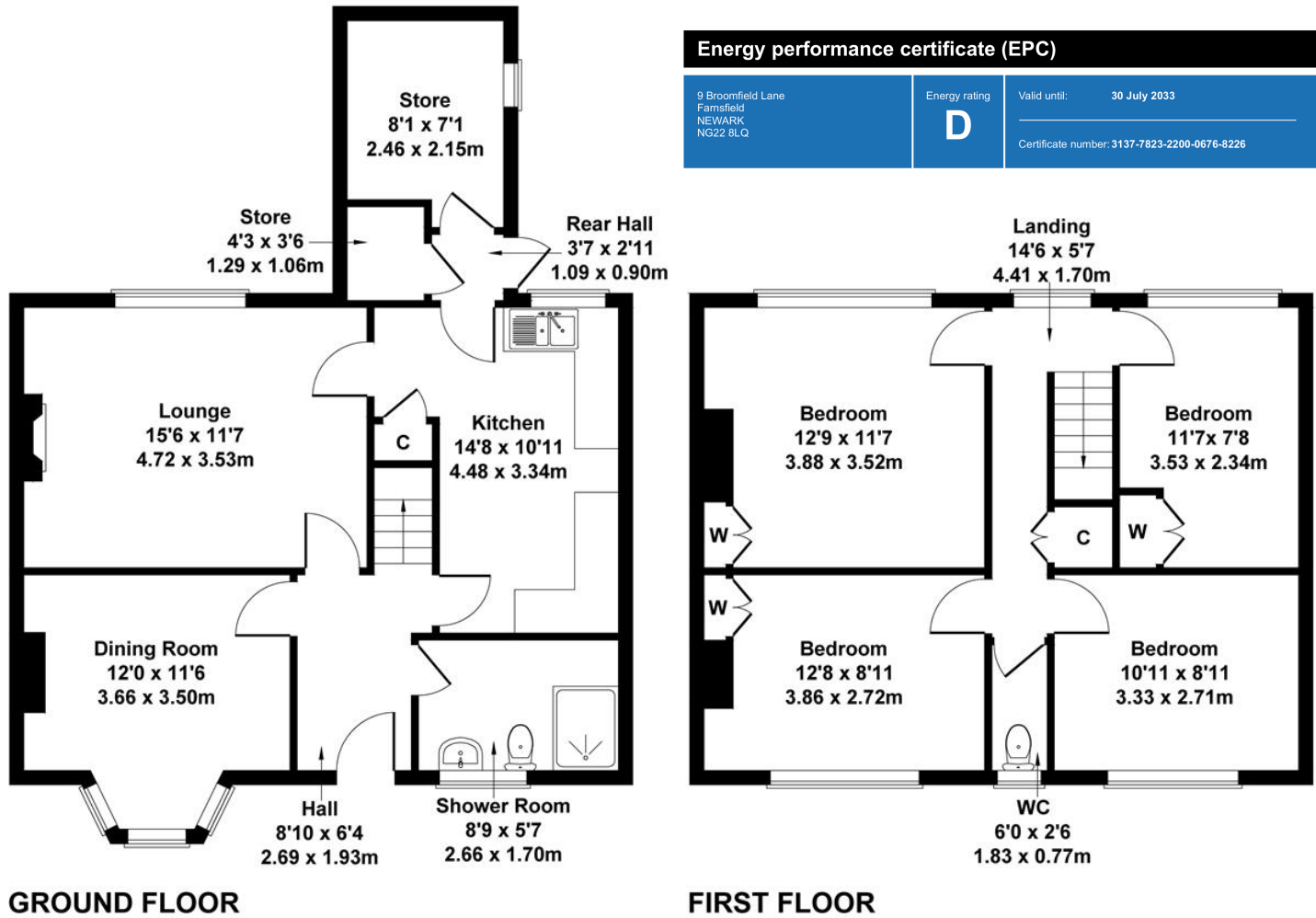

Not to Scale. Produced by The Plan Portal 2023
For Illustrative Purposes Only.