



Linsgate Southwell Road Farnsfield NG22 8EB

Guide price £350,000 - £375,000 Freehold

JF

Jonathan Fitzpatrick
VILLAGE & COUNTRY HOMES

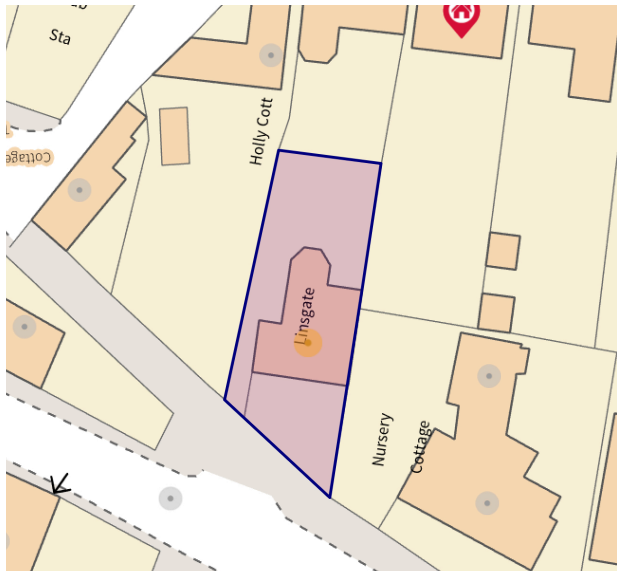

A 3 bedroom, 2 reception room detached Georgian home, offered to the market at a competitive guide price to reflect the need for updating, but represents a superb opportunity to personalise and add value. Offers should be submitted by Friday 4th August with full financial details. The successful buyer will be required to complete within 8-10 weeks. No onward chain.

Guide price £350k - £375k Freehold Council tax band E

Tel: 01623 392676 for more details and to book your viewing appointment

Jonathan Fitzpatrick Village & Country Homes
64 Main Street Farnsfield NG22 8FE
www.jfea.co.uk
mail@jfea.co.uk

Linsgate, Southwell Road, Farnsfield NG22 8EB

Approximate Gross Internal Area
1582 sq ft - 147 sq m

Energy performance certificate (EPC)

Linsgate
Southwell Road
Farnsfield
NEWARK
NG22 8EB

Energy rating
G

Valid until: 20 July 2033

Certificate number: 4800-1703-0122-0220-3373

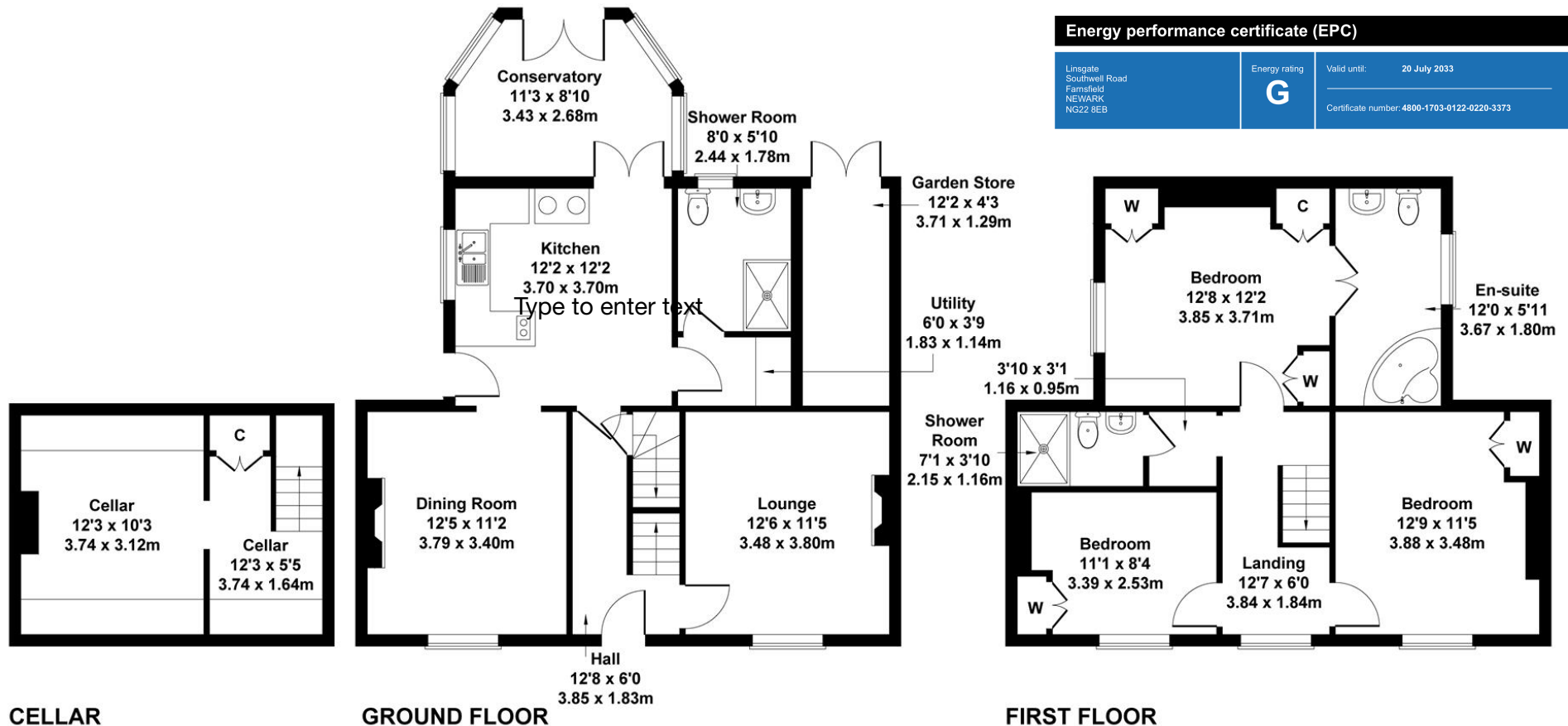

Not to Scale. Produced by The Plan Portal 2023
For Illustrative Purposes Only.

Agents Note: Whilst every care has been taken to prepare these sales particulars, they are for guidance purposes only. All measurements are approximate are for general guidance purposes only and whilst every care has been taken to ensure their accuracy, they should not be relied upon and potential buyers are advised to recheck the measurements