



JF

Jonathan|Fitzpatrick
VILLAGE & COUNTRY HOMES

3 Spring Court Farnsfield NG22 8LE

Offers over **£290,000 Freehold**

Overview

Detached bungalow
3 bedrooms
Lounge
Hallway
Kitchen breakfast room
Shower room
Single detached garage
Driveway parking
South facing rear garden

Features

No onward chain
Cul de sac location
Close to village amenities
Gas central heating
Double glazing
Competitive asking price
Potential to add value

JF Notes

'A rarely available 3 bedroom detached bungalow situated in a quiet cul de sac off Spring Lane. The property does require updating but there is plenty of potential to add value and make this a sound long term investment'.

Viewing

By appointment only. Please call our office on **01623 392676** or email mail@jfea.co.uk

Lines open 7 days a week
9.00am - 6.00pm

Jonathan Fitzpatrick Village & Country Homes 64 Main Street Farnsfield NG22 8EF







3 Spring Court, Farnsfield, Newark, NG22 8LE

Approximate Gross Internal Area

1044 sq ft - 97 sq m

Council tax band D

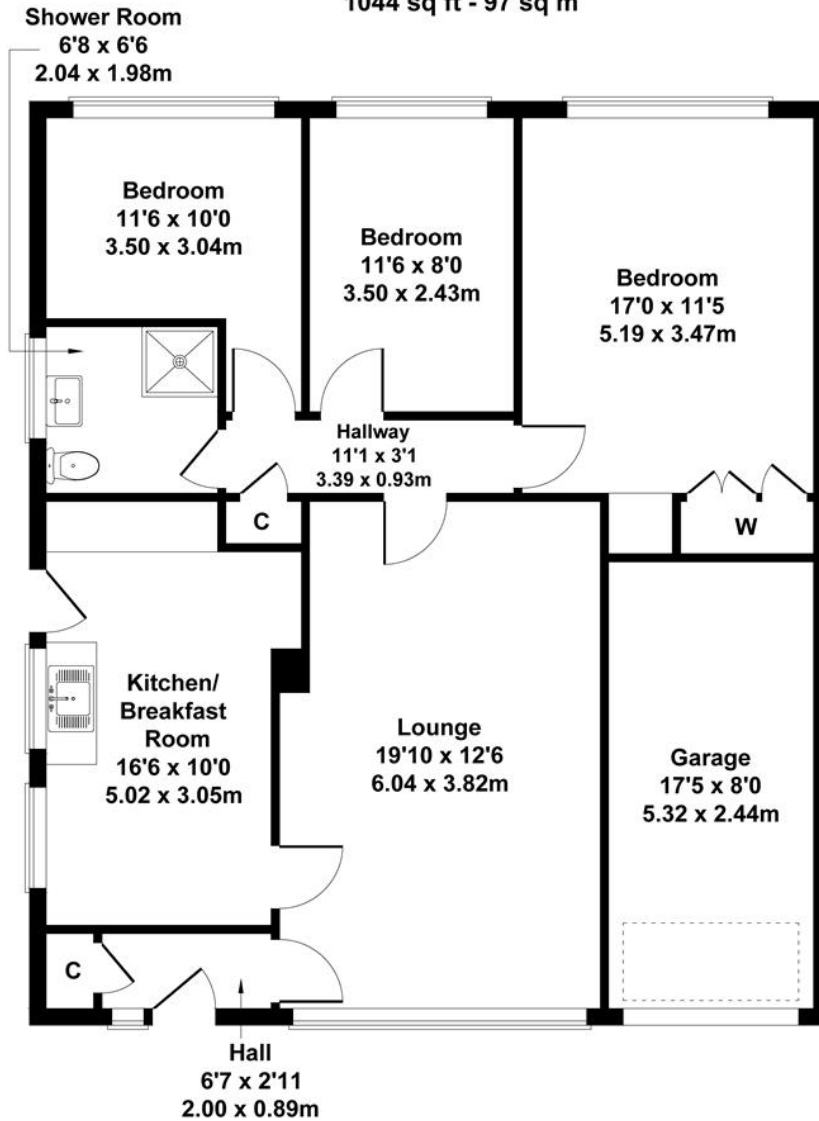

Energy performance certificate (EPC)

3 Spring Court
Farnsfield
NEWARK
NG22 8LE

Energy rating

D

Valid until: 6 June 2033

Certificate number: 0865-3027-4206-0317-4204

Property type

Detached bungalow

Not to Scale. Produced by The Plan Portal 2023
For Illustrative Purposes Only.