



**JF**

Jonathan Fitzpatrick

VILLAGE & COUNTRY HOMES

15 Gordon Close Farnsfield NG22 8EH

£279,950 Freehold



## Overview

Semi detached bungalow  
2 double bedrooms  
1 reception room  
Conservatory  
Kitchen diner  
Patio rear garden  
Shower room  
Single detached garage  
Driveway for 2 cars  
Cul de sac location

## Features

Re-fitted kitchen diner  
Modern shower room  
West facing rear garden  
Driveway parking  
Short walk to shops, pubs,  
and village amenities  
Double glazing  
Gas central heating  
Good decorative order  
No onward chain

## JF Notes

'A deceptively spacious 1960s bungalow offered for sale in excellent decorative order throughout and with a modern kitchen, shower room and conservatory. Convenient location with easy access to village shops and countryside walks. Viewing strongly advised'.

## Viewing

By appointment only. Please call our office on 01623 392676 or email [mail@jfea.co.uk](mailto:mail@jfea.co.uk)

Lines open 7 days a week  
9.00am - 6.00pm

Jonathan Fitzpatrick Village & Country  
Homes 64 Main Street  
Farnsfield NG22 8EF









# 15 Gordon Close, Farnsfield, Newark, NG22 8EH

Approximate Gross Internal Area  
904 sq ft - 84 sq m  
(Including Garage)

## Energy performance certificate (EPC)

16 Gordon Close  
Farnsfield  
NEWARK  
NG22 8EH

Energy rating  
**D**

Valid until: 22 August 2031  
Certificate number: 0140-2047-5080-2129-6375

Council tax band C

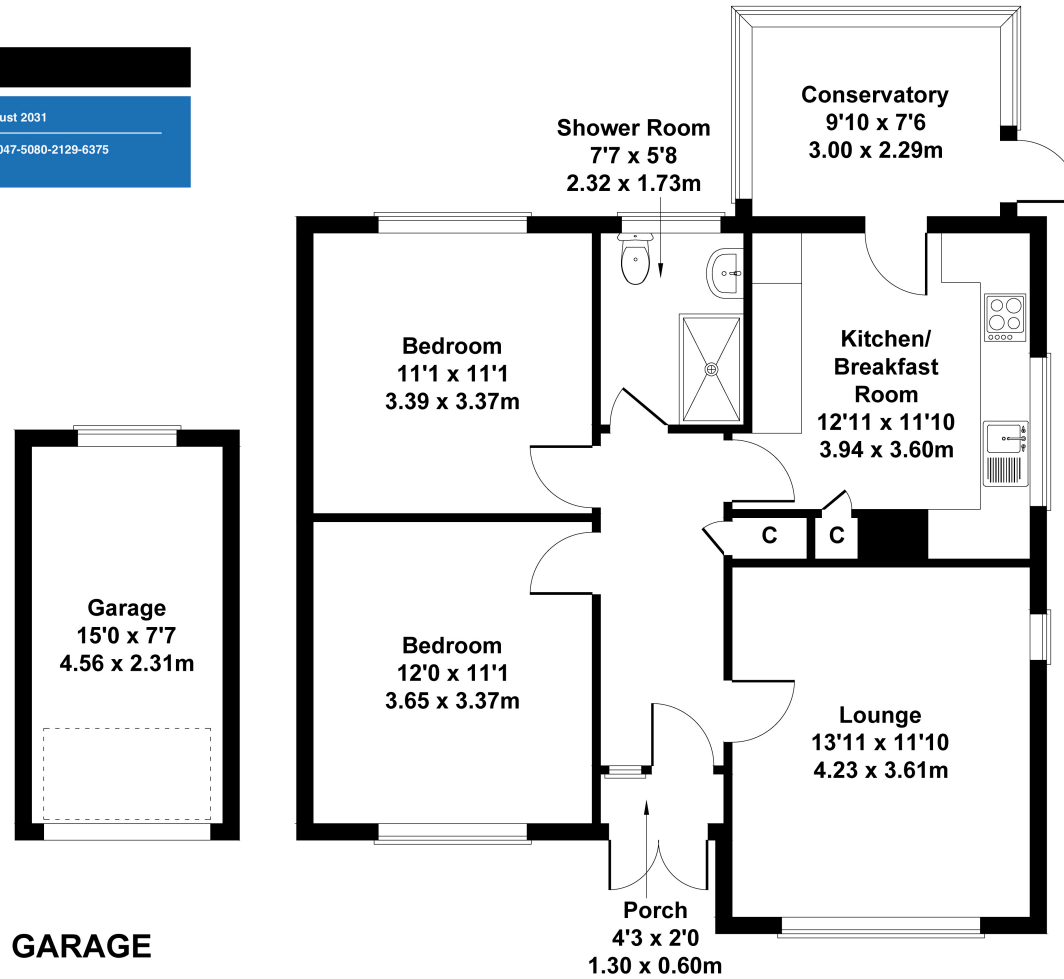

Not to Scale. Produced by The Plan Portal 2023  
For Illustrative Purposes Only.