



Jonathan Fitzpatrick
VILLAGE & COUNTRY HOMES

Tel 01623 392676
Email mail@jfea.co.uk
Visit jfea.co.uk

64 Main Street Farnsfield NG22 8EF

Thinking of moving? **Think JF.**



65 Fiskerton Road Southwell NG25 0TH

A charming 3 bedroom, three storey mid terrace period cottage situated in popular and conveniently situated location, within a few minutes walk from the town centre and numerous local amenities.

The property is offered for sale in very good order throughout and benefits from a top floor loft conversion, which provides a useful third bedroom or study/office. Other features include beamed lounge dining room with fireplace, modern fitted kitchen, plus re-fitted bathroom with shower bath. Outside, there is an attractive rear garden with patio, allocated parking for one car, plus guest parking.

The historic market town of Southwell with its famous Minster and variety of independent shops, pubs and eateries is within convenient walking distance away. Early viewing strongly advised. NO ONWARD CHAIN.

All main services /gas central heating /double glazing /Council Tax Band B

Guide £225,000 - £229,950 Freehold

Viewing strictly by appointment through Jonathan Fitzpatrick Village & Country Homes.

Tel: **01623 392676** / email mail@jfea.co.uk







65 Fiskerton Road NG25 0TH

Approximate Gross Internal Area
786 sq ft -73 sq m

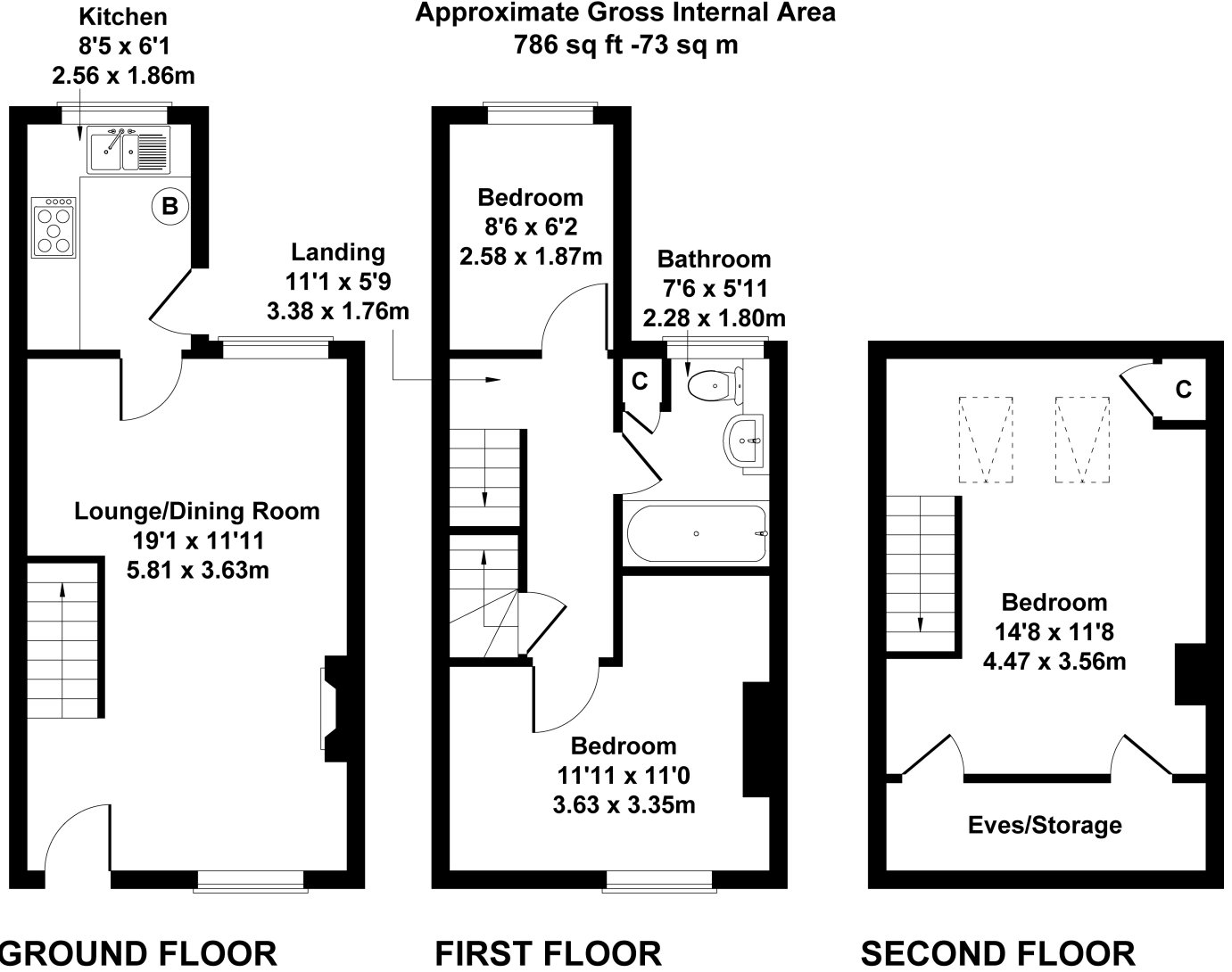

Not to Scale. Produced by The Plan Portal 2023
For Illustrative Purposes Only.

Energy performance certificate (EPC)

65 Fiskerton Road
SOUTHWELL
NG25 0TH

Energy rating

D

Valid until: 27 April 2033

Certificate number: 6437-5324-7200-0336-6222