



Flat 7 Chapel Apartments
Bank Street, Coleford, GL16 8BA
£79,950



VIRTUAL TOUR AVAILABLE Dean Estate Agents are delighted to present this lovely one bedroom flat situated in Coleford town centre. This property offers a spacious entrance hallway, a large bathroom, kitchen, lounge and a double bedroom.

Area Map

With Coleford town centre being on your doorstep, this allows you to be within walking distance to many cafes, free houses, doctors surgeries, supermarkets and many more! There are great bus links taking you all over the Forest of Dean and over to Gloucester and into Wales. There is truly something for every one in this town.



Approached via wooden door into:

Entrance Hallway:

5'9" x 12'9" (1.75m x 3.89m)

Electric switchboard, intercom phone Wi-Fi point, electric storage heater, airing cupboard which houses an immersion heater.

Lounge:

15'1" x 10'2" (4.60m x 3.10m)

TV point, BT point, built in speakers, electric storage heater, power and lighting.

Kitchen:

14'2" x 7'5" (4.32m x 2.26m)

Fitted kitchen comprising of base units with drawers, wall units, undercounter space for a small fridge and/or freezer, space and plumbing for dishwasher, space and plumbing for washing machine, built in electric oven and integrated electric hob, extractor fan and electric storage heater, power and lighting.



Bathroom:

11'10" x 6'3" (3.61m x 1.91m)

Electric shower, W.C., large corner bath, wash hand basin, extractor fan, single electric storage heater.

Bedroom:

12'0" x 8'8" (3.66m x 2.64m)

Electric storage heater, power and lighting.

Outside:

There is a parking area around the rear of the property.

Floor Plan

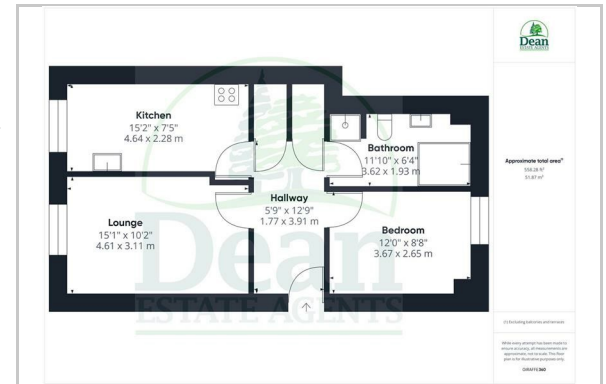

Energy Efficiency Graph

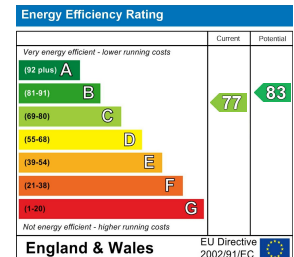

Consumer Notes: Dean Estate Agents Ltd have prepared the information within this website/brochure with care and co-operation from the seller. It is intended to be indicative rather than definitive, without a guarantee of accuracy. Before you act upon any information provided, we request that you satisfy yourself about the completeness, accuracy, reliability, suitability or availability with respect to the website or the information, products, services, or related graphics contained on the website for any purpose.

These details do not constitute any part of any Offer, Contract or Tenancy Agreement.

Photographs used for advertising purposes may not necessarily be the most recent photographs, although every effort is made to update photographs at the earliest opportunity. Any reliance you place on such information is therefore strictly at your own risk. All photographic images are under the ownership of Dean Estate Agents Ltd and therefore Dean Estate Agents retain the copyright. You must obtain permission from the owner of the images to reproduce them.

Tenanted Properties – we are not always able to show the most recent condition of a property due to tenants' privacy and we may choose to show the photographs of the property when it was last vacant to at least allow clients some idea of the internal condition. Therefore, we would of course, urge you to view before making any decisions to purchase or rent the property and before any costs.

Energy Performance Certificates are supplied to us via a third party and we do not accept responsibility for the content within such reports.

PRC Certificates – Some ex-local authority properties have been repaired in recent years using the PRC Scheme wherein a certificate has been produced by a qualified property engineer. This certificate does not imply the suitability for a mortgage approval and you must satisfy yourself of the work carried out that may meet your lenders criteria.

As with leasehold property or new build development sites, you are likely to be responsible for a contribution to management charges and/or ground rent or a contribution to the development service charge. Please enquire at the time of viewing.

You may also incur fees for items such as leasehold packs and, in addition, you will also need to check the remaining length of any lease before you complete a mortgage application form.

Please ask a member of our team for any help required before committing to purchase a property and incurring expense.