



Flat 4, Hereford Road  
Monmouth, NP25 3HB  
£125,000

🛏 1 🚿 1 🛋 1 ☰ C

\*\*\*VIRTUAL TOUR AVAILABLE\*\*\* Dean Estate Agents are pleased to present this one bedroom ground floor apartment in a sought after area in the bustling town of Monmouth. The property comprises of lounge, modern kitchen, shower room, rear utility room for storage and has telephone communication to access the building. The property sits on lovely gardens and has beautiful countryside views. NO ONWARD CHAIN! CALL TO BOOK A VIEWING! WE HAVE KEYS!

## Area Map



## Floor Plan

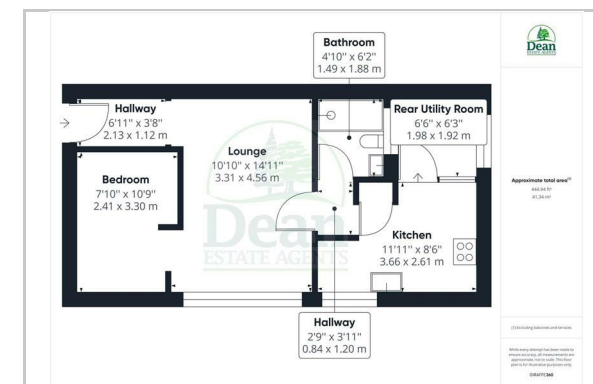

Access via communal entrance into:

**Entrance Hallway:** Front door, telephone communication for communal door.

**Lounge:** Double panelled radiator, UPVC double glazed window to front, smoke alarm, lighting, tv point.

**Kitchen:** A modern range of base, wall and drawer units, Lamona oven, Lamona 4 ring electric hob, extractor hood, integrated fridge freezer, cupboard housing ideal combi boiler, stainless steel 1 and a half bowl sink with drainer unit,

UPVC double glazed window to front, UPVC double glazed door to rear utility room, double panelled radiator, vinyl flooring, storage cupboard, lighting.

**Rear Utility Room:** UPVC double glazed window to side.

**Bedroom:** Single panelled radiator, mains consumer unit, fitted cupboards.

**Shower Room:** Tiled flooring, single panelled radiator, electric shower, UPVC double glazed window, vanity sink unit, W.C., lighting.



## Energy Efficiency Graph

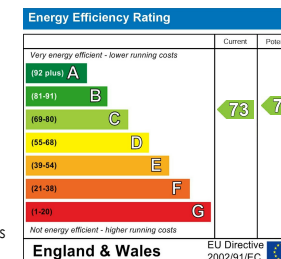

Consumer Notes: Dean Estate Agents Ltd have prepared the information within this website/brochure with care and co-operation from the seller. It is intended to be indicative rather than definitive, without a guarantee of accuracy. Before you act upon any information provided, we request that you satisfy yourself about the completeness, accuracy, reliability, suitability or availability with respect to the website or the information, products, services, or related graphics contained on the website for any purpose.

These details do not constitute any part of any Offer, Contract or Tenancy Agreement.

Photographs used for advertising purposes may not necessarily be the most recent photographs, although every effort is made to update photographs at the earliest opportunity. Any reliance you place on such information is therefore strictly at your own risk. All photographic images are under the ownership of Dean Estate Agents Ltd and therefore Dean Estate Agents retain the copyright. You must obtain permission from the owner of the images to reproduce them.

Tenanted Property - we are not always able to show the most recent condition of a property due to tenants' privacy and we may choose to show the photographs of the property when it was last vacant to at least allow clients some idea of the internal condition. Therefore, we would of course, urge you to view before making any decisions to purchase or rent the property and before any costs.

Energy Performance Certificates are supplied to us via a third party and we do not accept responsibility for the content within such reports.

PRC Certificates - Some ex-local authority properties have been repaired in recent years using the PRC Scheme wherein a certificate has been produced by a qualified property engineer. This certificate does not imply the suitability for a mortgage approval and you must satisfy yourself of the work carried out that may meet your lenders criteria.

As with leasehold property or new build development sites, you are likely to be responsible for a contribution to management charges and/or ground rent or a contribution to the development service charge. Please enquire at the