

# HJC

HIGHER VALUES



## Maple Road

Surbiton, KT6 4AA

Guide Price £595,000

A beautiful two double bedroom Victorian cottage. Located on the sought after Maple Road, near all local amenities and the river. Includes a modern eat-in kitchen with stone surfaces, integral appliances and under floor heating plus a utility area. A separate sitting room with a feature fire. A ground floor white bathroom with a shower over and under floor heating. On the first floor a large master bedroom with a period fire place and double second bedroom also with a fire place. Council Tax Band C.

- Victorian cottage
- 2 reception rooms
- Pretty courtyard garden
- Utility area
- Close to Surbiton Station
- 2 double bedrooms
- Feature wood burner
- Downstairs bathroom
- Sought after location
- Close to the River Thames

# Floor Plan

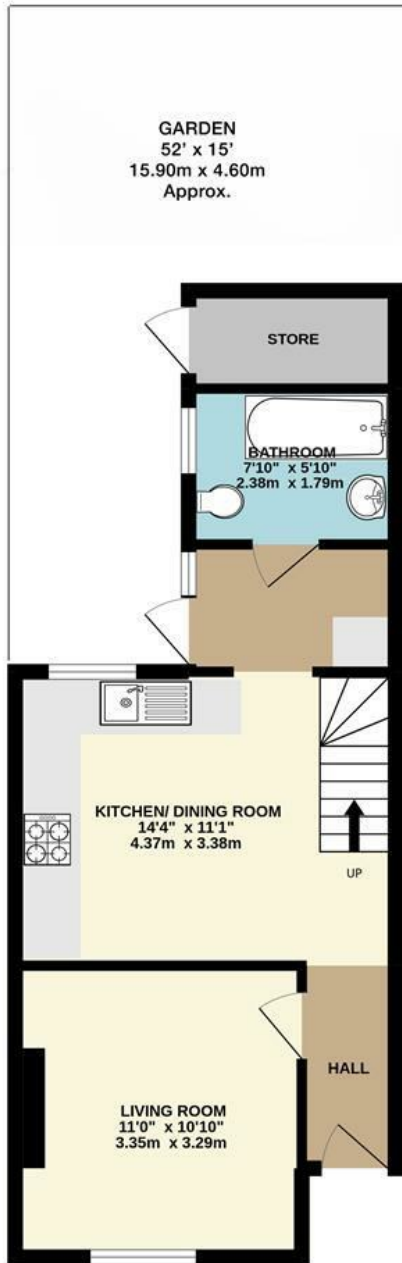

GROUND FLOOR

## MAPLE ROAD, SURBITON INTERNAL FLOOR AREA (APPROX.) 720 sq ft/ 66.9 sq m

Whilst every attempt has been made to ensure the accuracy of this floor plan, measurement of doors, windows, rooms and any other items are approximate and no responsibility is taken for any error, omission or mis-statement.  
Made with Metropix © 2022.

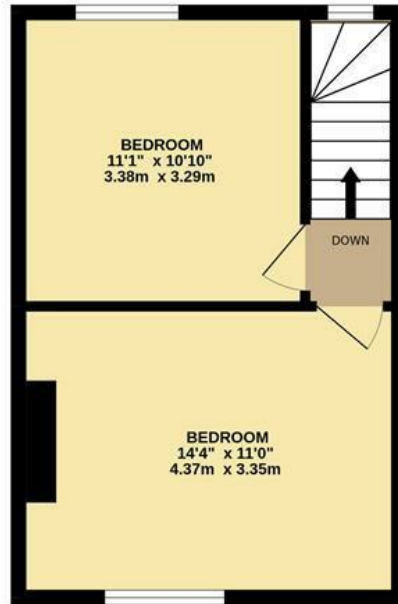

FIRST FLOOR

## Energy Efficiency Graph

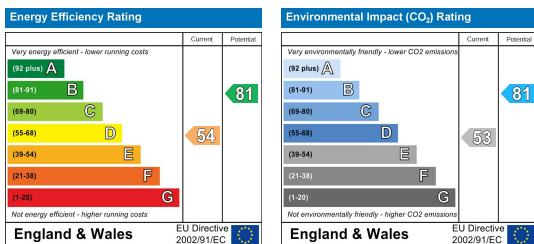

These particulars, whilst believed to be accurate are set out as a general outline only for guidance and do not constitute any part of an offer or contract. Intending purchasers should not rely on them as statements of representation of fact, but must satisfy themselves by inspection or otherwise as to their accuracy. No person in this firm's employment has the authority to make or give any representation or warranty in respect of the property.