

# HJC

HIGHER VALUES



## Portsmouth Road

Surbiton, KT6 4HW

Guide Price £425,000

We are pleased to present this, 3 double bedroom ground floor flat. The flat, ideally located opposite the River Thames, is set to the back of this 1930's art deco influenced character building. It comprises; kitchen with plenty of storage and dishwasher, 3 double bedrooms, bright dual aspect living room and bathroom with separate WC. There is also parking, which works on a first come, first served and bike storage. Council Tax band D. Remaining lease 108 years.

- Prime River Road Location
- Family Bathroom with Separate WC
- Reception Room with dual aspects
- Walking Distance to town, station
- 3 Double bedrooms
- Kitchen with plenty of storage
- Parking first come first served
- Chain Free

# Floor Plan

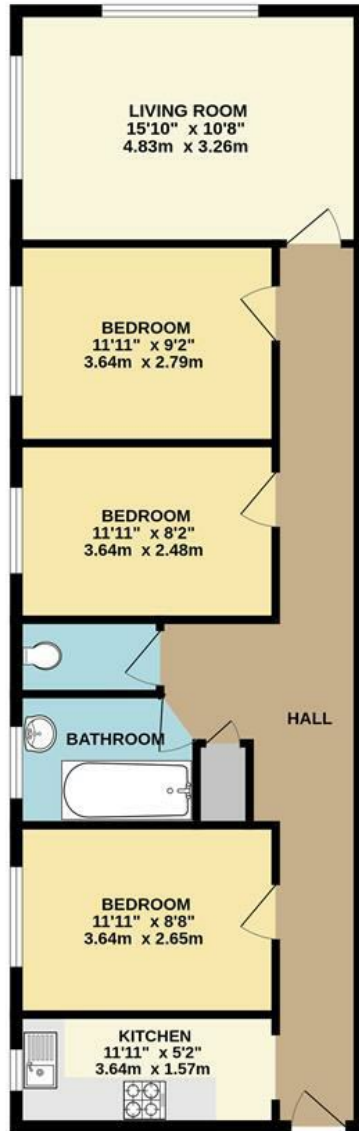

INTERNAL FLOOR AREA (APPROX.) 871.9 sq ft/ 81.0 sq m

Whilst every attempt has been made to ensure the accuracy of this floor plan, measurement of doors, windows, rooms and any other items are approximate and no responsibility is taken for any error, omission or mis-statement. Made with Metropix © 2023.

## Energy Efficiency Graph

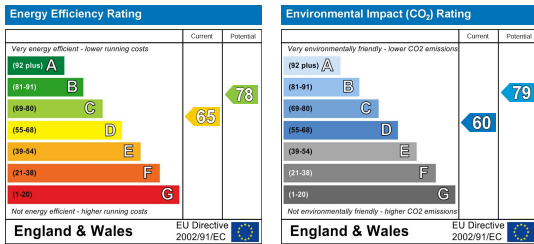

These particulars, whilst believed to be accurate are set out as a general outline only for guidance and do not constitute any part of an offer or contract. Intending purchasers should not rely on them as statements of representation of fact, but must satisfy themselves by inspection or otherwise as to their accuracy. No person in this firm's employment has the authority to make or give any representation or warranty in respect of the property.