

HJC

HIGHER VALUES



Balaclava Road

Surbiton, KT6 5RY

Guide Price £550,000

A purpose built ground floor apartment forming part of the prestigious and much sought after St James Park development. The flat comprises a generous living room, a well equipped kitchen, two double bedrooms, two bathrooms (one ensuite) with white suites, there is a secure under ground parking space and communal gardens. The property is located within 1/2 of a mile of Surbiton town centre and mainline station. Kingston borough Council Tax Band D. Lease 101 years remaining. Service Charges/ ground rent appx £2,475.20 pa. Chain Free.

- Purpose Built St James Development
- Ensuite to Main Bedroom
- Visual Entry Door System
- Communal Gardens
- Close to Surbiton Town Centre
- 2 Double Bedrooms
- Large Reception/Dining Room
- Allocated Underground Parking
- Close to Surbiton Station
- Ground Floor

Floor Plan

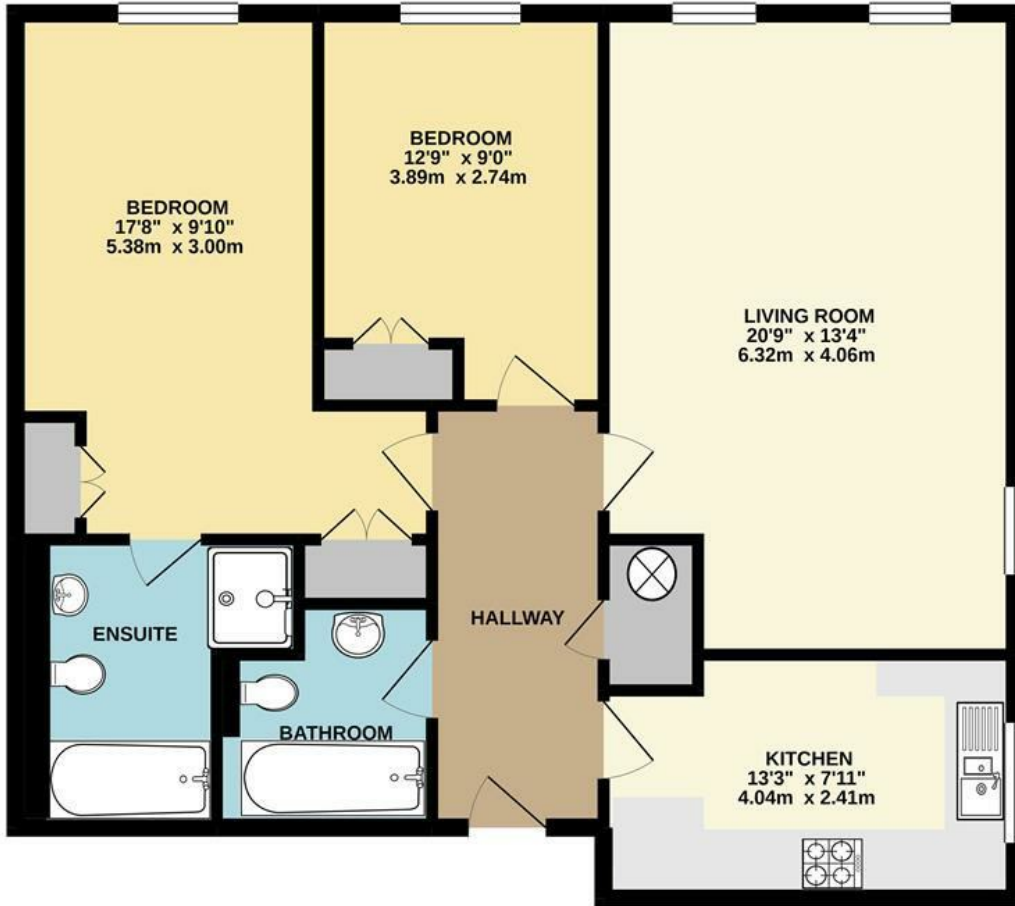

GROUND FLOOR FLAT

BALACLAVA ROAD, SURBITON
 INTERNAL FLOOR AREA (APPROX.) 915 sq ft/ 85.0 sq m

Whilst every attempt has been made to ensure the accuracy of this floor plan, measurement of doors, windows, rooms and any other items are approximate and no responsibility is taken for any error, omission or mis-statement. Made with Metropix © 2023.

Energy Efficiency Graph

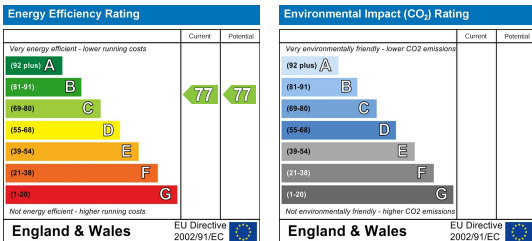

These particulars, whilst believed to be accurate are set out as a general outline only for guidance and do not constitute any part of an offer or contract. Intending purchasers should not rely on them as statements of representation of fact, but must satisfy themselves by inspection or otherwise as to their accuracy. No person in this firm's employment has the authority to make or give any representation or warranty in respect of the property.