

HJC

HIGHER VALUES



Douglas Road

Surbiton, KT6 7SA

£875,000

Lovely family home located in a desirable part of Surbiton, within close proximity to a sought after School. This 4 Bedroom Semi-Detached home features to the ground floor, Study, Downstairs WC, Kitchen, Utility, Large Open Plan Family/Dining Room with bi-fold doors opening onto the garden. In the garden there is a large Studio and storage Shed with electricity. To the First Floor is the Principal Bedroom with En-Suite, Two further Double Bedrooms, Family Bathroom. The second floor features a further Double Bedroom with En-suite. Offering off street parking for one car.

- 4 Bedroom Semi-Detached
- Downstairs WC
- Modern Kitchen
- Large Garden Studio and Shed
- Off Street Parking
- Study
- Utility
- Open Plan Living Dining
- 2 En-Suites and Family Bathroom
- Local to Sought After Schools

Floor Plan

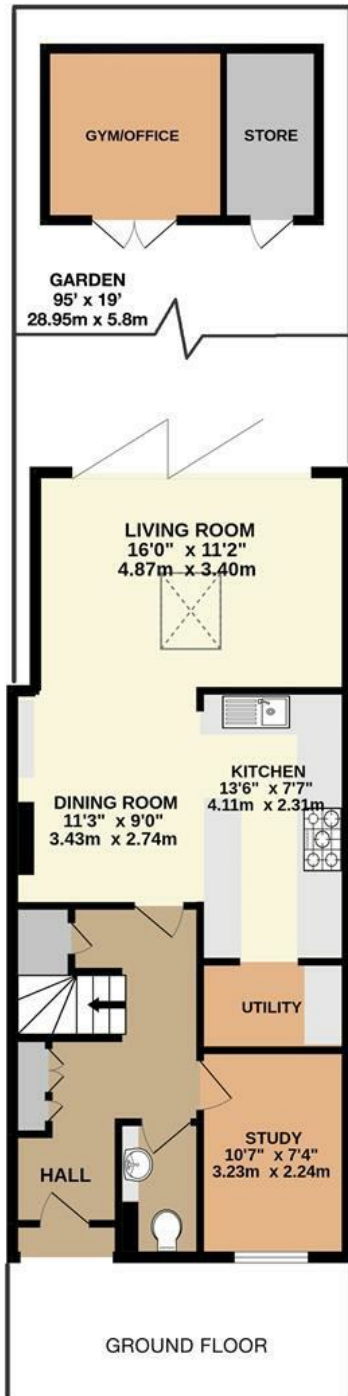

DOUGLAS ROAD, SURBITON
INTERNAL FLOOR AREA (APPROX.) 1365 sq ft/ 126.8 sq m
Excluding exterior office/gym

Whilst every attempt has been made to ensure the accuracy of this floor plan, measurement of doors, windows, rooms and any other items are approximate and no responsibility is taken for any error, omission or mis-statement. Made with Metropix © 2021.

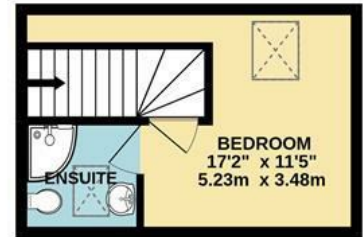
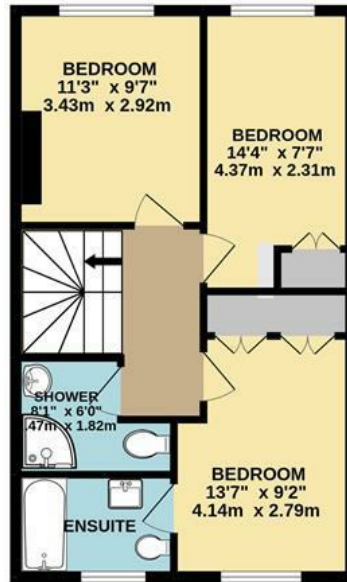

Energy Efficiency Graph

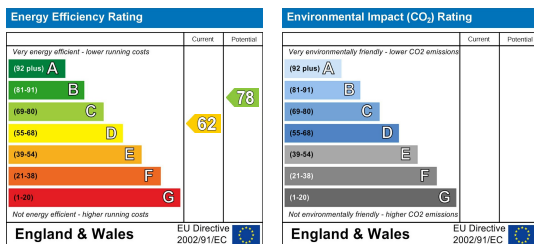

These particulars, whilst believed to be accurate are set out as a general outline only for guidance and do not constitute any part of an offer or contract. Intending purchasers should not rely on them as statements of representation of fact, but must satisfy themselves by inspection or otherwise as to their accuracy. No person in this firm's employment has the authority to make or give any representation or warranty in respect of the property.