

HJC

HIGHER VALUES



Vallings Place

Surbiton, KT6 5AZ

Guide Price £650,000

This light and airy property is offered in superb condition in the much sought after gated Vallings Place development. The ground floor accommodation comprises a modern kitchen, downstairs wc and a very generous living room with French doors leading on to a pretty rear garden. The first floor accommodation includes two double bedrooms and a family bathroom. This home is located just moments from the River Thames, Long Ditton Recreation Ground and within a close proximity to Surbiton's town centre which offers a great selection of amenities including mainline station with links into Waterloo, shops, bars.

- Private gated development
- 2 Double bedrooms
- Gas central heating
- Allocated parking space
- Close to River Thames
- Modern kitchen
- Living room with french doors to garden
- Double glazing
- Close to Surbiton Station
- Built in 2012 by St James

Floor Plan



GROUND FLOOR



VALLINGS PLACE, SURBITON
INTERNAL FLOOR AREA (APPROX.)
808 sq ft/ 75.0 sq m

Whilst every attempt has been made to ensure the accuracy of this floor plan, measurement of doors, windows, rooms and any other items are approximate and no responsibility is taken for any error, omission or mis-statement. Made with Metropix © 2021.

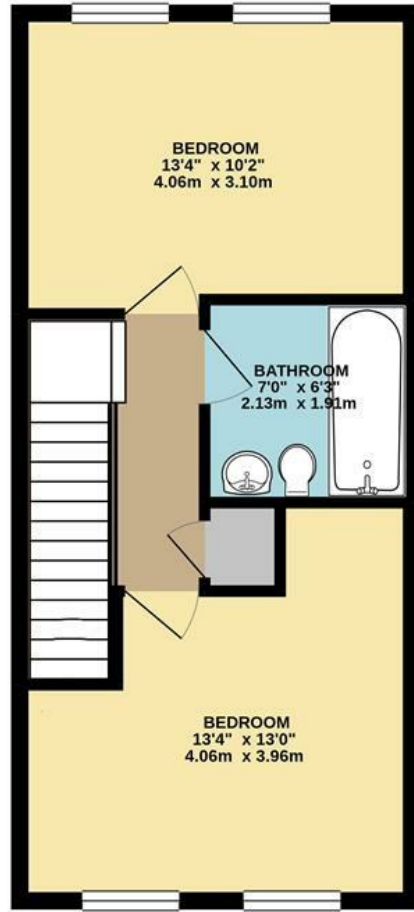

FIRST FLOOR

Energy Efficiency Graph

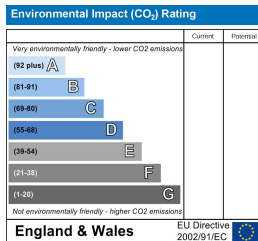
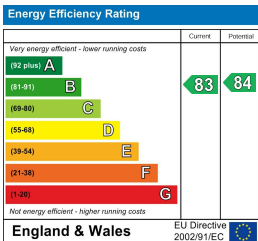

These particulars, whilst believed to be accurate are set out as a general outline only for guidance and do not constitute any part of an offer or contract. Intending purchasers should not rely on them as statements of representation of fact, but must satisfy themselves by inspection or otherwise as to their accuracy. No person in this firm's employment has the authority to make or give any representation or warranty in respect of the property.