

HJC

HIGHER VALUES



Arlington Road

Surbiton, KT6 6BN

Price Guide £875,000

Stunning extended Victorian 4 bedroom semi-detached family home located on a quiet cul-de-sac in the heart of Surbiton. This attractive family home is within close proximity to Surbiton town centre and mainline station. In excellent condition throughout this bright and airy home enjoys high ceilings, character features, attractive bay window, stripped wood floors and a pretty family garden. This friendly road has a real sense of community and is popular with commuters and families alike. It is well placed for Lime Tree and Maple Road schools, the river and green spaces at Bushy Park and Richmond Park.

- Extended Halls-Adjoining Victorian Semi
- 4 Double bedrooms
- Upstairs bathroom
- Period features
- Extended kitchen/ dining room
- Double reception room
- Upstairs shower room
- Excellent local schools

Floor Plan

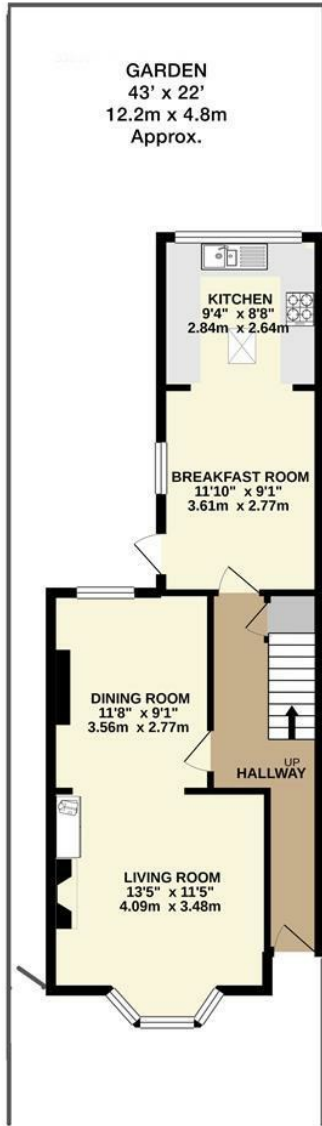

GROUND FLOOR



ARLINGTON ROAD, SURBITON
INTERNAL FLOOR AREA (APPROX.)
1355 sq ft/ 125.9 sq m

Whilst every attempt has been made to ensure the accuracy of this floor plan, measurement of doors, windows, rooms and any other items are approximate and no responsibility is taken for any error, omission or mis-statement. Made with Metropix © 2020.

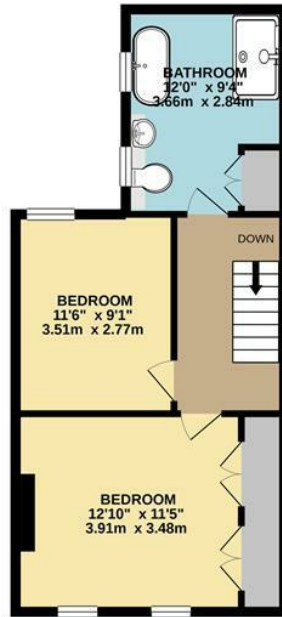

FIRST FLOOR



SECOND FLOOR

Energy Efficiency Graph

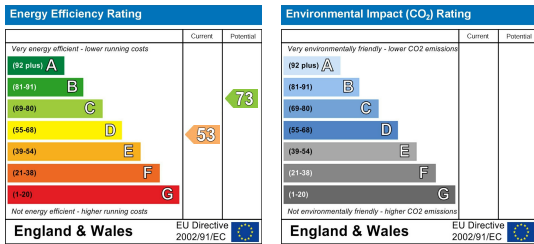

These particulars, whilst believed to be accurate are set out as a general outline only for guidance and do not constitute any part of an offer or contract. Intending purchasers should not rely on them as statements of representation of fact, but must satisfy themselves by inspection or otherwise as to their accuracy. No person in this firm's employment has the authority to make or give any representation or warranty in respect of the property.