

HJC

HIGHER VALUES



Endsleigh Gardens

Surbiton, KT6 5JL

£375,000

Beautifully Presented One Bedroom First Floor Period Conversion flat, located in a lovely tree lined street. Featuring a very spacious living/dining area with feature fireplace and sash windows. A separate Kitchen, and modern Bathroom. The spacious bedroom incorporates fitted wardrobes. This flat comes with Share of Freehold and is very conveniently located within walking distance to all local amenities and Surbiton Station, River Thames and various Parks.

- Beautiful Period First Floor Conversion Flat
- Modern Bathroom
- Separate Kitchen
- Feature Fireplace
- Large Living/Dining Space
- Sash Windows
- Share of Freehold
- Off Street Parking
- Walking Distance to Town and Station
- Walking Distance to River and Parks

Floor Plan

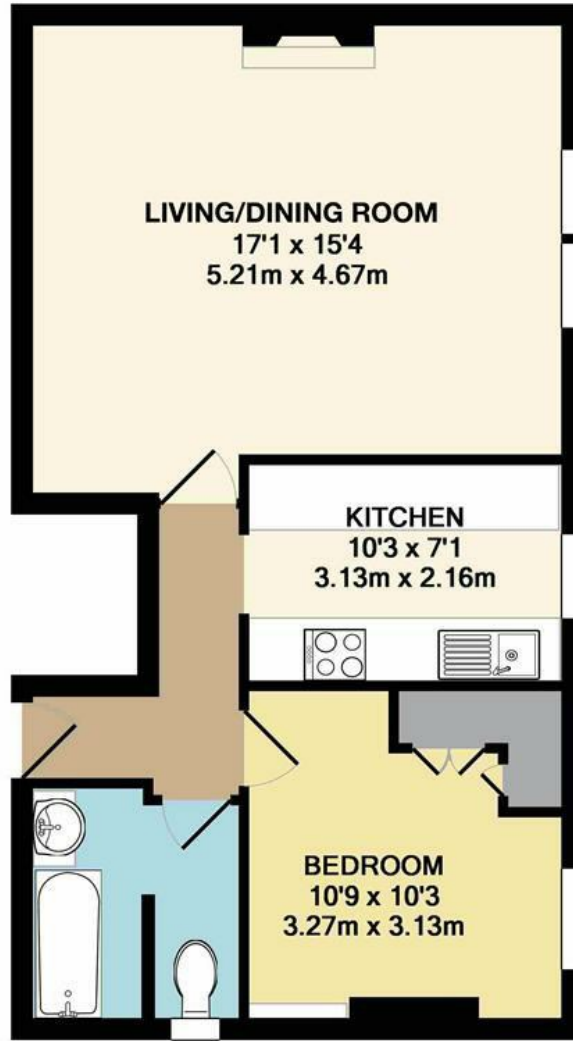

FIRST FLOOR FLAT

ENDSLEIGH GARDENS, SURBITON
INTERNAL FLOOR AREA (APPROX.) 525 sq ft/ 48.8 sq m

Whilst every attempt has been made to ensure the accuracy of this floor plan, measurement of doors, windows, rooms and any other items are approximate and no responsibility is taken for any error, omission or mis-statement. Made with Metropix © 2018.

Energy Efficiency Graph

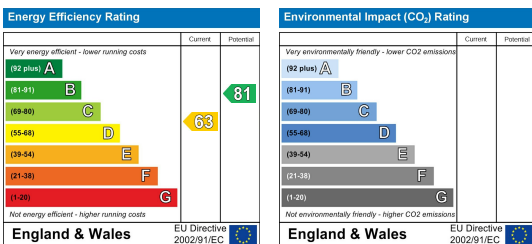

These particulars, whilst believed to be accurate are set out as a general outline only for guidance and do not constitute any part of an offer or contract. Intending purchasers should not rely on them as statements of representation of fact, but must satisfy themselves by inspection or otherwise as to their accuracy. No person in this firm's employment has the authority to make or give any representation or warranty in respect of the property.