

HJC

HIGHER VALUES



Queens Road

Thames Ditton, KT7 0QY

Asking Price £599,950

A charming, end of terrace two bedroom Victorian home in the heart of picturesque Thames Ditton. To front is the sitting room with feature fireplace, sash windows and built in alcove shelving. The rear reception room, with exposed brick fireplace, leads through to the well-proportioned kitchen, cleverly extended to provide a further dining/living room opening on to a mature 35ft NW-facing garden with patio area and garden shed. The property further benefits a downstairs shower/WC. Upstairs are two double bedrooms, each with built-in wardrobe storage, and a master bathroom. Located on one of the sought-after river roads, a short walk to a fantastic gastro pub, rowing club, the River Thames and Summer Road playing fields. A 0.6 mile walk to the station and close to local schools. Opportunity to further extend, STPP. No onward chain.

- End of terrace
- 2 double bedrooms
- 2 bath/shower rooms
- River road
- Characterful period cottage
- 3 reception rooms
- Pretty garden
- No onward chain

Floor Plan

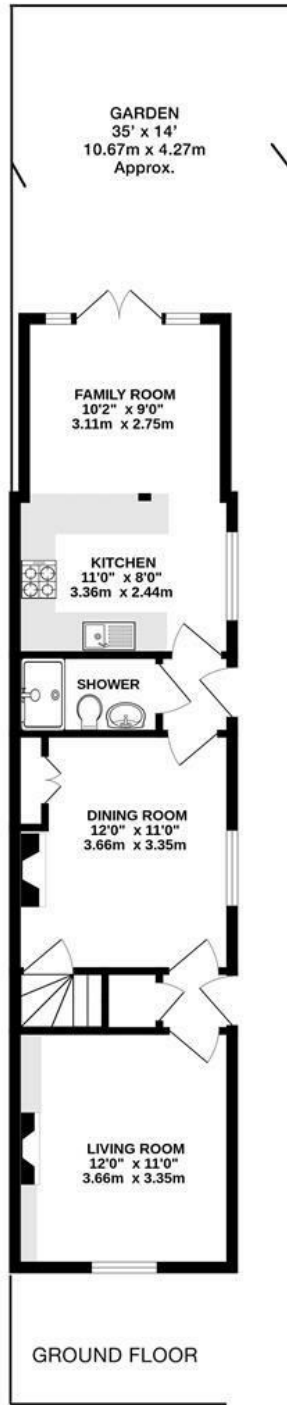

QUEENS ROAD, THAMES DITTON INTERNAL FLOOR AREA (APPROX.) HOUSE 880 sq ft / 81.75 sq m

Whilst every attempt has been made to ensure the accuracy of this floor plan, measurement of doors, windows, rooms and any other items are approximate and no responsibility is taken for any error, omission or mis-statement. Made with Metropix © 2024.

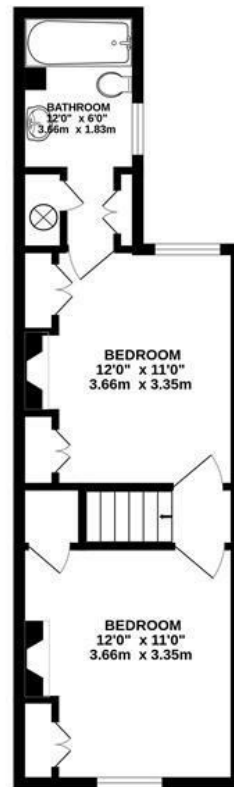

FIRST FLOOR

Energy Efficiency Graph

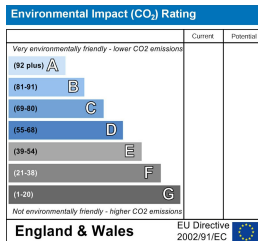
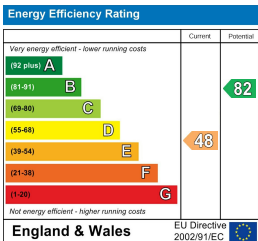

These particulars, whilst believed to be accurate are set out as a general outline only for guidance and do not constitute any part of an offer or contract. Intending purchasers should not rely on them as statements of representation of fact, but must satisfy themselves by inspection or otherwise as to their accuracy. No person in this firm's employment has the authority to make or give any representation or warranty in respect of the property.