

# HJC

HIGHER VALUES



## Weston Park

Thames Ditton, KT7 0HL

£1,000,000

This beautiful semi-detached period four bedroom house of over 1500ft<sup>2</sup>, located in the Weston Green area of Thames Ditton, combines period features with contemporary living, creating a fabulous family home. Extended and improved stylishly to provide spacious accommodation with a superb entertaining space. A generous hallway with ample storage and WC leads to the front reception room, with feature fireplace, log burner and bay window. To the rear an impressive open plan kitchen/dining family area opens via bi-folding doors onto a west facing garden with seating area and pergola. On the first floor are three double bedrooms and modern family bathroom, the top floor boasts a further double bedroom with en-suite facilities and loft storage. Additional features - plantation shutters, sash windows and Victorian style cast iron radiators. Walking distance to schools, amenities and equidistant to Esher and Thames Ditton train stations which run direct lines into London Waterloo.

- Period 4 bedroom family home
- Front reception room with bay window and log burner
- West facing garden
- Quiet location
- Equidistant to Esher & Thames Ditton stations
- Contemporary open plan kitchen/diner
- 2 bathrooms
- Beautifully presented to a high standard
- Sash windows with shutters, old-style radiators
- Close to Weston Green

# Floor Plan

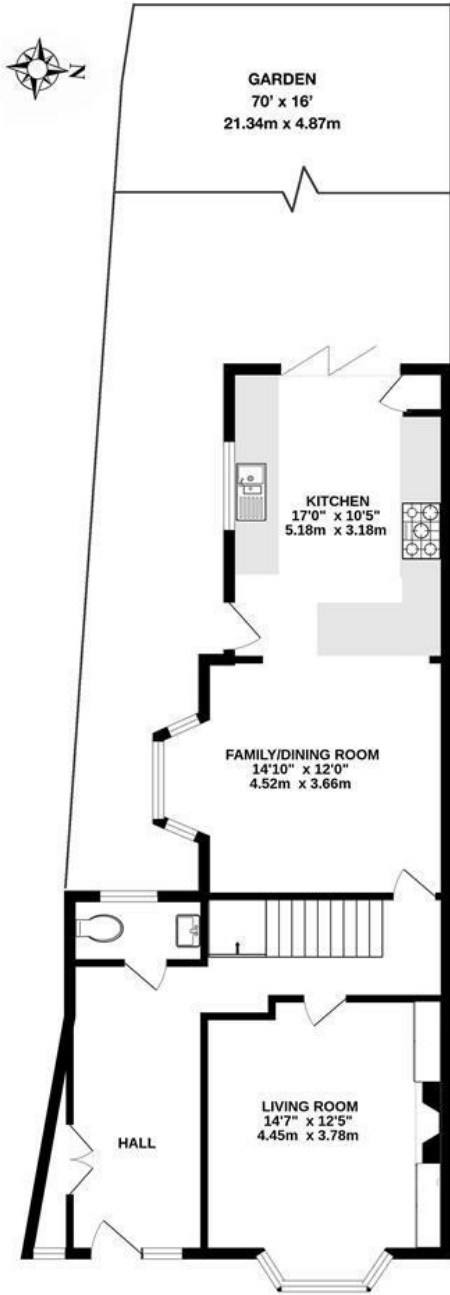

GROUND FLOOR

WESTON PARK, THAMES DITTON  
 INTERNAL FLOOR AREA (APPROX.) 1505 sq ft/ 140.0 sq m  
 Loft Space additional 100 sq ft/ 9.30 sq m

Whilst every attempt has been made to ensure the accuracy of this floor plan, measurement of doors, windows, rooms and any other items are approximate and no responsibility is taken for any error, omission or mis-statement. Made with Metropix © 2023.

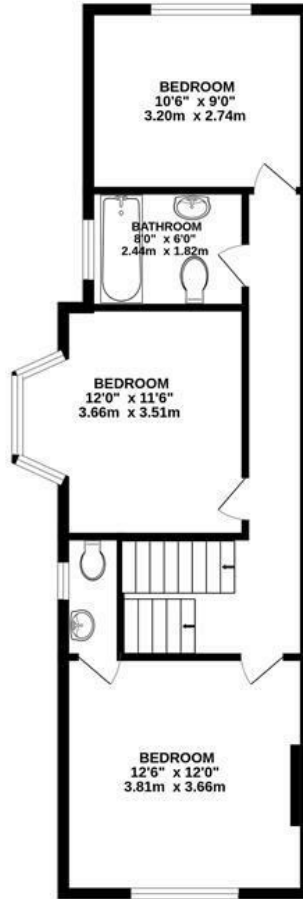

FIRST FLOOR



SECOND FLOOR

## Energy Efficiency Graph

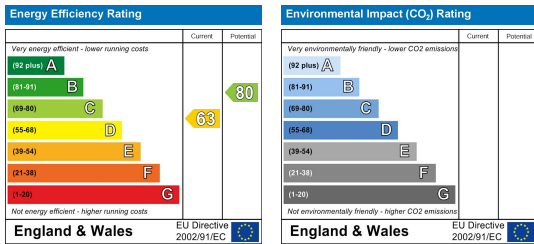

These particulars, whilst believed to be accurate are set out as a general outline only for guidance and do not constitute any part of an offer or contract. Intending purchasers should not rely on them as statements of representation of fact, but must satisfy themselves by inspection or otherwise as to their accuracy. No person in this firm's employment has the authority to make or give any representation or warranty in respect of the property.