



Inglebys

Estate Agents



87 Marine Parade

Saltburn-By-The-Sea, TS12 1BZ

£135,000



A unique opportunity to acquire a truly stunning 1 bedroom apartment, located on Marine Parade, with resident parking. Designed to the highest specification, with no expense spared.



This stunning apartment has been lovingly renovated, the space has been maximised to its full potential, and so provides a perfect bolt hole by the sea with an option to purchase it fully furnished by separate negotiation.

With the added benefit of resident parking, early viewing is essential.

Tenure Details: Share of Freehold.

Council Tax Band: Redcar & Cleveland Borough Council, Band A.

EPC Rating: C Rating

Entrance Hall

Access to Kitchen / Living Room, Bathroom & Bedroom.

Kitchen / Living Room 16'8" x 13'8" (5.09m x 4.19m)

A range of wall, base & drawer units. Marble worktops incorporating electric oven & hob, integrated microwave, and dishwasher. 3 UPVC double glazed windows, with wooden blinds. Electric Opti-Myst stove.

Bathroom 8'0" x 4'11" (2.44m x 1.51m)

Walk-in shower cubicle. Low-level W/C. Wash hand basin in the vanity unit. Part tiled walls. Mosaic tiles to the floor. UPVC double glazed window. Radiator.

Bedroom 12'4" x 9'0" (3.77m x 2.75m)

2 UPVC double glazed windows. Radiator. Storage cupboard housing combi boiler.

Disclaimer

Please note that all measurements contained in these particulars are for guidance purposes only and should not be relied upon for ordering carpets, furniture, etc. Anyone requiring more accurate measurements may do so by arrangement with our office.

Our description of any appliances and / or services (including any central heating system, alarm systems, etc.) should not be taken as any guarantee that these are in working order. The buyer is therefore advised to obtain verification from their solicitor, surveyor or other qualified persons to check the appliances / services before entering into any commitment.

The tenure details and information supplied within the marketing descriptions above are supplied to us by the vendors. This information should not be relied upon for legal purposes and should be verified by a competent / qualified person prior to entering into any commitment.

Area Map



Floor Plans

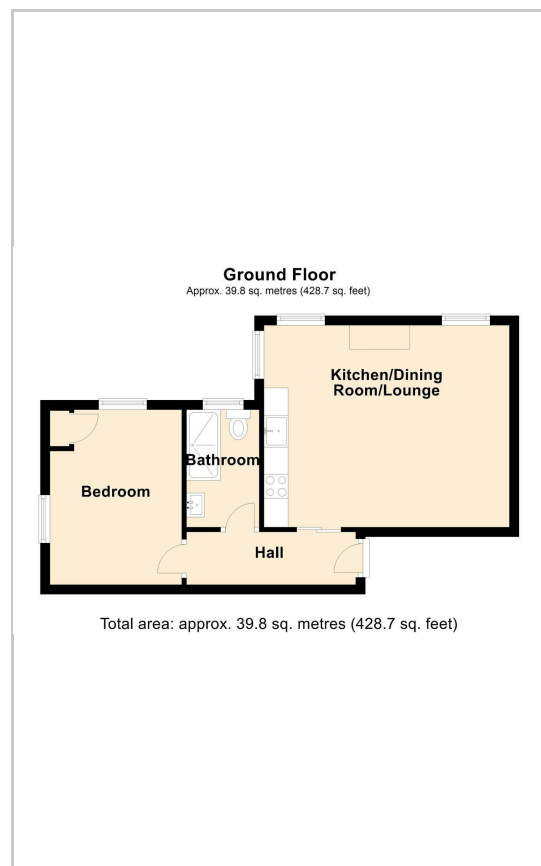

Energy Efficiency Graph

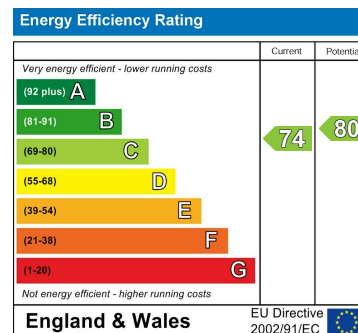

These particulars, whilst believed to be accurate are set out as a general outline only for guidance and do not constitute any part of an offer or contract. Intending purchasers should not rely on them as statements of representation of fact, but must satisfy themselves by inspection or otherwise as to their accuracy. No person in this firm's employment has the authority to make or give any representation or warranty in respect of the property.

Inglebys Estate Agents 4a Station Street, Saltburn by the Sea, North Yorkshire, TS12 1AE
Tel: 01287 623648 Email: enquiries@inglebysestateagents.com www.inglebysestateagents.com