

Parkheath

Sold on Service

Eton Avenue NW3
£4,500 PCM (£1038 per week) - Camden Band G



Superb 3 double bedroom apartment
Secure underground parking and storage
Modern kitchen diner
Family bathroom +separate guest wc
Belsize Park and Swiss Cottage tubes are moments away

Private terrace and communal gardens
Very spacious reception
Master with ensuite shower room
Close to Belsize Park and Primrose Hills amenities
EPC: Rating B, Council Tax: band G

Belsize Park Office 020 7431 3104

Eton Avenue



Approximate Gross Internal Area = 138.2 sq m / 1487 sq ft

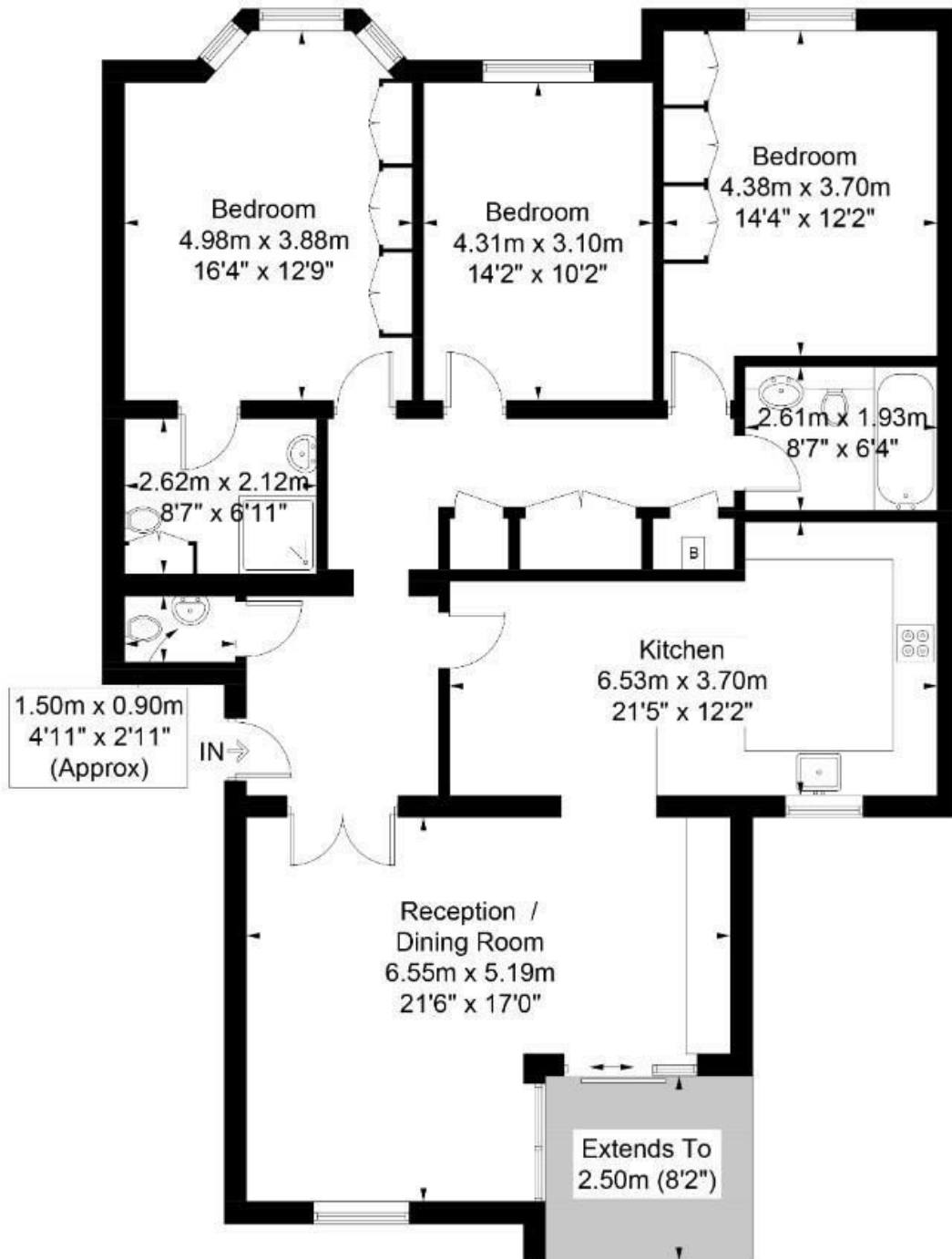

First Floor

Illustration for identification purposes only, measurements are approximate, not to scale. FloorplansUsketch.com © 2017 (ID382707)
ELLIE CLAIRE PHOTOGRAPHY LTD

The particulars do not constitute part of an offer or contract. The particulars, including text, photographs and plans, are for the guidance only of prospective purchasers/tenants and must not be relied upon as statements of fact. The descriptions provided therein represent the opinion of the author and whilst given in good faith should not be construed as statements of fact. Nothing in these particulars shall be deemed a statement that the property is in good condition or otherwise or that any services or facilities are in good working order. All measurements are approximate