

# Parkheath

*Sold on Service*

**Belsize Park NW3**

**£3,358 PCM (£775 per week) - Camden Band G**



Exquisite 3 bedroom apartment  
Entire 1st floor of period conversion  
High end kitchen  
Luxury bathroom

Double fronted period conversion  
Reception and dining room  
2 double and 1 single bedroom  
Close to Swiss Cottage and Belsize Park tubes

Belsize Park Office 020 7431 3104

Belsize Park, NW3  
Approx. Gross Internal Area  
1095 Sq Ft - 101.73 Sq M

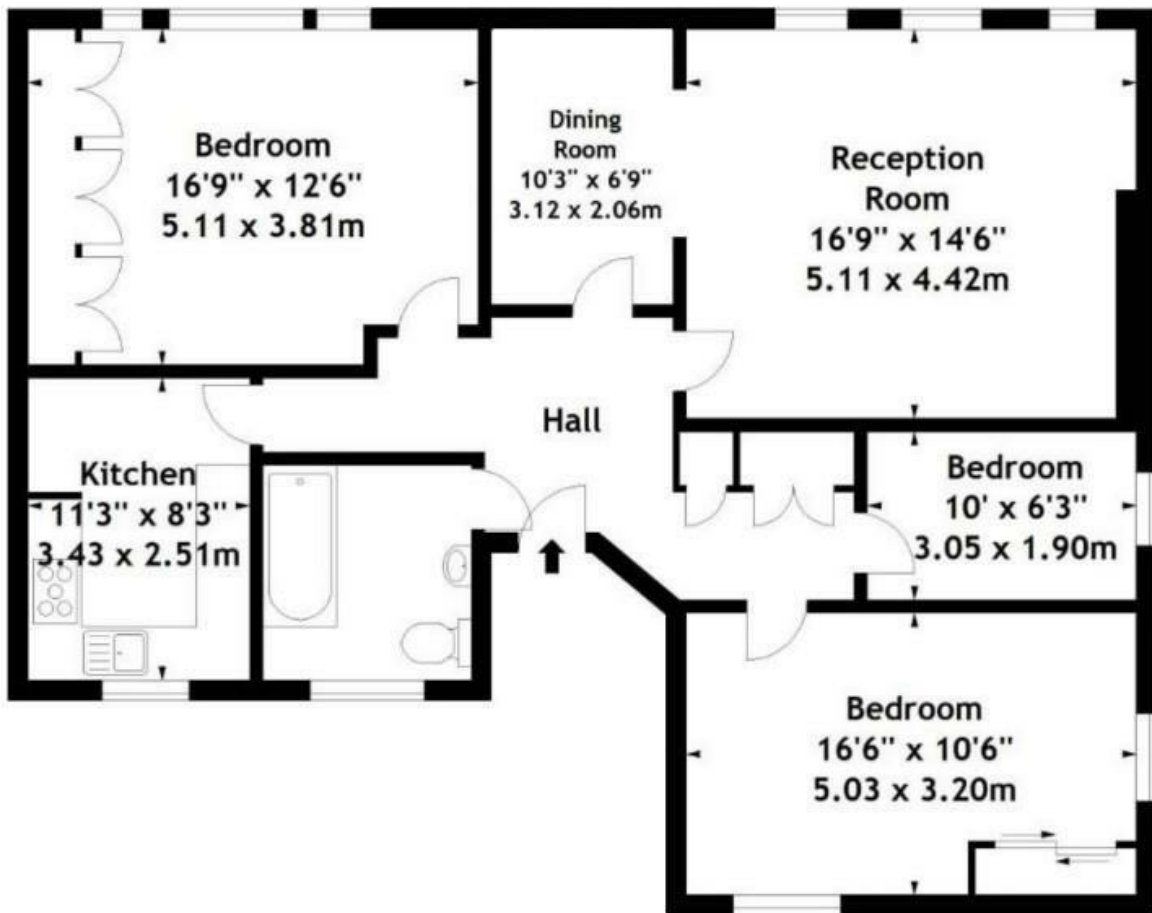

**First Floor**

Measured in accordance with RICS guidelines. Every attempt is made to ensure accuracy, however all measurements are approximate. This floor plan is for illustrative purposes only and is not to scale.

© Datography Ltd 2014

Photographs \* Floorplans \* Virtual Tours  
Tel: 0845 643 4401 [www.datography.com](http://www.datography.com)

The particulars do not constitute part of an offer or contract. The particulars, including text, photographs and plans, are for the guidance only of prospective purchasers/tenants and must not be relied upon as statements of fact. The descriptions provided therein represent the opinion of the author and whilst given in good faith should not be construed as statements of fact. Nothing in these particulars shall be deemed a statement that the property is in good condition or otherwise or that any services or facilities are in good working order. All measurements are approximate