



Willesden Lane NW6

Parkheat
Sold on Service





Willesden Lane, NW6
£500,000
Leasehold

- Very spacious 2 bedroom, 2 bathroom apartment
- 12'6 double bedroom with en-suite bathroom
- Further double bedroom
- Separate eat-in kitchen
- 705 sq ft / 65.50 sq m
- Bright 14'8 reception room
- Second floor of purpose built mansion block
- Excellent transport links, Kilburn (Jubilee), Brondesbury (overground) and Kilburn park (Bakerloo) stations all in close proximity
- Long lease and chain free
- EPC: Energy Rating C



Belsize Park/Hampstead
 208 Haverstock Hill
 NW3 2AG
 Sales 020 7431 1234
 Lettings 020 7431 3104
nw3@parkheath.com

South/West Hampstead
 192 West End Lane
 NW6 1SG
 Sales & Lettings
 Tel 020 7794 7111
192@parkheath.com

Kensal Rise
 54-56 Chamberlayne Rd
 NW10 3JH
 Tel 020 8960 4845
kensal@parkheath.com

Property Management
 192 West End Lane
 NW6 1SG
 020 7433 6174
pm@parkheath.com

Parkheath
Sold on Service

Brent Tax band C

www.parkheath.com

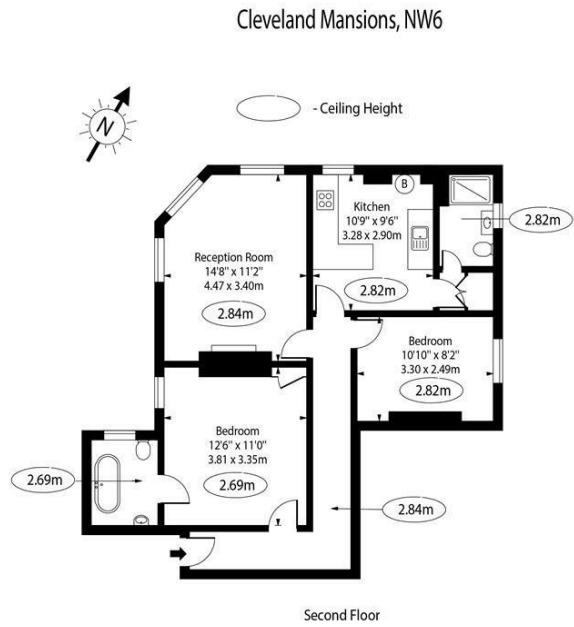

Approx Gross Internal Area 705 Sq Ft - 65.50 Sq M

For Illustration Purposes Only - Not To Scale Floor Plan by www.nogaphotostudio.com Ref: No.49694

This floor plan should be used as a general outline for guidance only. Any intending purchaser or lessee should satisfy themselves by inspection, searches, enquiries and full survey as to the correctness of each statement. Any areas, measurements or distances quoted are approximate and should not be used to value a property or be the basis of any sale or let.

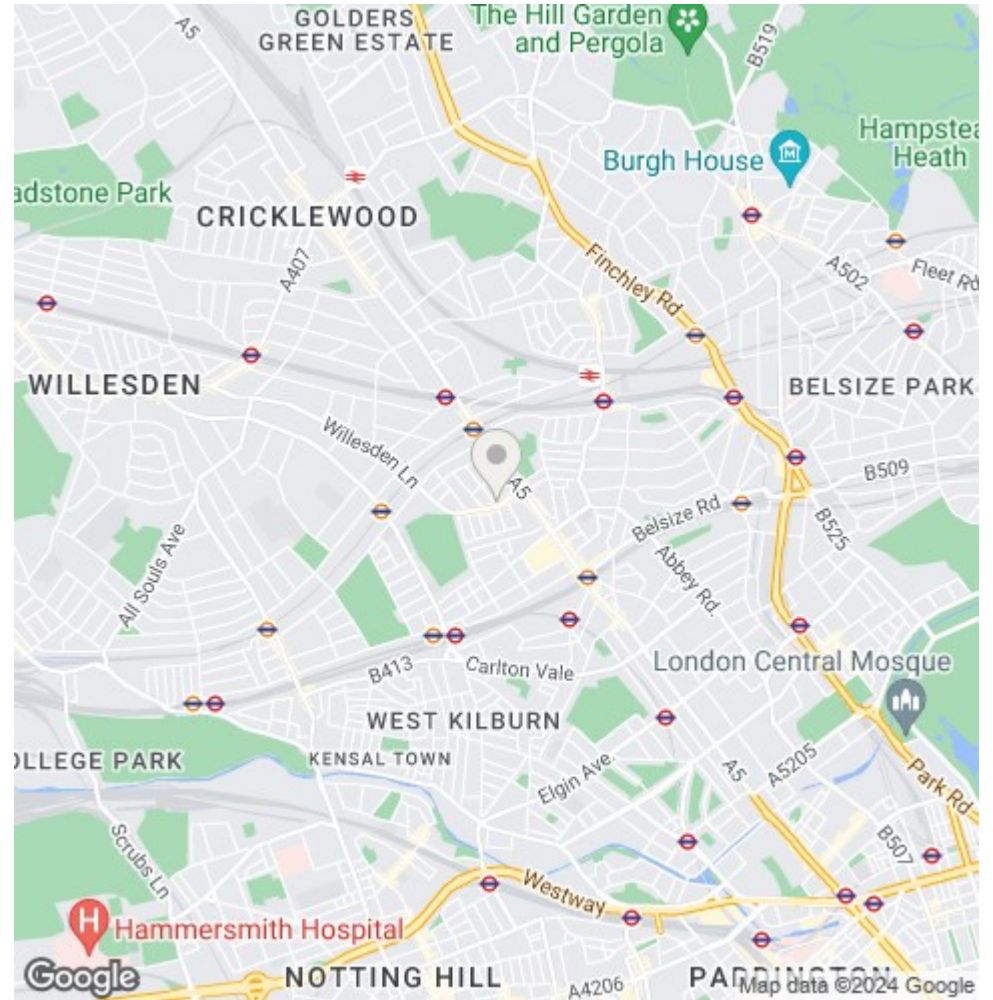

The particulars do not constitute part of an offer or contract. The particulars, including text, photographs and plans, are for the guidance only of prospective purchasers/tenants and must not be relied upon as statements of fact. The descriptions provided therein represent the opinion of the author and whilst given in good faith should not be construed as statements of fact. Nothing in these particulars shall be deemed a statement that the property is in good condition or otherwise or that any services or facilities are in good working order. All measurements are approximate