

Parkheath

Sold on Service

Crediton Hill NW6

£4,000 PCM (£923 per week) - Camden Band F



Superb 3 double bedroom duplex apartment
1923 Sq Ft / 178.65 Sq M
Wooden floors throughout (carpets to internal staircases)
Contemporary fitted kitchen
Decked terrace with stunning views

Sought after residential location
2nd and 3rd floor of a period conversion
Spacious reception/dining room
3 bathrooms (all en suite) and guest WC
EPC rating C / Council tax: Camden band F

West Hampstead Office 020 7794 7111

Crediton Hill, NW6
 Approx. Gross Internal Area
 1923 Sq Ft - 178.65 Sq M
 (Including Eaves Storage)

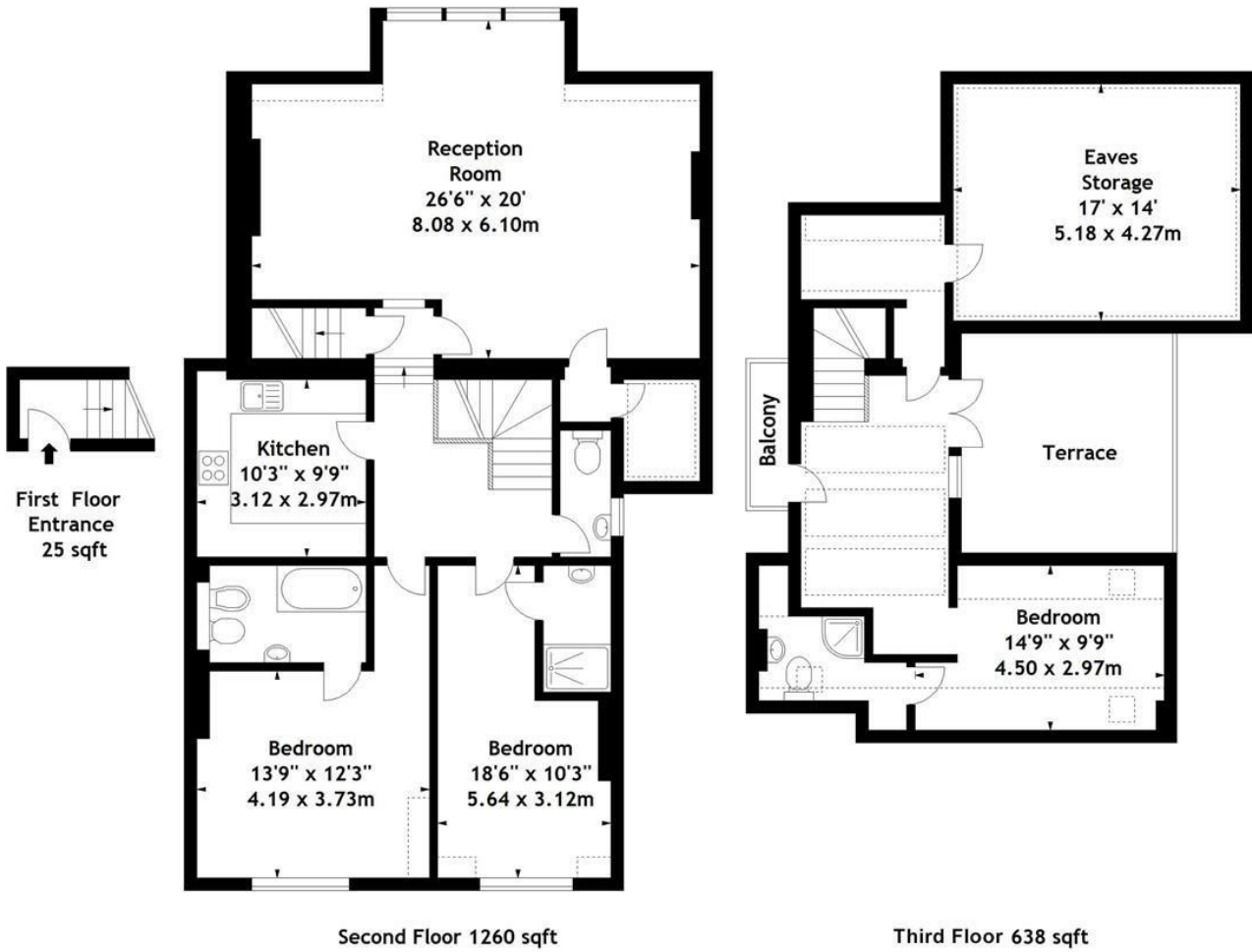

Measured in accordance with RICS guidelines. Every attempt is made to ensure accuracy, however all measurements are approximate. This floor plan is for illustrative purposes only and is not to scale.
 © Datagraphy Ltd 2015
 Photographs * Floorplans * Virtual Tours
 Tel: 0845 643 4401 www.datagraphy.com

The particulars do not constitute part of an offer or contract. The particulars, including text, photographs and plans, are for the guidance only of prospective purchasers/tenants and must not be relied upon as statements of fact. The descriptions provided therein represent the opinion of the author and whilst given in good faith should not be construed as statements of fact. Nothing in these particulars shall be deemed a statement that the property is in good condition or otherwise or that any services or facilities are in good working order. All measurements are approximate