

# Parkheath

*Sold on Service*

**Fordwych Road NW2**

**£2,200 PCM (£508 per week) - Camden Band D**



Bright and spacious 2 bedroom apartment  
Large 18' main bedroom with fitted storage  
Separate fitted kitchen  
Communal garden  
Approx 7 minute walk to Kilburn station (Jubilee line)

815 Sq Ft / 75.7 Sq M  
17' reception/dining room  
Top floor (3rd) of purpose built block  
Short walk to West Hampstead and Kilburn amenities  
EPC energy rating: D / Council tax: Camden band D

West Hampstead Office 020 7794 7111

**Fordwych Road**  
Approximate Gross Internal Area = 75.7 Sq m / 815 sq ft

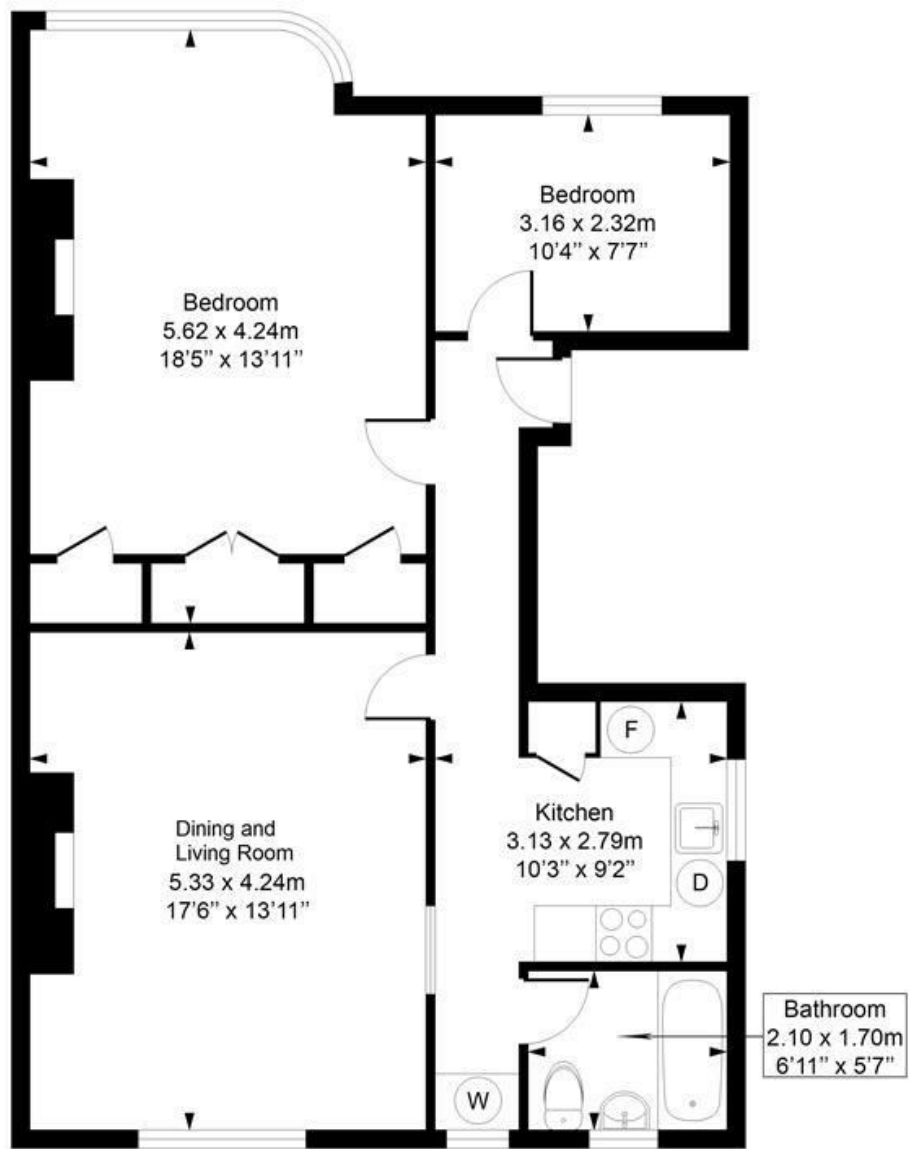

**Third Floor**

This plan is for layout guidance only. Drawn in accordance with RICS guidelines. Not drawn to scale unless stated. Windows & door openings are approximate. Whilst every care is taken in the preparation of this plan, please check all dimensions, shapes & compass bearings before marking any decisions reliant upon them.

ELLIE CLAIRE PHOTOGRAPHY LTD  
[www.ellieclairephotography.com](http://www.ellieclairephotography.com)

The particulars do not constitute part of an offer or contract. The particulars, including text, photographs and plans, are for the guidance only of prospective purchasers/tenants and must not be relied upon as statements of fact. The descriptions provided therein represent the opinion of the author and whilst given in good faith should not be construed as statements of fact. Nothing in these particulars shall be deemed a statement that the property is in good condition or otherwise or that any services or facilities are in good working order. All measurements are approximate