





Offers in excess of £900,000

84 Five Heads Road

Catherington, PO8 9NZ

- INDIVIDUAL DETACHED CHALET STYLE HOME
- VERSATILE ACCOMMODATION/ANNEXE POTENTIAL
- LARGE DRIVEWAY & GARAGE
- FOUR BATHROOMS
- SEMI RURAL LOCATION
- FIVE BEDROOMS
- OPEN PLAN KITCHEN/DINING/FAMILY ROOM
- UTILITY ROOM
- RURAL VIEWS TO THE FRONT
- APPROX 0.25 ACRE PLOT

Welcome to your dream retreat in the heart of Catherington! This exceptional detached chalet-style home boasts a generous footprint of just shy of 3000 sq ft, sitting on a plot of approx 0.25 of an acre. Offering a perfect blend of space, style, and tranquility. With five bedrooms, a study, and four bathrooms, including two luxurious en-suites, this residence caters to both comfort and practicality.



As you enter this home you are greeted by a welcoming entrance hallway with stairs to the first floor and doors accessing all principle rooms. Step into the inviting snug lounge, adorned with two charming bay windows that fill the room with natural light. Warm up on chilly evenings beside the wood-burning stove, creating a cozy ambiance for relaxation. Entertain in style in the large open plan kitchen/dining/family room, a focal point of the home. The kitchen is a culinary haven, equipped with modern amenities, while the dining and family areas are flooded with light from the roof lantern and two pairs of bi-fold doors that open onto the mature rear gardens. Enjoy the seamless transition between indoor and outdoor living, creating a perfect setting for gatherings and alfresco dining. The kitchen seamlessly flows into a spacious utility room, ensuring convenience is at the forefront of daily living. For more formal occasions, a dedicated dining room provides an elegant space to host dinners and celebrations. The attention to detail in design and finishes is evident throughout, creating a harmonious and luxurious living experience. A pair of double sized bedrooms with a Jack and Jill en-suite and dressing room completes the ground floor, this space offers versatility and could create an annexe or teenage suite. The property extends its charm to the outdoors, where mature gardens surround the home. Take in the picturesque rural views across open fields from the front of the house, providing a serene backdrop to everyday life. As an added bonus, a detached timber outbuilding in the rear gardens serves as an ideal games room, offering a retreat for recreation and entertainment. The detached garage and ample parking to the front ensure practicality and convenience for residents and guests alike. To the first floor there are three double sized bedrooms. The master suite has a walk-through dressing area and an en-suite bathroom. Bedroom two also boasts an en-suite shower room. The family bathroom is finished with a modern white three piece suite. There is also a study, which enjoys views to the front over the surrounding countryside.

Experience the epitome of comfort, style, and serenity in this enchanting chalet-style home in Catherington. With its thoughtfully designed spaces, breathtaking views, and premium amenities, this property invites you to embrace a lifestyle of luxury and relaxation. Welcome home to your private oasis.







Floor Plans

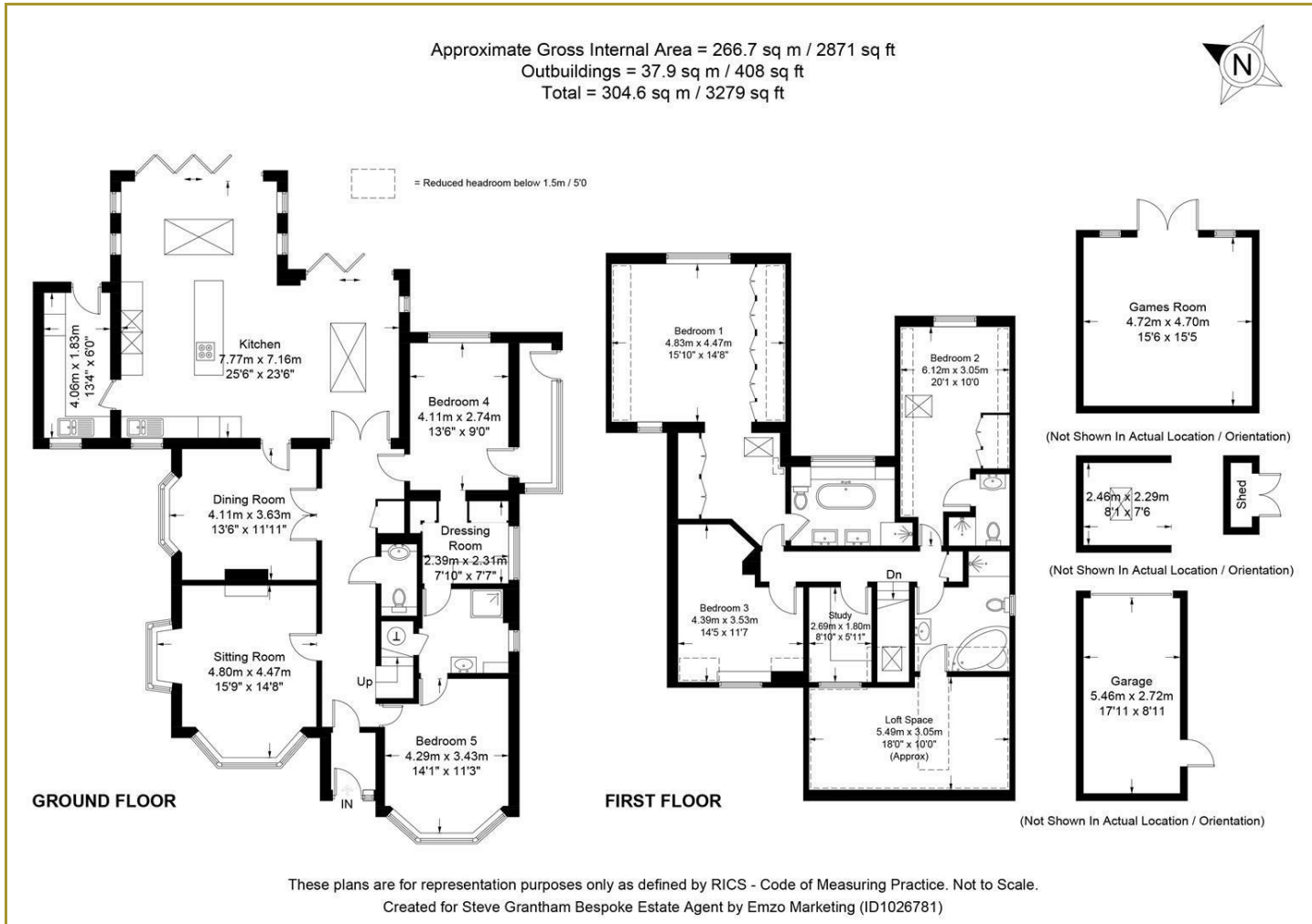

Viewing

Please contact our Steve Grantham Bespoke Office on 02393 090015 if you wish to arrange a viewing appointment for this property or require further information.

The particulars are set out as a general outline only for the guidance of intended purchasers or lessees, and do not constitute, any part of a contract. Nothing in these particulars shall be deemed to be a statement that the property is in good structural condition or otherwise nor that any of the services, appliances, equipment or facilities are in good working order. Purchasers should satisfy themselves of this prior to purchasing.

Location Map

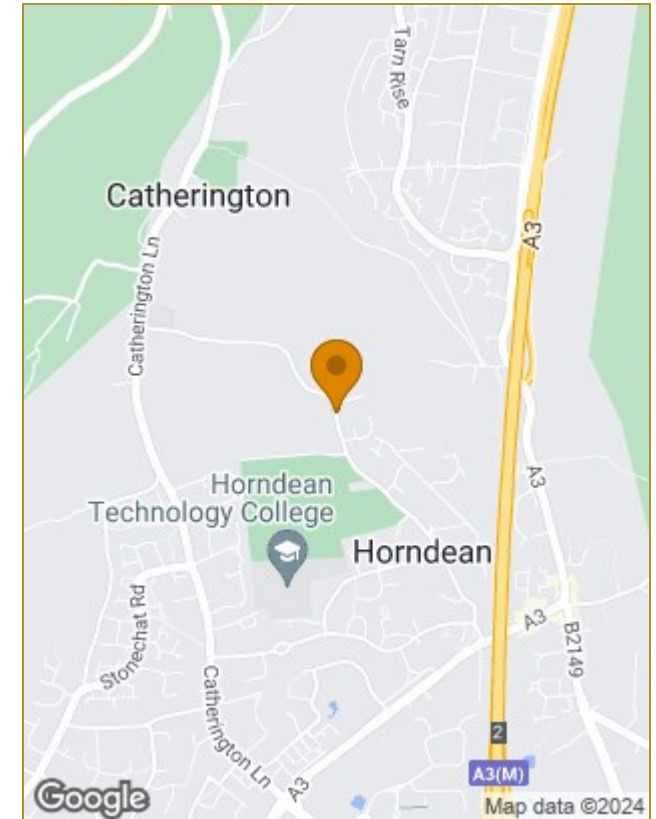

Energy Performance Graph

