



10 Midvale Road  
St. Helier, Jersey, JE2 3TY

£885,000

ROOFING  
BUILDING RENOVATIONS  
GENERAL MAINTENANCE  
**B-PROTECT**  
EXPERTS IN LIQUID  
WATERPROOFING SYSTEMS  
07700 339 112 - 01534 880769  
email: service@b-protect.uk

4 4 4



## 10 Midvale Road

St. Helier, Jersey, JE2 3TY

Freehold - This Victorian property is situated on the outskirts of St Helier Town Center, with all the facilities the town has to offer at your finger tips. The property has been divided into four very generous one double bedroom apartments. Each floor is self contained and the apartments are all in very good order with new secondary double glazed window, new boilers and are up to date with all the Fire Regulations. Three of the apartment have an outside patio area. No Parking, Town carparks and residential parish on road parking nearby.

Fabulous opportunity to purchase a block of four apartments as a by to let or alternatively you can split the apartment and sell of individual.

Services: All mains excluding Gas, Secondary double glazing, Wi-Fi.





## Floor Plan

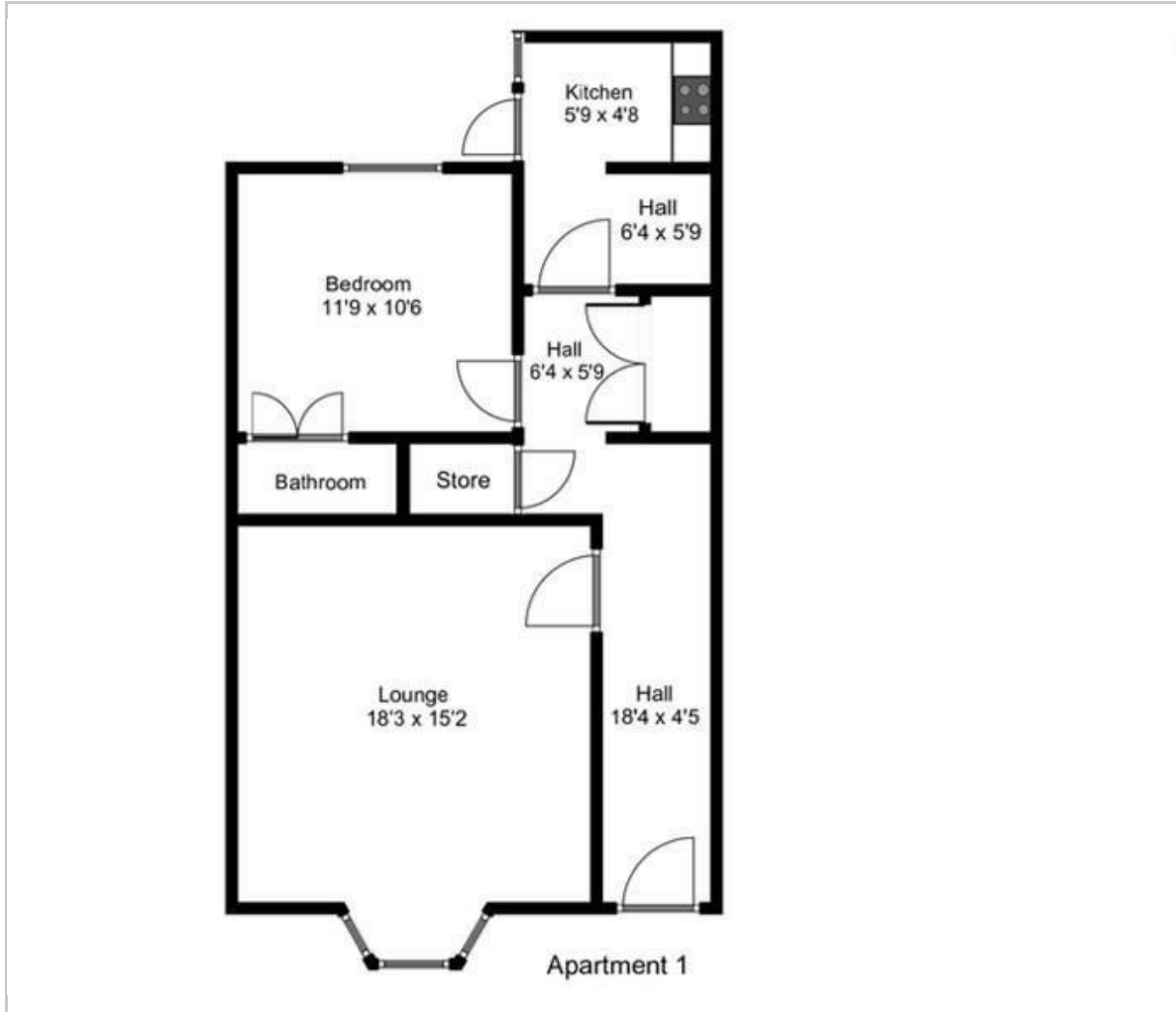

## Viewing

Please contact our Troys Estate Agency Ltd Office on 01534 607070 if you wish to arrange a viewing appointment for this property or require further information.

These particulars, whilst believed to be accurate are set out as a general outline only for guidance and do not constitute any part of an offer or contract. Intending purchasers should not rely on them as statements of representation of fact, but must satisfy themselves by inspection or otherwise as to their accuracy. No person in this firm's employment has the authority to make or give any representation or warranty in respect of the property.

10 Sand Street, St Helier, Jersey, JE2 3QF  
Tel: 01534 607070 Email: duty@troysjsy.com

## Area Map



## Energy Efficiency Graph

