



Lebanon Road, Croydon, CR0 6UU

£1,950 PCM



Lebanon Road, Croydon, CR0 6UU

£1,950 PCM



Full of character, this attractive end of terrace home offers the perfect combination of comfortable living and convenience. The accommodation briefly comprises bay fronted living room, separate dining room through to a modern kitchen fitted with a gas hob, electric oven, fridge/freezer and washing machine. To the first floor are two double bedrooms with feature fireplace and a family bathroom off the master bedroom. There is also a quiet and secluded low maintenance rear garden.

This property has excellent transport links including a tram stop at the end of the road and one stop from East Croydon station with direct links to Brighton, London Bridge and London Victoria.

Council Tax Band: D (London Borough of Croydon)
Holding Deposit: £450



Road Map

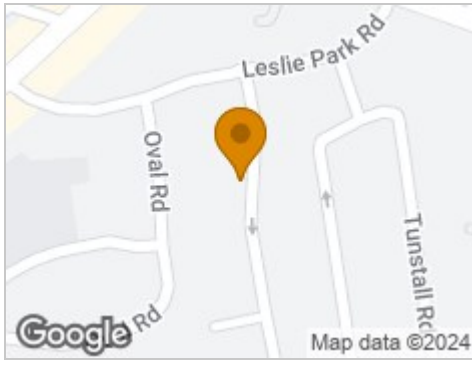

Hybrid Map



Terrain Map



Floor Plan

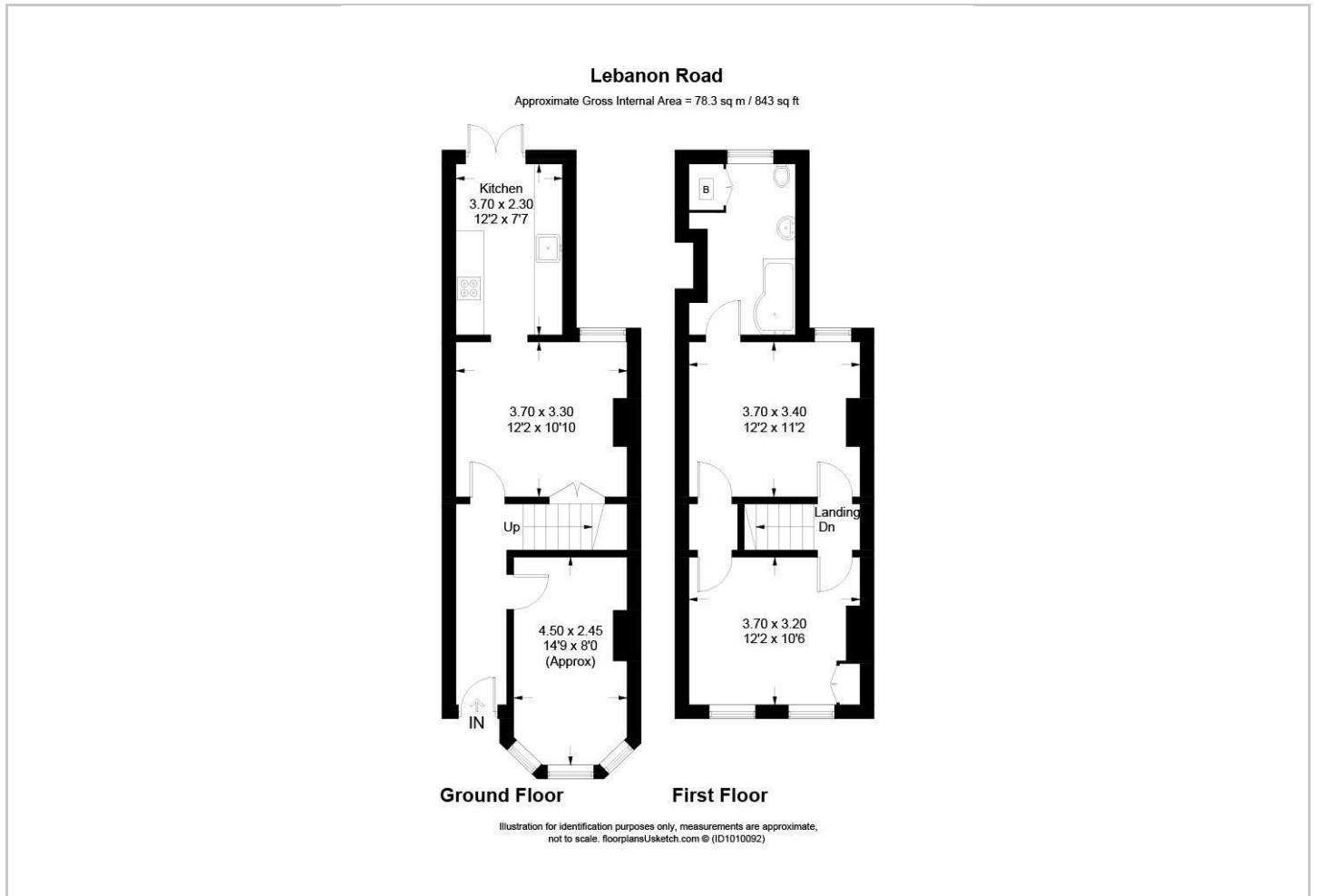

Viewing

Please contact our Hirsch Estates Office on 020 3002 0587 if you wish to arrange a viewing appointment for this property or require further information.

Energy Efficiency Graph

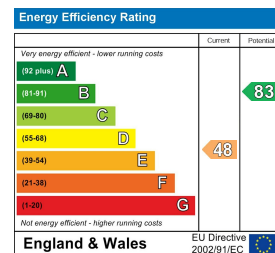

These particulars, whilst believed to be accurate are set out as a general outline only for guidance and do not constitute any part of an offer or contract. Intending purchasers should not rely on them as statements of representation of fact, but must satisfy themselves by inspection or otherwise as to their accuracy. No person in this firm's employment has the authority to make or give any representation or warranty in respect of the property.