

GUIDE PRICE

**£550,000**

**Bulls Copse Lane**

Horndean, PO8 9QX



## PROPERTY SUMMARY

Located in one of the most popular locations in Horndean, we are delighted to offer for sale this spacious 2/3 bedroom detached bungalow in Bulls Copse Lane. This property has a magnificent large rear garden and an overall plot of over 350ft in length internal viewings really are a must to fully appreciate all that is on offer at this deceptively spacious property. The property is set back from the road and boasts a sweeping driveway and detached garage with considerable off road parking. Internally there are 2 double bedrooms with en-suite facilities to the master, large kitchen/diner (diner originally bed 3), family bathroom, basement room and a lovely light airy lounge. The rear garden really is superb and has masses of potential. To arrange your viewing contact Jeffries & Dibbens as sole agents today.







**ENTRANCE HALL** Windows to front and side aspects, door to front, radiator, lantern style roof, extensive storage and meter cupboards, doors to:

**BEDROOM 1** 11' 11" x 11' 10" (3.63m x 3.61m) Bow window to front aspect, radiator, extensive built in wardrobes and furniture, door to:

**ENSUITE** 7' x 5' 11" (2.13m x 1.8m) Window to side aspect, heated towel rail, double shower cubicle, hand wash basin with vanity surround and cupboard under, WC.

**BATHROOM** Skylight window, heated towel rail, panelled bath with shower over, hand wash basin, WC, extractor, fully tiled.

**BEDROOM 2** 12' x 9' 05" (3.66m x 2.87m) Window to side aspect, radiator, cupboard housing hot water tank.

**KITCHEN/DINER** 20' 07" max x 18' 09" max (6.27m x 5.72m) Dining room originally bedroom 3. Two windows and door to rear garden, window to front aspect, radiator, range of fitted cupboards, units and work surfaces, 1 1/2 bowl sink unit with mixer tap over, integrated double oven, hob and extractor, space for fridge freezer, plumbing for washing machine and dishwasher.

**LOUNGE** 17' 01" x 16' 03" (5.21m x 4.95m) Windows to side and rear aspects, bi-fold doors to rear garden, 2 radiators, log burner, Parquet flooring, steps down to:

**BASEMENT ROOM** 16' 04" x 10' 10" (4.98m x 3.3m) Radiator, light and power.

**OUTSIDE** Front - Large frontage with sweeping driveway leading to car port and considerable off road parking, mature shrubs and trees, access to:

**DETACHED GARAGE** Electric roller door, light and power, window and door to rear.

**REAR GARDEN** Extensive and very large mature rear garden with extensive lawned areas and an abundance of shrubs and borders. Outside light, tap and storage areas. Raised decked area with glass panels overlooking the garden



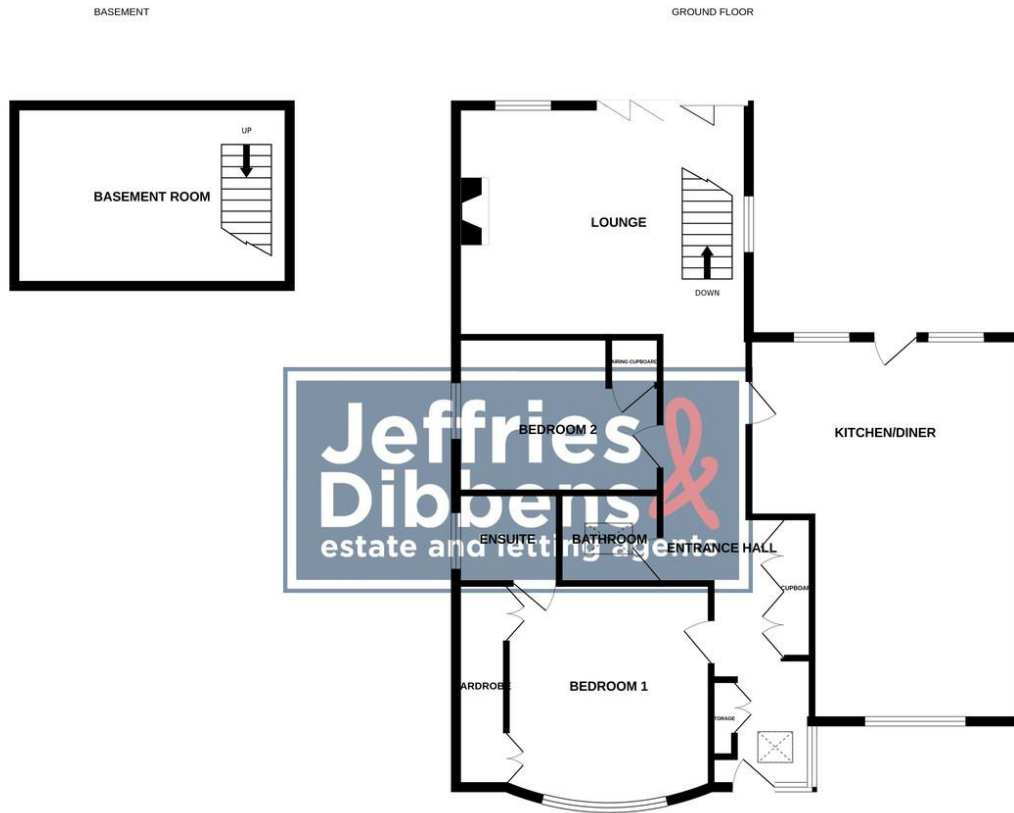

Whilst every attempt has been made to ensure the accuracy of the floorplan contained here, measurements of doors, windows, rooms and any other items are approximate and no responsibility is taken for any error, omission or mis-statement. This plan is for illustrative purposes only and should be used as such by any prospective purchaser. The services, systems and appliances shown have not been tested and no guarantee as to their operability or efficiency can be given.  
 Made with Metropix ©2024

**LOCAL AUTHORITY**  
 East Hampshire District Council

**TENURE**  
 Freehold

**COUNCIL TAX BAND**  
 Band D

**VIEWINGS**  
 By prior appointment only

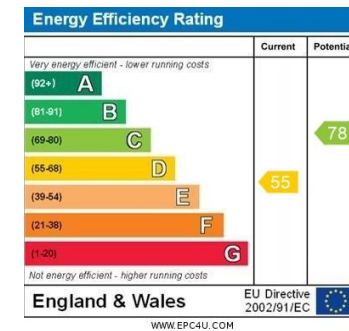

Agents Note: Whilst every care has been taken to prepare these particulars, they are for guidance purposes only. All measurements are approximate and are for general guidance purposes only and whilst every care has been taken to ensure their accuracy, they should not be relied upon and potential buyers/tenants are advised to recheck the measurements



**OFFICE ADDRESS**  
 226 London Road, Waterlooville,  
 Hampshire, PO7 7HP

**CONTACT**  
 023 9223 1100  
 waterlooville@jeffries.co.uk  
 www.jdea.co.uk