

£375,000

16 Heath Road North

Southampton, SO31 7PL

PROPERTY SUMMARY

NO FORWARD CHAIN We are delighted to present to the market this detached three bedroom bungalow located on the popular road of Heath Road North. The property comprises of an entrance porch, three good size bedrooms, a shower room, a bathroom, a spacious open plan sitting/dining room, a kitchen with access to the large rear garden and a utility room. Externally, the rear garden is mainly laid to lawn with a patio area, there is also a large lean to and garage with power/electric and to the front of the property there is a driveway for off road parking for multiple vehicles. Internal viewing recommended to appreciate the space this property has to offer. Please contact our Fareham Office to get booked in!

3 

2 

1 





FRONT Driveway

PORCH

BEDROOM 1 11' 05" x 9' 03" (3.48m x 2.82m)

BEDROOM 2 11' 0" x 9' 01" (3.35m x 2.77m)

BEDROOM 3 11' 02" x 8' 00" (3.4m x 2.44m)

SITTING ROOM 15' 06" x 12' 00" (4.72m x 3.66m)

DINING ROOM 14' 00" x 12' 05" (4.27m x 3.78m)

KITCHEN 12' 04" x 8' 03" (3.76m x 2.51m)

UTILITY ROOM 8' 05" x 6' 03" (2.57m x 1.91m)

BATHROOM

SHOWER ROOM

LEAN TO 19' 00" x 6' 06" (5.79m x 1.98m)

GARAGE 16' 06" x 7' 11" (5.03m x 2.41m)

REAR GARDEN

GROUND FLOOR

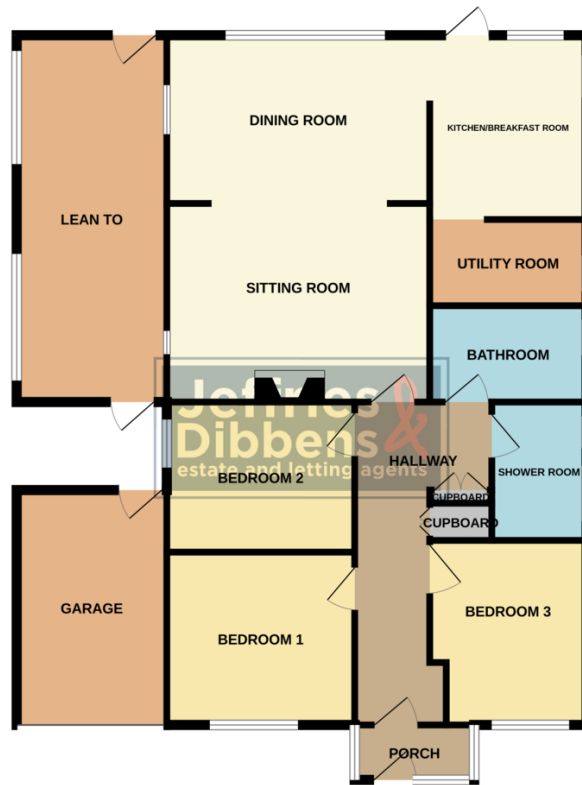

Whilst every attempt has been made to ensure the accuracy of the floorplan contained here, measurements of doors, windows, rooms and any other items are approximate and no responsibility is taken for any error, omission or mis-statement. This plan is for illustrative purposes only and should be used as such by any prospective purchaser. The services, systems and appliances shown have not been tested and no guarantee as to their operability or efficiency can be given.
Made with Metropix ©2024

LOCAL AUTHORITY
Fareham Borough Council

TENURE
Freehold

COUNCIL TAX BAND
Band E

VIEWINGS
By prior appointment only

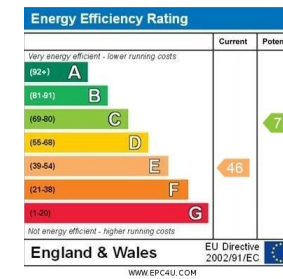

Agents Note: Whilst every care has been taken to prepare these particulars, they are for guidance purposes only. All measurements are approximate and are for general guidance purposes only and whilst every care has been taken to ensure their accuracy, they should not be relied upon and potential buyers/tenants are advised to recheck the measurements



OFFICE ADDRESS
6 West Quay House, 20 West Street, Fareham, Hampshire, PO16 0LG

CONTACT
01329 888 328
fareham@dibbensproperty.co.uk
www.jdea.co.uk