

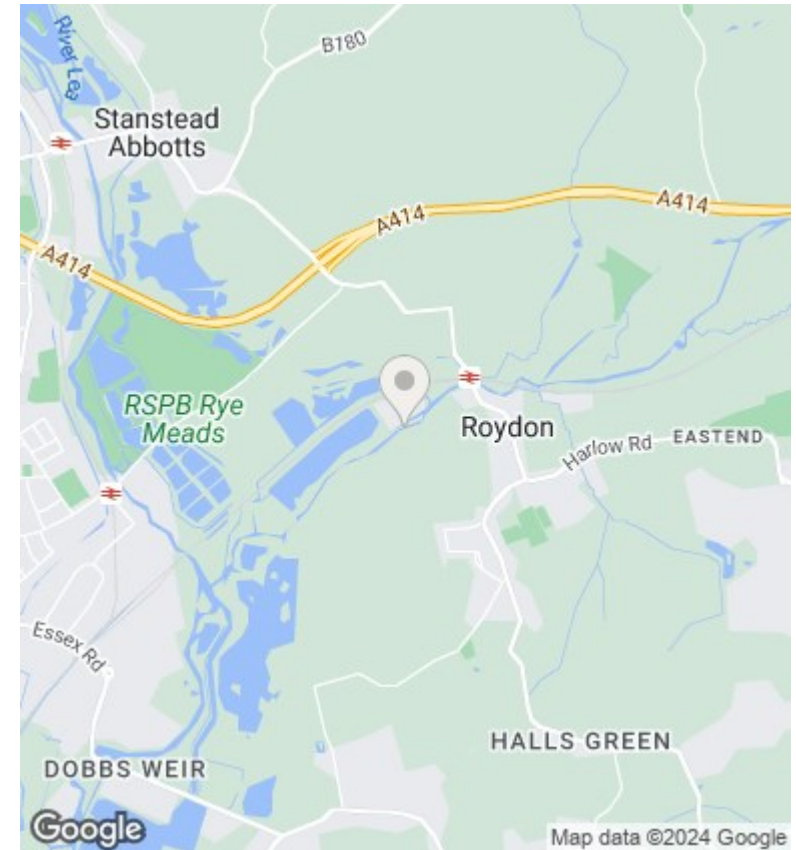

2 Roydon Mill, Roydon, Essex, CM19 5EJ

Asking Price £295,000

- MAISONETTE WITH OWN ENTRANCE
- CLOSE TO STATION
- COOMUNAL GARDEN AREA
- GROUND FLOOR
- PARKING
- DOUBLE BEDROOMS
- GARAGE

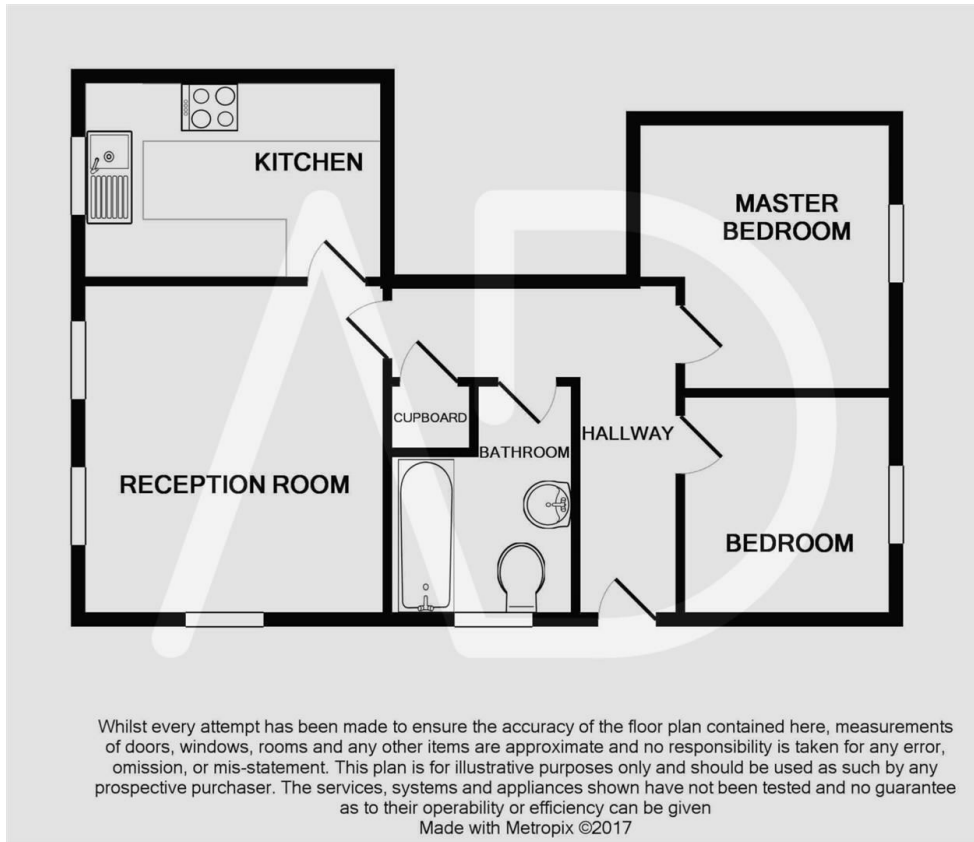

Directions

Viewings

Viewings by arrangement only. Call 01992 470335 to make an appointment.

Council Tax Band

B

EPC Rating:

E

Energy Efficiency Rating		Current	Potential
<i>Very energy efficient - lower running costs</i>			
(92 plus) A			
(81-91) B			
(69-80) C			
(55-68) D			
(39-54) E		45	59
(21-38) F			
(1-20) G			
<i>Not energy efficient - higher running costs</i>			
England & Wales		EU Directive 2002/91/EC	