



2 LOCHAY DRIVE
COMRIE, PERTSHIRE, PH6 2PE

IrvingGeddes
W.S. • Solicitors • Estate Agents

2 LOCHAY DRIVE, COMRIE, PERTSHIRE, PH6 2PE

Irving Geddes are delighted to offer for sale this well-maintained three bedroom detached bungalow located within a popular residential area of the sought-after Perthshire village of Comrie. A well proportioned layout comprising an ENTRANCE VESTIBULE, HALL with storage, open plan LIVING ROOM with DINING AREA and patio doors leading to a large CONSERVATORY with central heating radiator and upvc French doors leading to the garden area, FITTED KITCHEN, THREE DOUBLE BEDROOMS (one with en-suite cloakroom) and family BATHROOM.

The property has good sized mature gardens. The front laid to gravel with shrubbery and paved paths with drive leading to a detached single garage. The attractive rear garden is laid with chippings & area lawn, with mature planting, timber decked area & timber fence border. Warmed by gas central heating & double glazed throughout. A quality built bungalow within easy reach of the village centre, enjoying a prime location in one of Perthshire's most sought after villages. Likely to have broad appeal, early viewing is advised.

Energy Performance Rated 'C' **Council Tax** Band 'E'

Viewing Strictly by appointment through Irving Geddes - 01764 653771.

Comrie is a beautiful, lively village nestling on the banks of the River Earn, some 7mls west of Crieff & only 25mls from the Cities of Perth & Stirling. There are a number of independent shops, hotels, restaurants, and a medical centre and dentist. There is Primary schooling within the village and both private and public education available within Crieff. A haven for outdoor enthusiasts, there are river, woodland, hill and mountain walks surrounding the village, renowned mountain biking at 'Comrie Croft' and water sports and fishing at Loch Earn (6mls).

Irving Geddes
W.S. • Solicitors • Estate Agents













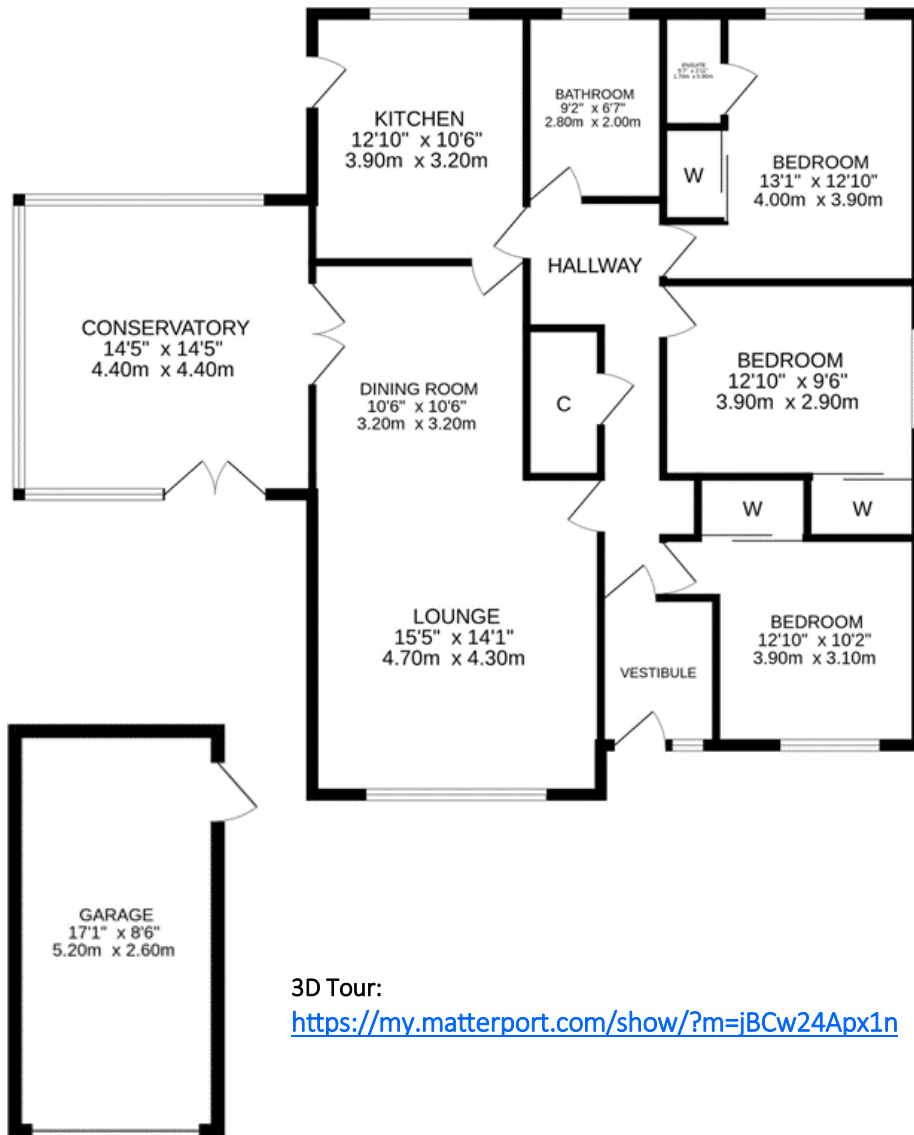

3D Tour:

<https://my.matterport.com/show/?m=jBCw24Ap1n>





Crieff
25 West High Street, PH7 4AU
Tel: 01764 653771

Comrie
1 Drummond Street, PH6 2DW
Tel: 01764 670325

Aberfeldy
6 The Square, PH15 2DD
Tel: 01887 822722