

7 TURLEUM ROAD
CRIEFF. PH7 3QE



IrvingGeddes
W.S. • Solicitors • Estate Agents

7 TURLEUM ROAD, CRIEFF, PH7 3QE

A beautifully presented modern two bedroom detached bungalow located in a prime residential area of Crieff. Formerly a three bedroom property, the current owners removed one bedroom to create a larger 2nd bedroom and additional storage. The property benefits from gas fired central heating, double glazing, private garden and a large detached garage with utility room.

The well proportioned layout comprises; HALLWAY with built-in storage and walk-in store, large LOUNGE, modern fitted KITCHEN, 2 DOUBLE BEDROOMS, and SHOWER ROOM.

The front and side consist of a mono-bloc parking bay and driveway to a large detached garage with separate utility area. The rear garden has an area of lawn and gravel, raised beds and paved patio.

A property likely to have broad appeal, presented in true move-in condition and enjoying a sought-after location. Early interest is advised.

Energy Performance C Rating **Council Tax** Band D

Services Mains water, electric, gas and drainage.

Viewing Strictly by appointment through Irving Geddes.

Video Tour <https://my.matterport.com/show/?m=hXubeGxW45S>



Irving Geddes
W.S. • Solicitors • Estate Agents











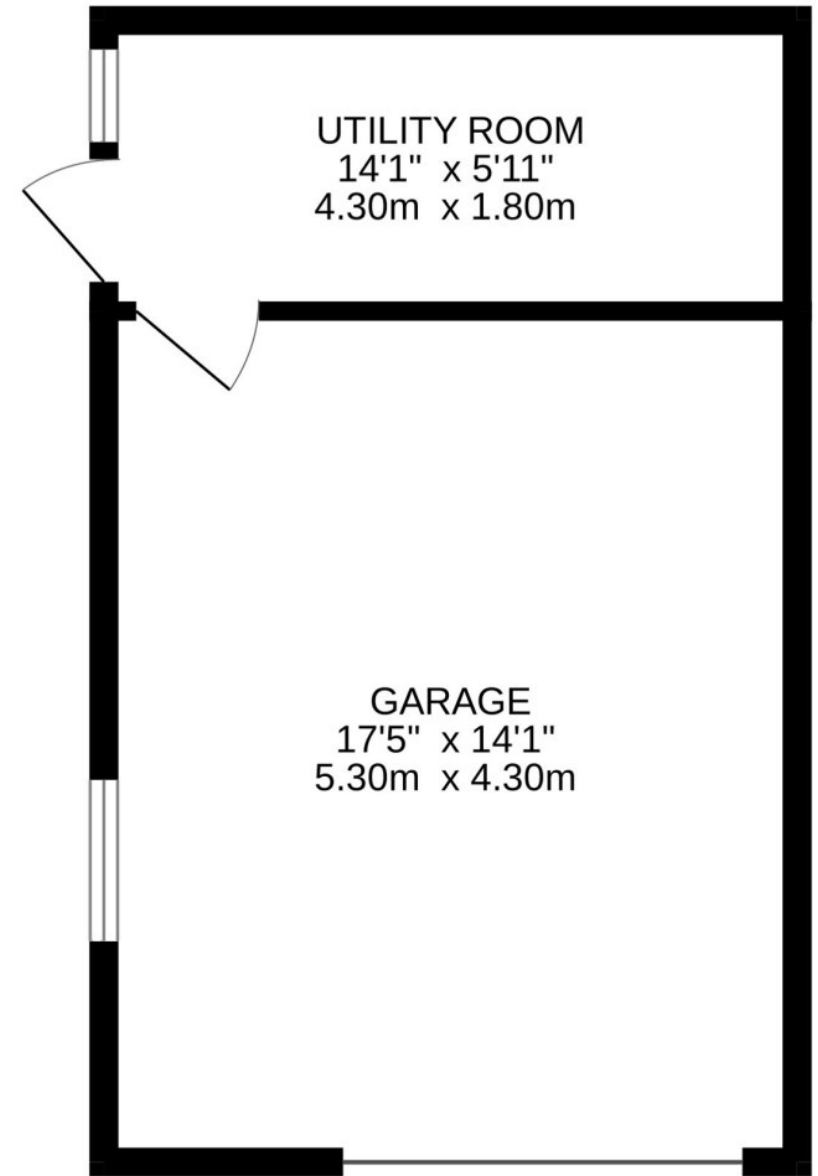
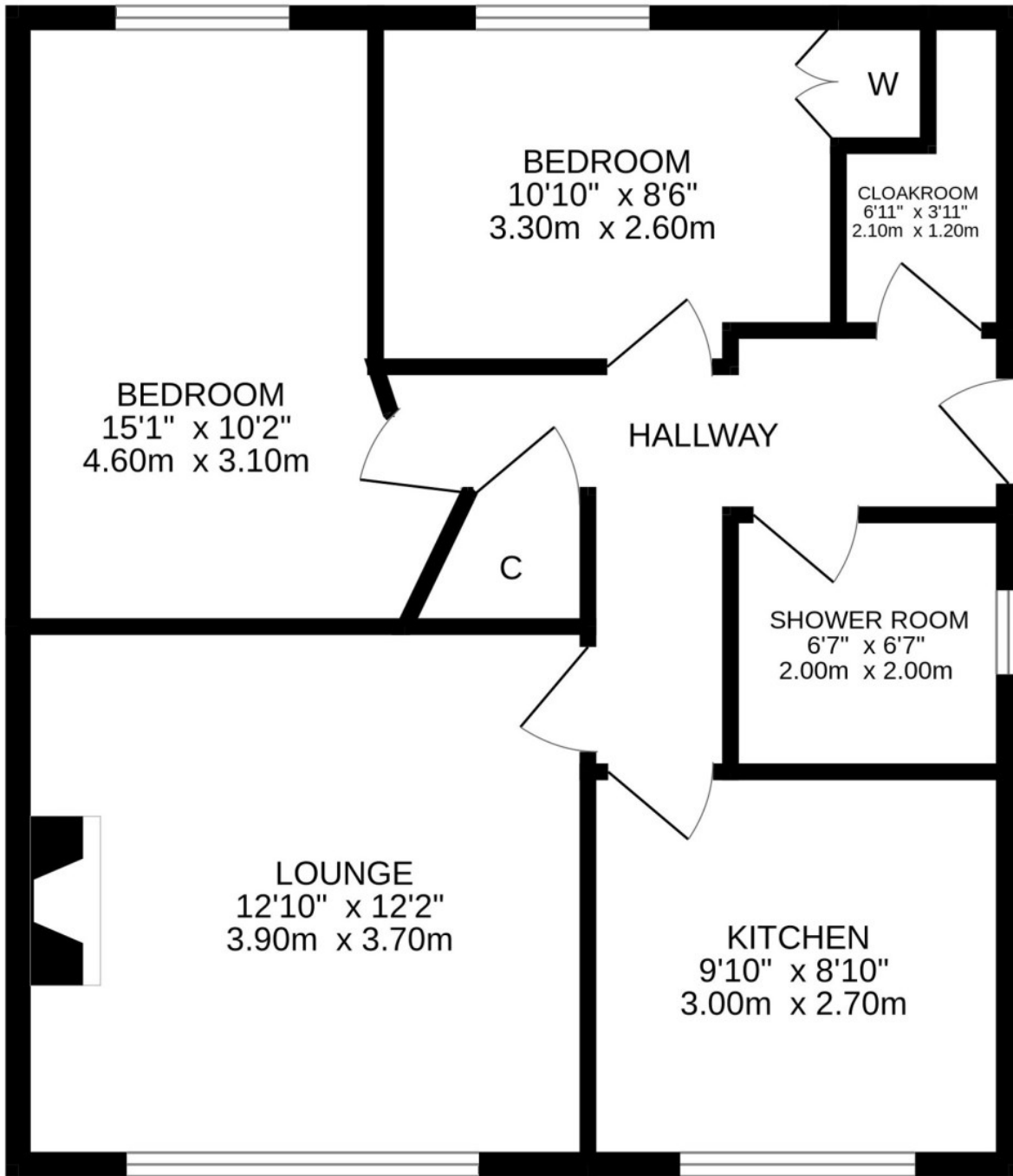

IrvingGeddes
W.S. • Solicitors • Estate Agents

These particulars are believed to be correct, but their accuracy is not guaranteed and they do not form part of any contract. All measurements are approximate only.



Crieff
25 West High Street, PH7 4AU
Tel: 01764 653771

Comrie
1 Drummond Street, PH6 2DW
Tel: 01764 670325

Aberfeldy
6 The Square, PH15 2DD
Tel: 01887 822722