



Yard Head Cottage, Towngate, Bradwell, Hope Valley, S33 9JX

Saxton Mee

Towngate

Bradwell

Auction Guide

£150,000

A Charming Derbyshire Cottage.

Auction Guide Price £150,000 + Fees

****Auction Thursday 25th April 2024 at 9.00am****

This three-bedroom stone-built mid-terrace property is situated in the picturesque Peak District village of Bradwell, known for its tranquil surroundings. The village boasts various shops, amenities, county inns, and a vibrant local community. Additionally, Bradwell offers convenient access to outdoor activities, making it an ideal location for nature enthusiasts.

Although the property requires modernization and cosmetic enhancements, it features gas central heating and double glazing throughout. The layout comprises a fitted kitchen, a ground floor shower room, and a sitting room.

Upstairs, there are three bedrooms, offering ample accommodation space for a family or individuals.

Externally, the property benefits from an enclosed garden, providing a private outdoor space for relaxation or entertainment. Additionally, there is a useful store.

With the added advantage of no upward chain, this property presents an excellent opportunity for those looking to customize and create their ideal home in a desirable Peak District village setting.

<https://www.sdlauctions.co.uk/property/43418/terraced-house-for-auction-hope-valley/>



- Popular Peak District Village
- In Need Of Modernisation & Cosmetic Enhancement
- Excellent Village Amenities
- A Wealth Of Outdoor Pursuits On The Doorstep
- Ideal Main Home Or Holiday Cottage
- Rear Garden & Useful Store
- EPC: D
- Viewings: Hathersage





Yard Head Cottage

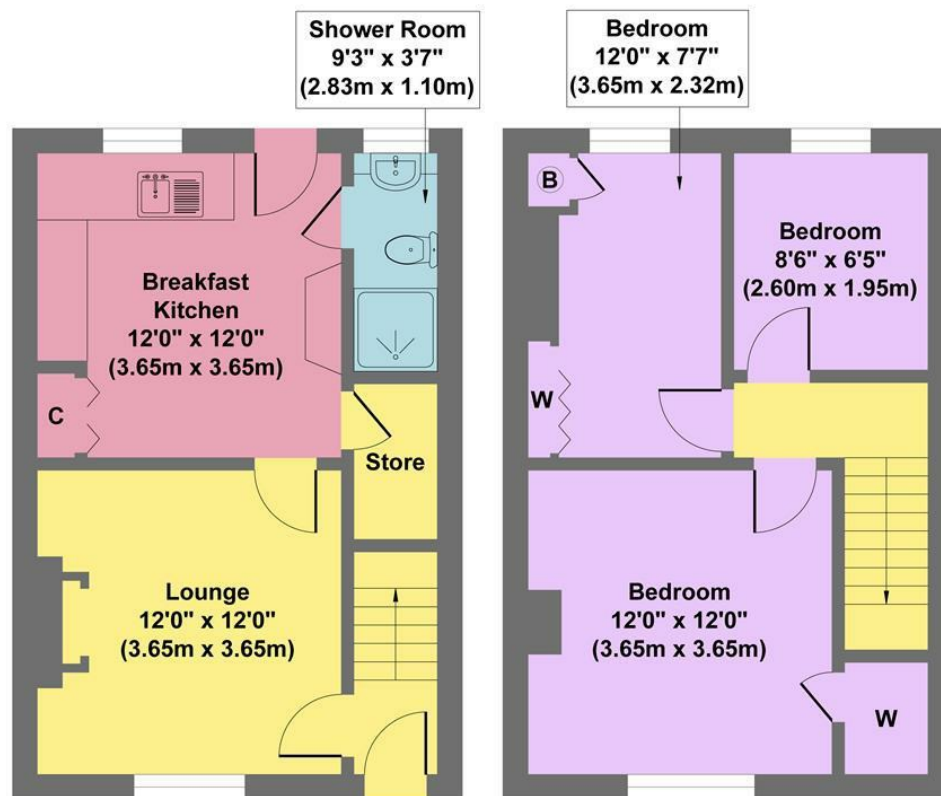

Ground Floor
Approximate Floor Area
385 sq.ft
(35.76 sq.m.)

First Floor
Approximate Floor Area
385 sq.ft
(35.76 sq.m.)

Approx. Gross Internal Floor Area 770 sq.ft / 71.52 sq.m

Illustration for identification purposes only, measurements are approximate, not to scale

While we endeavour to make our sales particulars fair, accurate and reliable, they are only a general guide to the property and, accordingly, if there is any point, which is of particular importance to you, please contact the relevant office. The Agents have not tested any apparatus, equipment, fittings or services and so cannot verify they are in working order. The buyer is advised to obtain verification. Please note all the measurement details are approximate and should not be relied upon as exact. All plans, floor plans and maps are for guidance purposes only and are not to scale. Under no circumstances should they be relied upon as exact or for use in planning carpets and other such fixtures, fittings or furnishings. YOUR HOME IS AT RISK IF YOU DO NOT KEEP UP REPAYMENTS ON A MORTGAGE OR OTHER LOAN SECURED ON IT. 'A Life Assurance policy may be requested.' 'Written Quotations of credit terms available on request.'