



2 Moorbank Drive, Sandygate, Sheffield, S10 5TH



2 Moorbank Drive

Sandygate

Offers Around

£850,000

Slightly elevated from the road, set well back, a strikingly attractive and imposing, tastefully extended, large four bedroom, three bathroom detached family home, on a quiet cul de sac in this very sought after suburb, within walking distance of the open countryside yet close to excellent amenities and first class schools.

Reception lobby, shower/wet room with WC, dining room with French windows to rear terrace and glass and stainless steel staircase to first floor. Large through sitting room, study/gym or potential bedroom five, utility room. Access to large garage. Breakfast kitchen with box bay window and side entrance porch. Additional family room with attractive country views in the distance. First Floor: large landing, master bedroom and very large en suite bathroom. Three further bedrooms and family bathroom. Outside: extensive parking with block paved driveway and large integral garage. Attractive front garden. To the rear, southerly facing terrace and attractive easily maintainable private garden.

Within walking distance of good shopping facilities and excellent schools, close to nearby hospitals, golf courses and easy access of Sheffield universities.



- Large Extended Four Bedroom, Three Bathroom Detached Family Home
- Strikingly Attractive And Imposing Being Slightly Elevated
- Set On A Quiet Cul De Sac And With Lovely Country Views In The Distance
- Tastefully And Substantially Extended, An Internal Inspection Is A Must
- Large Through Sitting Room, Dining Room And Family Room
- Downstairs Shower/Wet Room, Breakfast Kitchen, Utility Room, Gym/Study/Potential Bedroom Five
- Large Master Bedroom Suite With Very Large En Suite Bathroom
- Excellent School Catchment Area And Walking Distance Of First Class Amenities
- EPC Rating D/Council Tax Band F/Freehold
- Viewing Via Banner Cross Office







Ground Floor

Floor area 116.7 m² (1,256 sq.ft.)

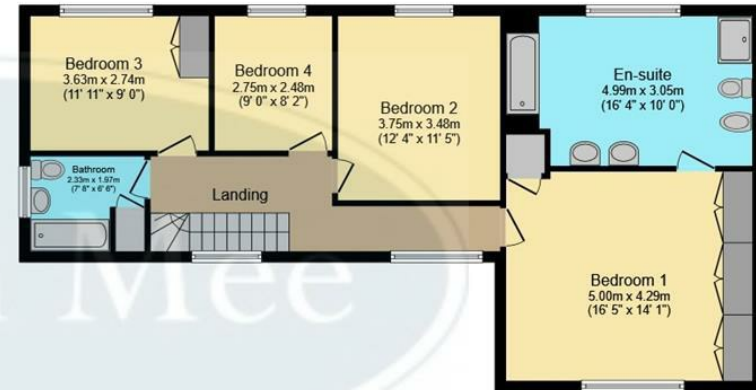

First Floor

Floor area 83.1 m² (894 sq.ft.)

TOTAL: 199.8 m² (2,150 sq.ft.)

This floor plan is for illustrative purposes only. It is not drawn to scale. Any measurements, floor areas (including any total floor area), openings and orientations are approximate. No details are guaranteed, they cannot be relied upon for any purpose and do not form any part of any agreement. No liability is taken for any error, omission or misstatement. A party must rely upon its own inspection(s). Powered by www.Propertybox.io

While we endeavour to make our sales particulars fair, accurate and reliable, they are only a general guide to the property and, accordingly, if there is any point, which is of particular importance to you, please contact the relevant office. The Agents have not tested any apparatus, equipment, fittings or services and so cannot verify they are in working order. The buyer is advised to obtain verification. Please note all the measurement details are approximate and should not be relied upon as exact. All plans, floor plans and maps are for guidance purposes only and are not to scale. Under no circumstances should they be relied upon as exact or for use in planning carpets and other such fixtures, fittings or furnishings. YOUR HOME IS AT RISK IF YOU DO NOT KEEP UP REPAYMENTS ON A MORTGAGE OR OTHER LOAN SECURED ON IT. 'A Life Assurance policy may be requested.' 'Written Quotations of credit terms available on request.'

Banner Cross
T: 0114 268 3241
E: bannercross@saxtonmee.co.uk
www.saxtonmee.co.uk

Hathersage
T: 01433 650009
E: hathersage@saxtonmee.co.uk

Bakewell
T: 01629 815307
E: bakewell@saxtonmee.co.uk

Matlock
T: 01629 828250
E: matlock@saxtonmee.co.uk

