



4 Riverside Apartments 43A Mowbray Street, Sheffield S3 8EP £650 Per Calendar Month

Available to let is this well presented, one bedroom top floor apartment located in the popular central area of Kelham Island. Kelham Island, known for its industrial heritage, has evolved into a trendy, and thriving district, blending historic charm with contemporary flair. With plenty of bars, cafes, and restaurants at your fingertips, as well as proximity to the City Centre.

The accommodation briefly comprises: Communal entrance hallway. Inner hallway with secure intercom entry system. Open plan kitchen and lounge/diner with a range of fitted units, integrated oven and hob with space for a washing machine and fridge/freezer. Modern shower room with shower enclosure, wash basin and W.C. Double bedroom with sliding internal doors. Outside there is a private terrace with a delightful outlook over the River Don.

PART FURNISHED 6 MONTH TENANCY INITIAL TENANCY. Restrictions: No smokers, no pets. Energy Efficiency Rating D Council Tax Band B

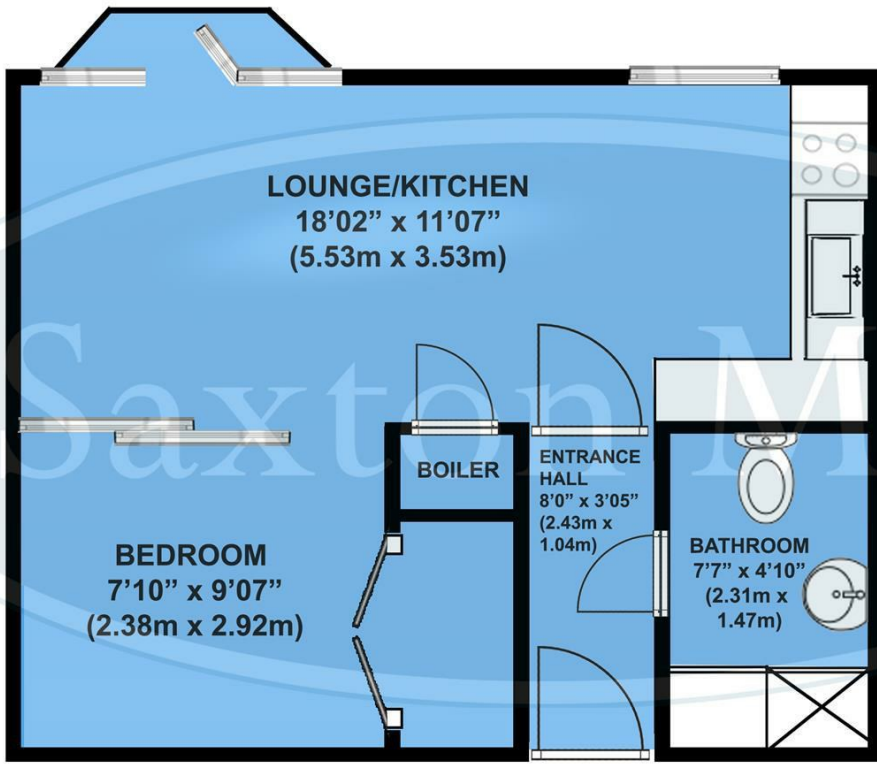

Total area: approx. 350.13 sq. feet (32.56 sq metres)
All measurements are approximate

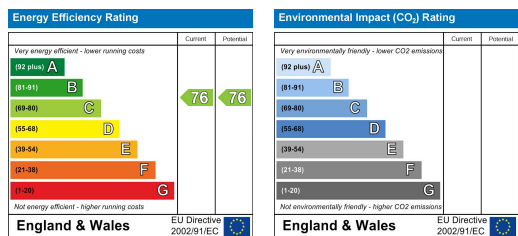

Banner Cross
Hathersage
Bakewell
Matlock
www.saxtonmee.co.uk

949-951 Ecclesall Road, Sheffield S11 8TN
3 Bank View, Main Road, Hathersage S32 1BB
Matlock Street, Bakewell DE45 1EE
27 Causeway Lane, Matlock, DE4 3AR

T: 0114 268 3241
T: 01433 650009
T: 01629 815307
T: 01629 828250

E: bannercross@saxtonmee.co.uk
E: hathersage@saxtonmee.co.uk
E: bakewell@saxtonmee.co.uk
E: matlock@saxtonmee.co.uk

While we endeavour to make our sales particulars fair, accurate and reliable, they are only a general guide to the property and, accordingly, if there is any point, which is of particular importance to you, please contact the relevant office. The Agents have not tested any apparatus, equipment, fittings or services and so cannot verify they are in working order. The buyer is advised to obtain verification. Please note all the measurement details are approximate and should not be relied upon as exact. All plans, floor plans and maps are for guidance purposes only and are not to scale. Under no circumstances should they be relied upon as exact or for use in planning carpets and other such fixtures, fittings or furnishings. YOUR HOME IS AT RISK IF YOU DO NOT KEEP UP REPAYMENTS ON A MORTGAGE OR OTHER LOAN SECURED ON IT. 'A Life Assurance policy may be requested.' 'Written Quotations of credit terms available on request.'