



469 Greystones Road, Greystones, Sheffield, S11 7BY





# 469 Greystones Road

## Greystones

Offers Around

# £650,000

A stunning five bedroom, two bathroom, detached family home offering period features, beautiful views and situated in the catchment area for excellent schools, Easy access of all local amenities at Greystones, Bents Green and Nether Green and also the vibrant Ecclesall Road area is close by. Walks are on the doorstep to the beautiful countryside of Bingham Park, Whiteley Woods and the Porter Brook trail leading to the popular Forge Dam.

This lovely property briefly comprises; superb entrance hallway with steps leading down to the great size garage beneath, lounge with bay window and feature fireplace, open plan dining kitchen with a range of base drawer and wall units, integrated appliances, ample space for a good size family dining suite and a gas stove. To the first floor is a single bedroom, currently with fitted wardrobes and used as a dressing room, two further good size double bedrooms and a family bathroom with bath and shower above. To the second floor there are two further bedrooms, each with French doors and Juliet balconies overlooking the rear garden and a separate shower room.

To the front of the property there is a driveway providing access to the integral garage with electric door. To the rear of the property is a tiered garden with various levels incorporating a lovely patio area, lawn and raised vegetable beds.

An internal inspection is highly recommended if you are a fan of beautiful period homes in a highly regarded area.



- Five Bedroom/Two Bathroom Detached Property
- Period Features Throughout
- Fantastic Views And Close to Lovely Countryside Walks
- Three Double Bedrooms, Two Single Bedrooms
- Family Bathroom and Family Shower Room
- French Doors To Rear Patio And Tiered Garden
- Catchment Area For Excellent Schools
- Driveway Plus Integral Garage With Electric Door
- Council Tax Band E/EPC Rating D/Freehold
- Viewings Via Banner Cross Branch

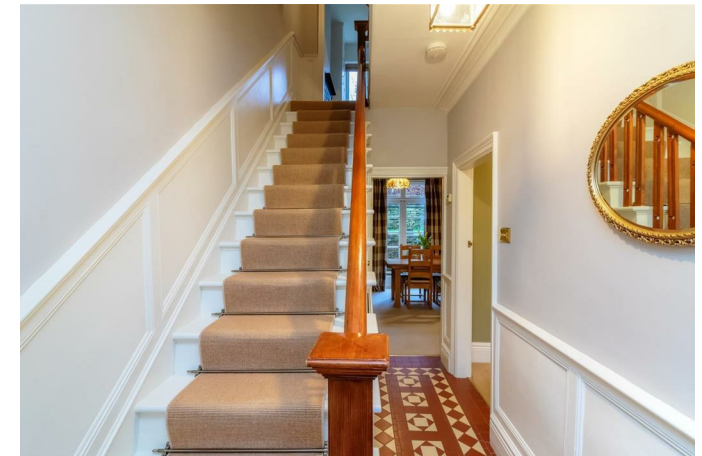







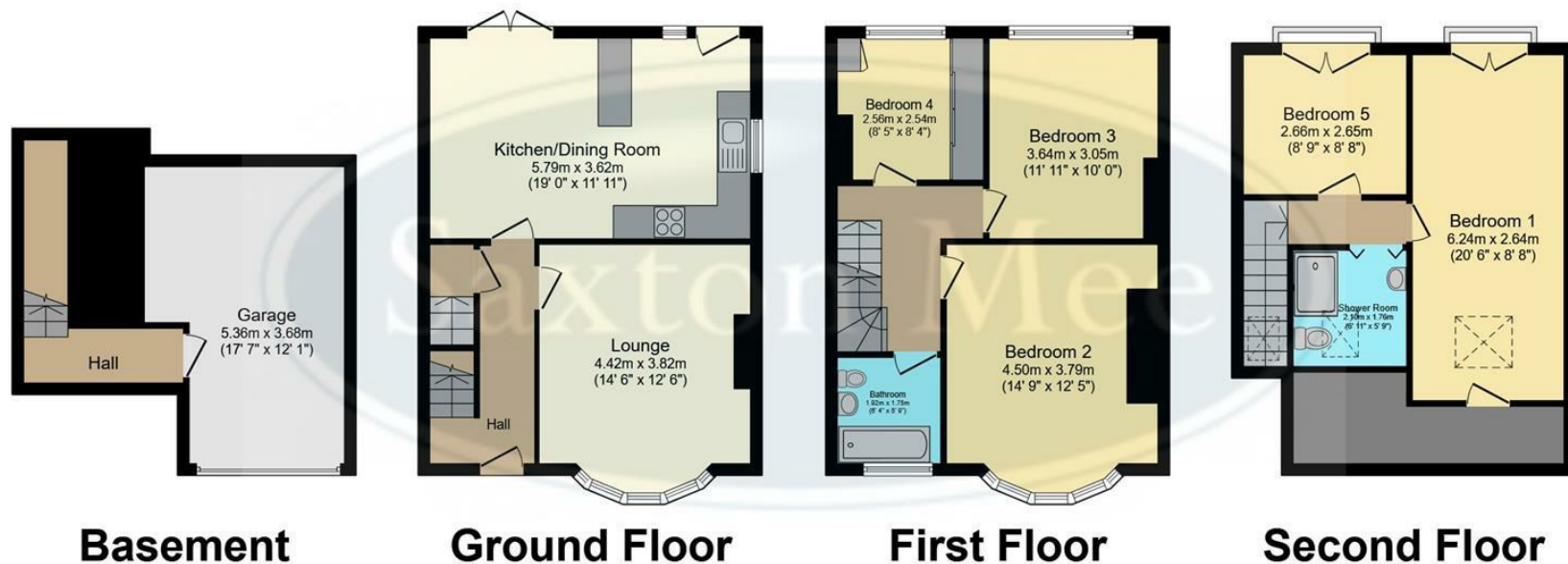

Total floor area 152.9 sq.m. (1,646 sq.ft.) approx

This plan is for illustration purposes only and may not be representative of the property. Plan not to scale. Powered by PropertyBox

While we endeavour to make our sales particulars fair, accurate and reliable, they are only a general guide to the property and, accordingly, if there is any point, which is of particular importance to you, please contact the relevant office. The Agents have not tested any apparatus, equipment, fittings or services and so cannot verify they are in working order. The buyer is advised to obtain verification. Please note all the measurement details are approximate and should not be relied upon as exact. All plans, floor plans and maps are for guidance purposes only and are not to scale. Under no circumstances should they be relied upon as exact or for use in planning carpets and other such fixtures, fittings or furnishings. YOUR HOME IS AT RISK IF YOU DO NOT KEEP UP REPAYMENTS ON A MORTGAGE OR OTHER LOAN SECURED ON IT. 'A Life Assurance policy may be requested.' 'Written Quotations of credit terms available on request.'

Banner Cross  
T: 0114 268 3241  
E: [bannercross@saxtonmee.co.uk](mailto:bannercross@saxtonmee.co.uk)  
[www.saxtonmee.co.uk](http://www.saxtonmee.co.uk)

Hathersage  
T: 01433 650009  
E: [hathersage@saxtonmee.co.uk](mailto:hathersage@saxtonmee.co.uk)

Bakewell  
T: 01629 815307  
E: [bakewell@saxtonmee.co.uk](mailto:bakewell@saxtonmee.co.uk)

Matlock  
T: 01629 828250  
E: [matlock@saxtonmee.co.uk](mailto:matlock@saxtonmee.co.uk)

