



1 Hillmorton, The Dukes Drive, Ashford-In-The-Water, Derbyshire, DE45



The Dukes Drive

Ashford-In-The-Water

Offers In The Region Of

£300,000

Charming Cottage With Generous Parking, Garage & Store

A delightful three bedroom end terrace cottage with driveway, garage and parking to the rear. Occupying an enviable and picturesque position with views towards woodland and the adjoining farmland.

Set on the edge of Ashford In The Water, close to a range of local shops, amenities and country inns. Surrounded by stunning Derbyshire countryside with easy access to the Monsal Trail, local walks, the Chatsworth Country Estate and Haddon Hall is close by. Within easy commutable distance of Sheffield and Chesterfield, the historic market of Bakewell offers excellent facilities and highly regarded school catchment.

The property is ideally suited as main home or holiday cottage.

The generous accommodation comprises: open plan kitchen living/dining area to the ground floor with a central, double sided open fire.

First floor: three bedrooms and a bathroom.

Exterior: with vehicular access to the rear, leading to the garage and off road parking. A rear garden and additional store.

No Upward Chain.

- No Upward Chain
- Double Garage & Generous Off Road Parking
- Enviaible Picturesque Peak Park Setting
- Rear Garden With Views Towards Woodland & Countryside
- Easy Reach Of An Excellent Range Of Amenities
- Ideal Main Home Or Holiday Cottage
- Lady Manners School Catchment
- Gas Central Heating & Double Glazing Throughout
- EPC: TBC
- Viewings: Bakewell





1 Hillmorton

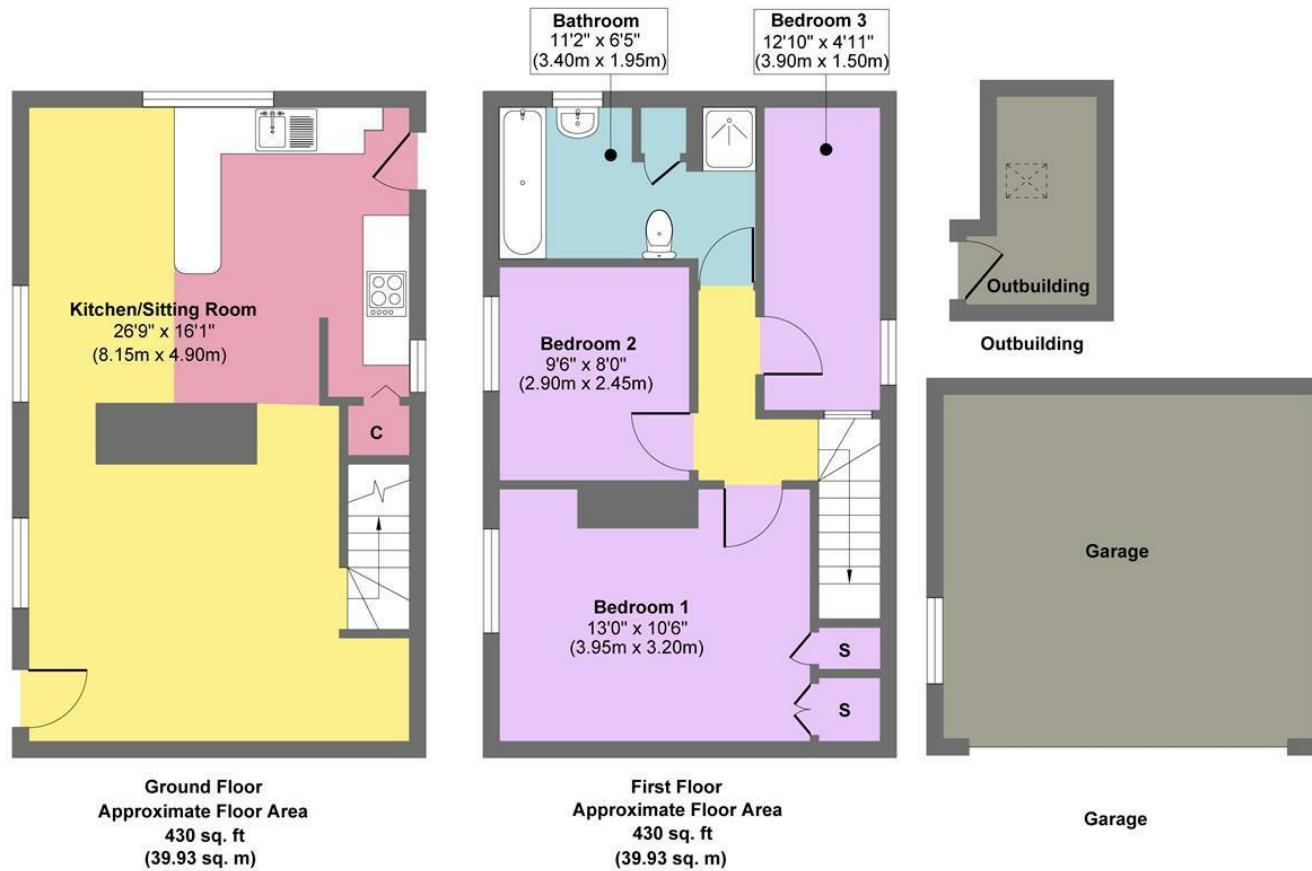

Approx. Gross Internal Floor Area 859 sq. ft / 79.87 sq. m

Illustration for identification purposes only, measurements are approximate, not to scale.
Produced by Elements Property

While we endeavour to make our sales particulars fair, accurate and reliable, they are only a general guide to the property and, accordingly, if there is any point, which is of particular importance to you, please contact the relevant office. The Agents have not tested any apparatus, equipment, fittings or services and so cannot verify they are in working order. The buyer is advised to obtain verification. Please note all the measurement details are approximate and should not be relied upon as exact. All plans, floor plans and maps are for guidance purposes only and are not to scale. Under no circumstances should they be relied upon as exact or for use in planning carpets and other such fixtures, fittings or furnishings. YOUR HOME IS AT RISK IF YOU DO NOT KEEP UP REPAYMENTS ON A MORTGAGE OR OTHER LOAN SECURED ON IT. 'A Life Assurance policy may be requested.' 'Written Quotations of credit terms available on request.'

Banner Cross
T: 0114 268 3241
E: bannercross@saxtonmee.co.uk
www.saxtonmee.co.uk

Hathersage
T: 01433 650009
E: hathersage@saxtonmee.co.uk

Bakewell
T: 01629 815307
E: bakewell@saxtonmee.co.uk

Matlock
T: 01629 828250
E: matlock@saxtonmee.co.uk

