



FOR SALE

£265,000

88 Eastfield Road,
Southsea, PO4 9EN.

Tenure: Freehold

ESTATE  AGENTS

LAWSON ROSE

PROPERTY DESCRIPTION

Stylish, modern & well presented throughout, this two bedroom, bay & forecourt property in the popular Eastfield Road has a multitude of benefits and could make for an ideal first time or family home. The accommodation provides a bright airy living room with a stunning, contemporary open plan kitchen/ dining area & a separate utility area on the ground floor. The first floor then provides two great sized double bedrooms, the master of which has an array of built in wardrobes, plus there is a sizeable modern four piece bathroom suite. Additionally the home is double glazed and gas centrally heated, plus outside is a low maintenance, enclosed rear garden. We highly recommend an internal viewing to appreciate all the home is to offer, so for further information or to arrange an internal viewing, please contact the Lawson Rose sales office today.

Material Information:

- Construction: Brick Built
- Electricity Supply: Alternating Current
- Heating: Gas Central Heating
- Water Supply: Mains Water Supply
- Sewage: Mains Sewage
- Broadband: Standard, Superfast Fibre and Gfast Fibre are available.
- Mobile: Ofcom Checker shows EE, Three, O2 and Vodafone all have voice and data availability in this area.
- Permit Parking: 1st permit is £30, 2nd permit is £120 and 3rd permit (where available) is £300.
- Council Tax: Portsmouth City Council – Band B
- Flood Risk – Low Risk (Stated on the Gov.uk portal)



02392 367 779 - contactus@lawsonrose.com

131 Winter Road, Southsea, P04 8DS





GROUND FLOOR

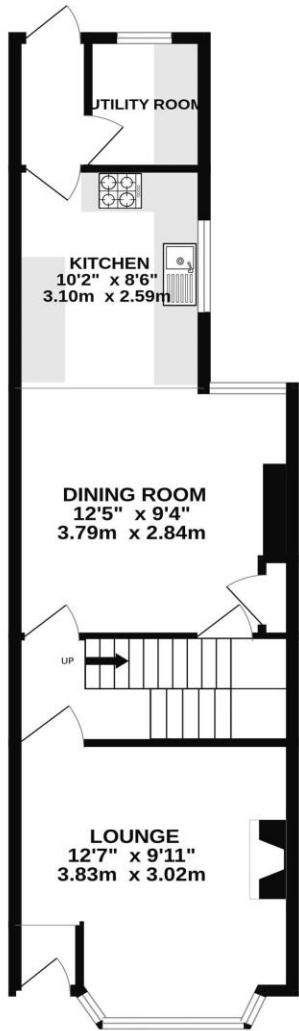

1ST FLOOR

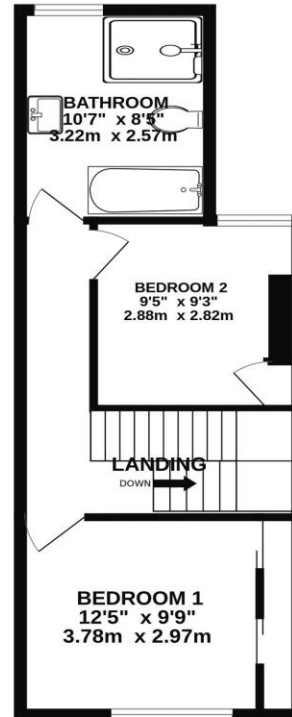

Please note that none of the services or appliances have been tested by Lawson Rose Estate Agents.