



# FOR SALE

## £250,000

25 Owen Street,  
Southsea, PO4 9PB.

Tenure: Freehold

ESTATE  AGENTS

# LAWSON ROSE

## PROPERTY DESCRIPTION

This stylish two bedroom, mid terrace property in the popular 'Eastney Village' has recently been updated and modernised, plus its being offered with no forward chain! Situated in the popular Owen Street, not far from the seafront & promenade, the property could make for an ideal first time or family home in our opinion, providing a spacious, bright and airy open plan living room with dual aspect windows. Plus a contemporary fitted kitchen that overlooks the enclosed 20FT rear garden. The first floor then provides a modern fitted bathroom suite and two good sized double bedrooms. The home is double glazed and gas centrally heated throughout, and given the space and location of the property, we anticipate a strong level of interest. For further information or to arrange a time to view, please contact the Lawson Rose sales office today.

### Material Information:

- Construction: Brick Built
- Electricity Supply: Alternating Current
- Heating: Gas Central Heating
- Water Supply: Mains Water Supply
- Sewage: Mains Sewage
- Broadband: Standard, Superfast Fibre and Gfast Fibre are available.
- Mobile: Ofcom Checker shows EE, Three, O2 and Vodafone all have voice and data availability in this area.
- Permit Parking: 1<sup>st</sup> permit is £30, 2<sup>nd</sup> permit is £120 and 3<sup>rd</sup> permit (where available) is £300.
- Council Tax: Portsmouth City Council – Band B
- Flood Risk – Low Risk (Stated on the Gov.uk portal)



**02392 367 779 - [contactus@lawsonrose.com](mailto:contactus@lawsonrose.com)**  
**131 Winter Road, Southsea, P04 8DS**









GROUND FLOOR

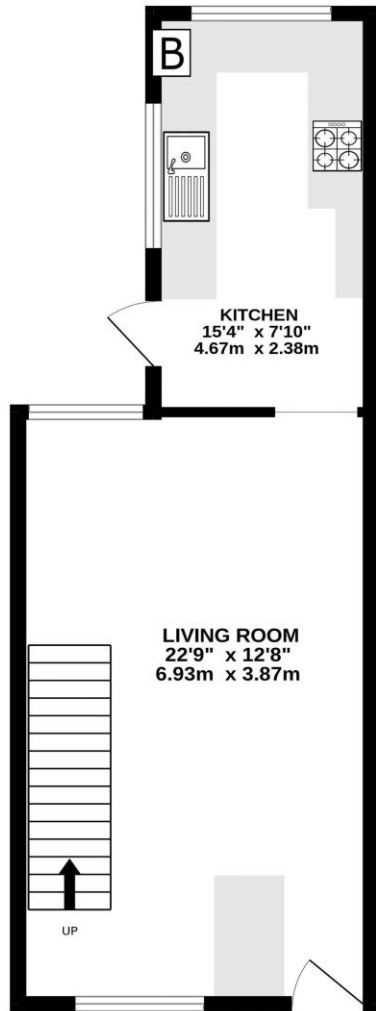

1ST FLOOR

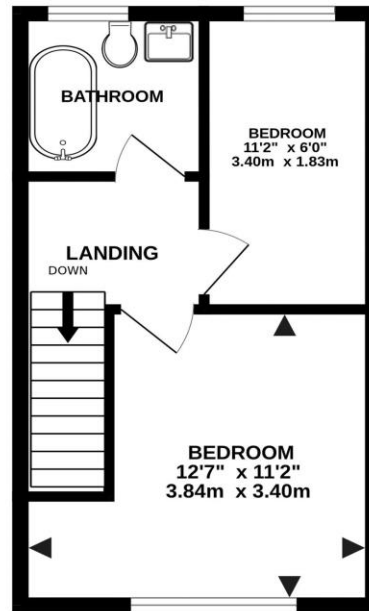

Score	Energy rating	Current	Potential
92+	A		
81-91	B		89 B
69-80	C	70 C	
55-68	D		
39-54	E		
21-38	F		
1-20	G		

Please note that none of the services or appliances have been tested by Lawson Rose Estate Agents.

Whilst every attempt has been made to ensure the accuracy of the floorplan contained here, measurements of doors, windows, rooms and any other items are approximate and no responsibility is taken for any error, omission or mis-statement. This plan is for illustrative purposes only and should be used as such by any prospective purchaser. The services, systems and appliances shown have not been tested and no guarantee as to their operability or efficiency can be given.  
Made with Metropix ©2024