



**FOR SALE**

**£230,000**

61 Londesborough Road,  
Southsea, PO4 0EU.

Tenure: Freehold

ESTATE  AGENTS

**LAWSON  
ROSE**

## PROPERTY DESCRIPTION

This two bedroom, terraced property in the popular Londesborough Road is being offered with no forward chain! Potentially an ideal first time or investment purchase, the property provides two separate reception rooms alongside a fitted kitchen and downstairs bathroom suite. The first floor then provides two great sized double bedrooms, both of which have a built in wardrobes. Additionally the home is double glazed and gas centrally heated, plus there is the benefit of a 26ft rear west facing garden. Property of this style and tenure are in good demand, therefore we suggest arranging an internal viewing at the earliest opportunity. All enquires, please contact the Lawson Rose sales office today.

### Material Information:

- Construction: Brick built
- Electricity Supply: Alternating Current
- Heating: Gas central Heating
- Water Supply: Mains water supply
- Sewage: Mains sewage
- Broadband: Standard, Superfast Fibre and Gfast fibre are available.
- Mobile: Ofcom Checker shows EE, Three, O2 and Vodafone all have voice and data availability in this area.
- Permit Parking: 1<sup>st</sup> permit is £30, 2<sup>nd</sup> permit is £120 and 3<sup>rd</sup> permit (where available) is £300.
- Council Tax: Portsmouth City Council – Band B
- Flood Risk – Low Risk (Stated on the Gov.uk portal)



**02392 367 779 - [contactus@lawsonrose.com](mailto:contactus@lawsonrose.com)**  
**131 Winter Road, Southsea, P04 8DS**





GROUND FLOOR

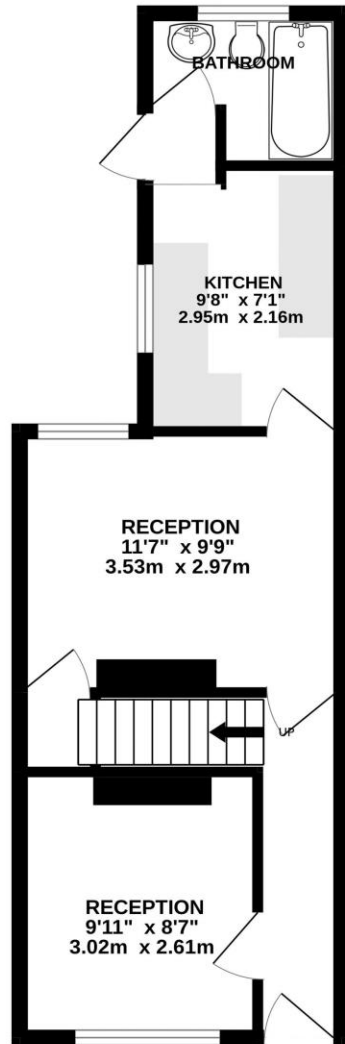

1ST FLOOR

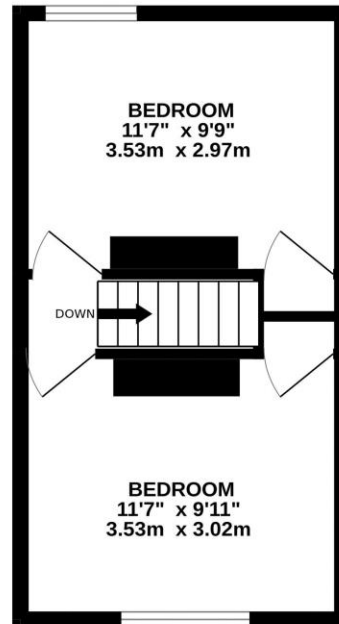

Please note that none of the services or appliances have been tested by Lawson Rose Estate Agents.