



ESTATE AGENTS
**LAWSON
ROSE**

FOR SALE

£350,000

Flat 9, Tudor Rose Court South Parade,
Southsea, PO4 0DE.

ESTATE  AGENTS

**LAWSON
ROSE**

Tudor Rose Court, South Parade, Southsea

Approximate Gross Internal Area = 86.9 sq m / 936 sq ft

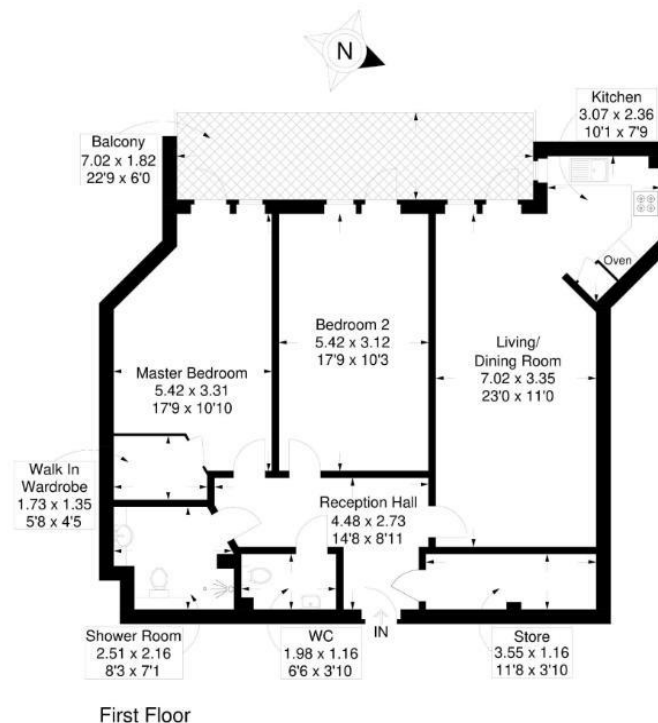

This plan is for layout guidance only. Not drawn to scale unless stated. Windows and door openings are approximate. Whilst every care is taken in the preparation of this plan, please check all dimensions, shapes and compass bearings before making any decisions reliant upon them.

Lawson Rose are delighted to offer this stunning retirement apartment located in a highly desirable, Tudor Rose Court, Southsea. This spacious apartment offers a large open plan living/ kitchen area with access onto a private balcony with sea views. There is a large storage cupboard, two double bedrooms, the master of which has its own walk-in wardrobe, plus a modern shower room & separate W/C. Tudor Rose Court offers all of what one would expect from an award-winning retirement home, including lift/ wheelchair access, emergency call system and on-site management, plus a stunning residents lounge and 'bistro restaurant'. Additionally, the property is being offered with no forward chain! We highly recommend an internal viewing to appreciate all that's on offer, so for further information or to arrange the viewing, please contact the Lawson Rose sales team on 02392 367779.

Services

Electricity, mains water and mains drainage are available. Please note that none of the services or appliances have been tested by Lawson Rose.

Council Tax - Band D

Tenure - Leasehold

Management: McCarthy Stone

Lease Length: 999 Years with 993 Remaining

Ground Rent: £510 P/A

Management/ Service Charge: £886.91



