



**FOR SALE**

**£220,000**

2 Malta Road,  
Portsmouth, PO2 7PZ.

ESTATE AGENTS  
**LAWSON  
ROSE**

ESTATE  AGENTS

**LAWSON  
ROSE**

GROUND FLOOR

1ST FLOOR

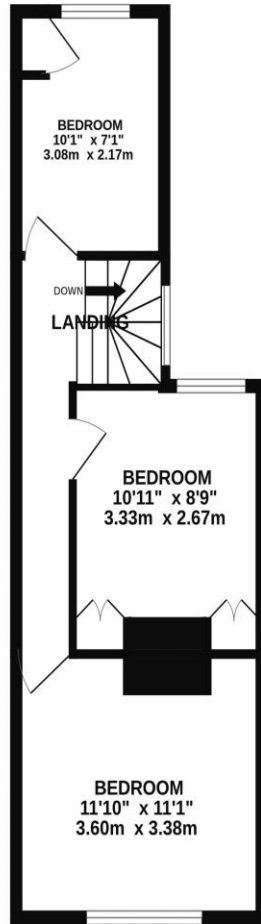
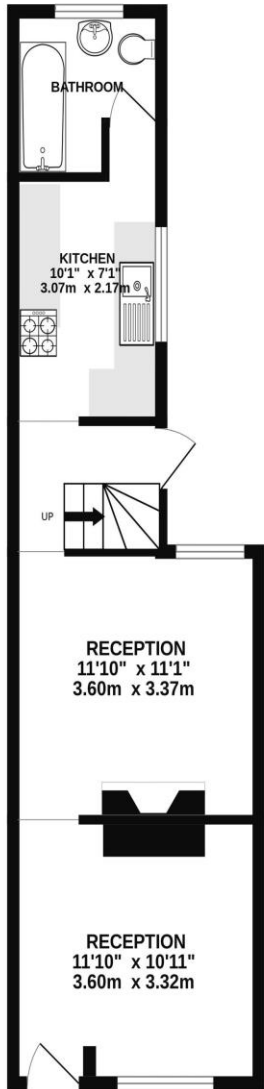

Score	Energy rating	Current	Potential
92+	A		
81-91	B		85 B
69-80	C	69 C	
55-68	D		
39-54	E		
21-38	F		
1-20	G		

Whilst every attempt has been made to ensure the accuracy of the floorplan contained here, measurements of doors, windows, rooms and any other items are approximate and no responsibility is taken for any error, omission or mis-statement. This plan is for illustrative purposes only and should be used as such by any prospective purchaser. The services, systems and appliances shown have not been tested and no guarantee as to their operability or efficiency can be given.  
Made with Metropix ©2023

**£220,000**

**2 Malta Road,  
Portsmouth**

Lawson Ros are delighted to bring to the market the market this three bedroom, end of terrace property located in Malta Road. Potentially an ideal first time or investment purchase in our opinion, the property provides two separate, good sized reception rooms, a fitted kitchen and downstairs bathroom suite. The first floor then three great sized double bedrooms. Additionally the home is double glazed and gas centrally heated throughout, whilst outside there is a rear 30FT enclosed south facing garden. We highly recommend an internal viewing, so for further information or to enquire on viewing arrangements, please contact the Lawson Rose sales office on 02392 367779.

**Services**

Electricity, gas, mains water and mains drainage are available. Please note that none of the services or appliances have been tested by Lawson Rose.

**Council Tax - Band B**



**02392 367 779 - [contactus@lawsonrose.com](mailto:contactus@lawsonrose.com)**

**131 Winter Road, Southsea, P04 8DS**



