



ESTATE AGENTS
**LAWSON
ROSE**

FOR SALE

£330,000

313 Powerscourt Road,
Portsmouth, PO2 7JL.

ESTATE  AGENTS

**LAWSON
ROSE**

GROUND FLOOR

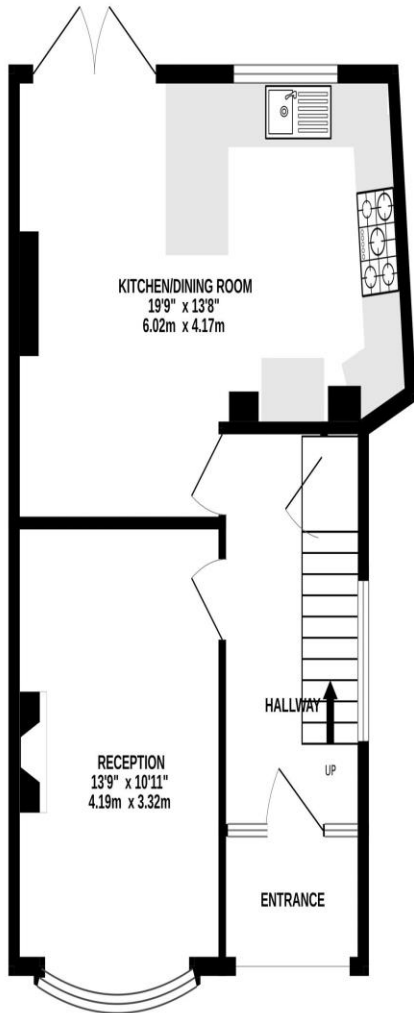

1ST FLOOR

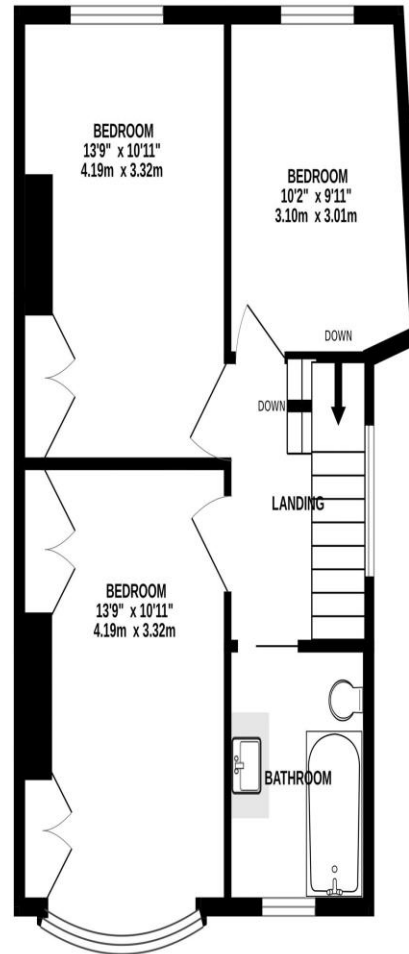

£330,000

313 Powerscourt Road, Portsmouth

Off road parking & a garage! Situated on Powerscourt Road, this well presented, double bay & forecourt property has a multitude of benefits and could make for the ideal family home. Upon entering, off the impressive hallway is a spacious living room with large bay window, plus a beautifully presented, light and airy kitchen/dining area with double doors opening into the rear garden. The first floor then provides three good sized double bedrooms, two of which have an array of built in wardrobes, plus a fitted family bathroom suite. Additionally the house is double glazed and gas centrally heated, there is rear pedestrian access to the garden, plus the garage accessed via a private shared drive to the properties rear. We highly recommend an internal viewing to appreciate all the property has to offer, so for further information or to arrange a time to view, please contact the Lawson Rose sales team today.

Services

Electricity, gas, mains water and mains drainage are available. Please note that none of the services or appliances have been tested by Lawson Rose.

Council Tax - Band C



02392 367 779 - contactus@lawsonrose.com

131 Winter Road, Southsea, P04 8DS

Whilst every attempt has been made to ensure the accuracy of the floorplan contained here, measurement of doors, windows, rooms and any other items are approximate and no responsibility is taken for any omission or mis-statement. This plan is for illustrative purposes only and should be used as such by the prospective purchaser. The services, systems and appliances shown have not been tested and no guarantee as to their operability or efficiency can be given.
Made with Metropix ©2023



