



Approx. 3.5 Acres Land Part of Pensarnddu Uchaf, Tanygroes, Cardigan, SA43 2JT

£80,000

Approximately 3.5 Acres of Land
Situated with Access from the B4333
Between Tanygroes and Beulah

Description

Approximately 3.5 acres of land, situated with access from the B4333, between Tanygroes and Beulah, as indicated on the Location Plan provided.

Location Plan

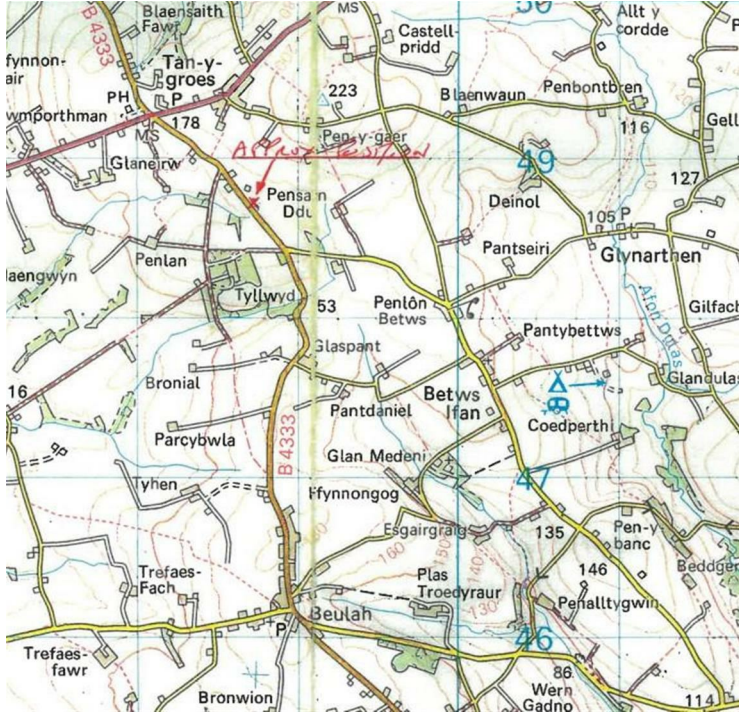

what3words:- ///firebird.giggle.puzzled

Tenure

Freehold and with Full Vacant Possession

Local Authority

Ceredigion County Council

Viewing

Please contact the Sole Agents to register your interest before inspecting.

Floor Plan

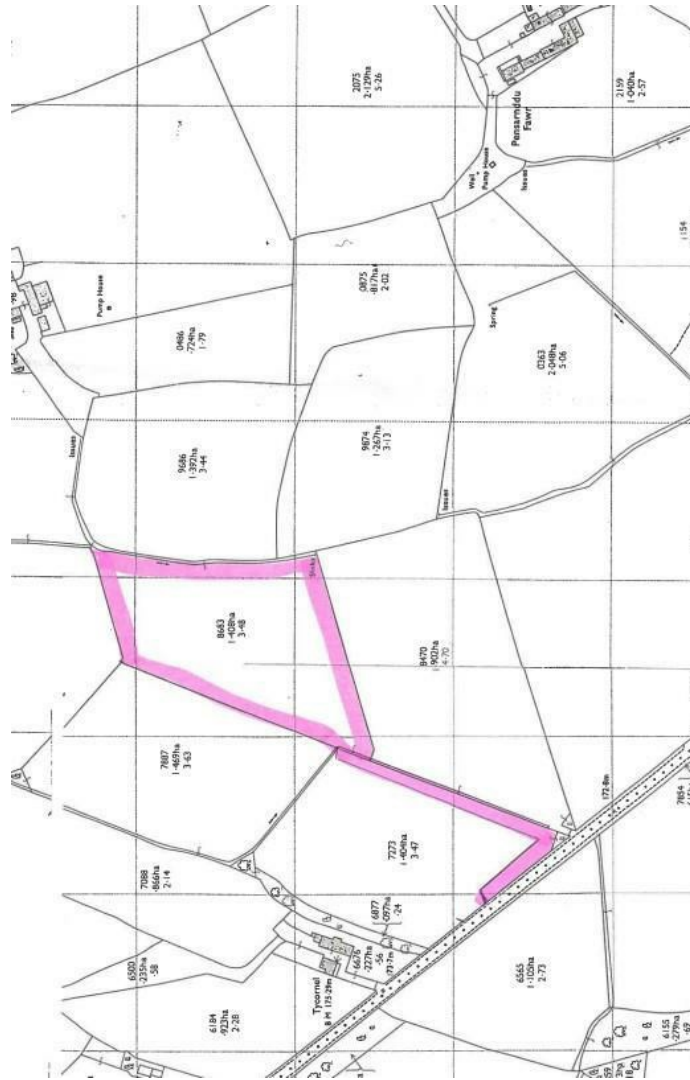

Area Map

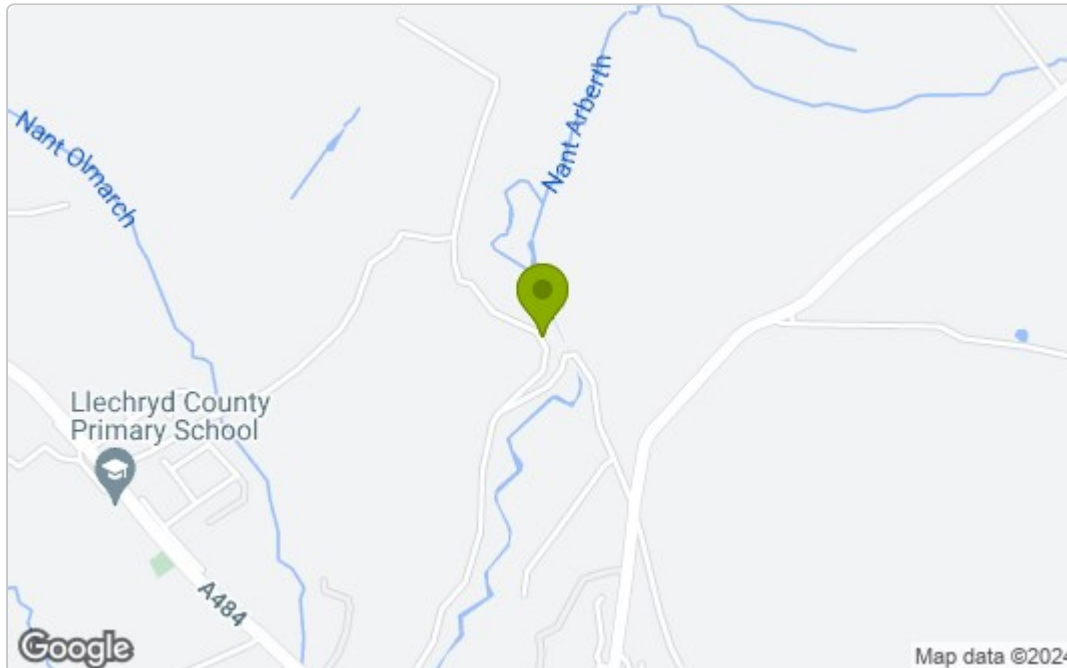

Energy Efficiency Graph

Energy Efficiency Rating		Current	Potential
Very energy efficient - lower running costs			
(92 plus) A			
(81-91) B			
(69-80) C			
(55-68) D			
(39-54) E			
(21-38) F			
(1-20) G			
Not energy efficient - higher running costs			
England & Wales		EU Directive 2002/91/EC	

These particulars, whilst believed to be accurate are set out as a general outline only for guidance and do not constitute any part of an offer or contract. Intending purchasers should not rely on them as statements of representation of fact, but must satisfy themselves by inspection or otherwise as to their accuracy. No person in this firm's employment has the authority to make or give any representation or warranty in respect of the property.

5 High Street, Cardigan,
Ceredigion, SA43 1HJ
T: 01239 612 343
E: cardigan@jjmorris.com

21 West Street, Fishguard
Pembrokeshire, SA65 9AL
T: 01348 873 836
E: fishguard@jjmorris.com

4 Picton Place, Haverfordwest
Pembrokeshire, SA61 2LX
T: 01437 760 440
E: haverfordwest@jjmorris.com

Hill House, Narberth,
Pembrokeshire, SA67 7AR
T: 01834 860 260
E: narberth@jjmorris.com