

bothams ¹⁸⁷¹



38 Cutthorpe Road
Cutthorpe, Chesterfield, S42 7AE
Guide Price £475,000



38 Cutthorpe Road

Cutthorpe, Chesterfield, S42 7AE

+++GUIDE PRICE £475,000 - £499,950+++

An immaculately presented and well proportioned four bedroom detached house having a double length garage, off road parking and fantastic views to the rear over open countryside. The property is located within easy reach to the Peak District National Park and well placed for Chesterfield Town Centre and local amenities.

Key information





Floor Plan

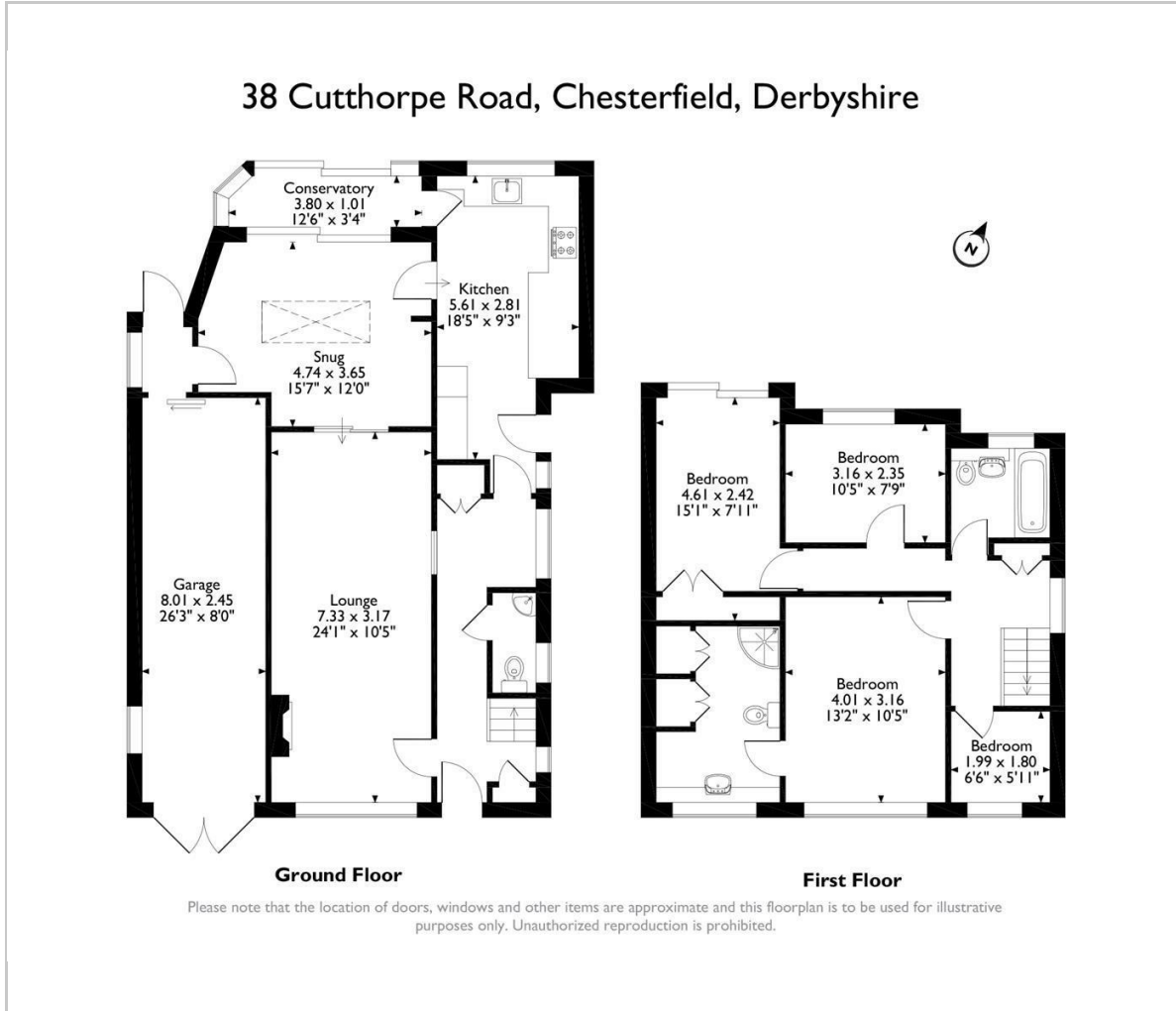

Viewing

Please contact our Chesterfield Residential Office on 01246 233121 if you wish to arrange a viewing appointment for this property or require further information.

These particulars, whilst believed to be accurate are set out as a general outline only for guidance and do not constitute any part of an offer or contract. Intending purchasers should not rely on them as statements of representation of fact, but must satisfy themselves by inspection or otherwise as to their accuracy. No person in this firm's employment has the authority to make or give any representation or warranty in respect of the property.

Ravenside House 46 Park Road, Chesterfield, Derbyshire, S40 1XZ
 Tel: 01246 233121 Email: enquiries@bothams.co.uk <https://www.bothams.co.uk/>

Area Map



Energy Efficiency Graph

