

DURDEN & HUNT

INTERNATIONAL



Colebrook Lane, Loughton IG10

£1,075 PCM

- One Bedroom
- Open Plan Kitchen/Diner
- Fully Refurbished
- Off Street Parking
- Close To Local Amenities
- Close To Local Schools
- Modern Bathroom
- Close To Central Line Station
- Ready to Move Into mid August

309 High Road, Loughton, Essex, IG10 1AL
01277282222

lettings@durdenandhunt.co.uk
<https://www.durdenandhunt.co.uk/>

Colebrook Road
 Approx. Gross Internal Area 385 Sq Ft - 35.77 Sq M

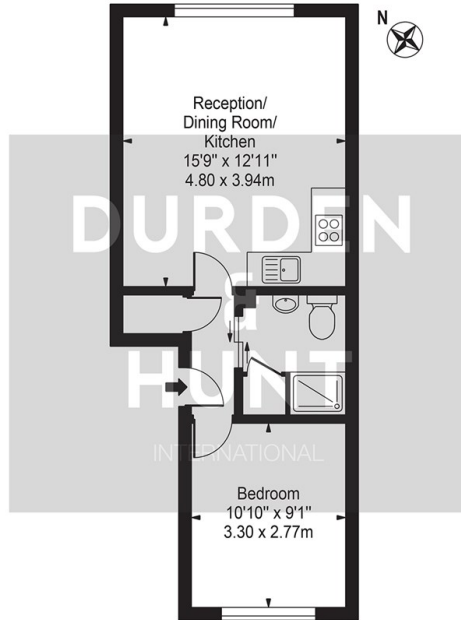

First Floor

For Illustration Purposes Only - Not To Scale

This floor plan should be used as a general outline for guidance only and does not constitute in whole or in part an offer or contract. Any intending purchaser or lessee should satisfy themselves by inspection, searches, enquiries and full survey as to the correctness of each statement. Any areas, measurements or distances quoted are approximate and should not be used to value a property or be the basis of any sale or let.

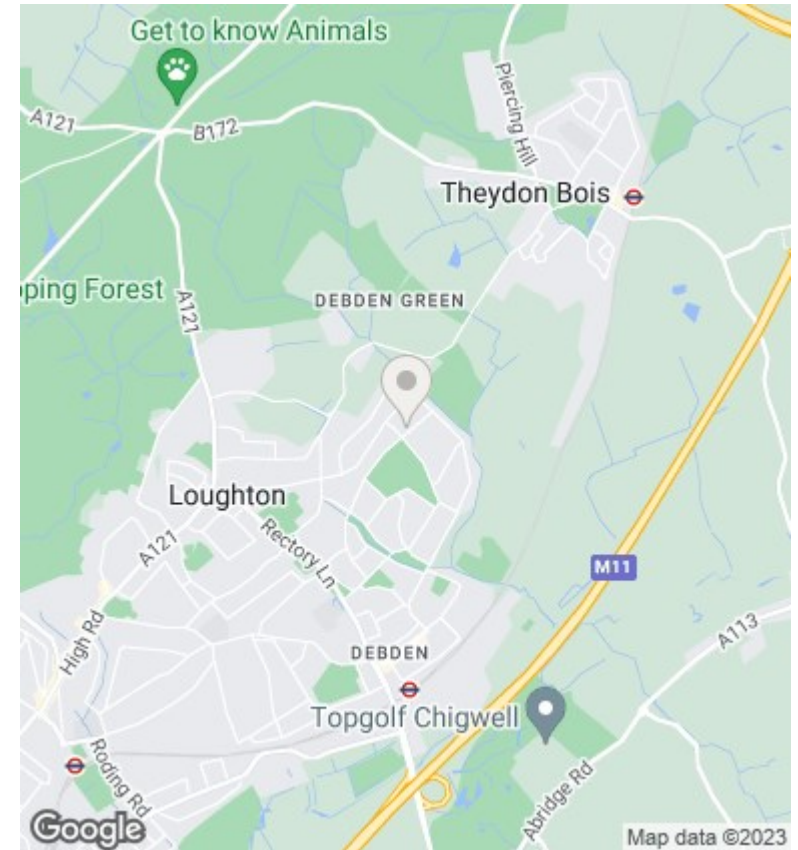

Viewings

Viewings by arrangement only.
 Call 012772822222 to make an appointment.

Council Tax Band

C

EPC Rating:

Energy Efficiency Rating		Current	Potential
<i>Very energy efficient - lower running costs</i>			
(92 plus) A			
(81-91) B			
(69-80) C			
(55-68) D			
(39-54) E			
(21-38) F			
(1-20) G			
<i>Not energy efficient - higher running costs</i>			
England & Wales		EU Directive 2002/91/EC	