

DURDEN & HUNT

INTERNATIONAL



High Street, Waltham Cross EN8

£1,400 Per Month

- Open Plan Kitchen And Living Room
- Deeded Private Garden
- Semi-Detached Bungalow
- Spacious Bedroom With Fitted Wardrobes
- Secure Gated Parking
- Family Bathroom
- Excellent Transport Links

159 High Street, Hornchurch, Essex, RM11 3YD
01277282222

lettings@durdenandhunt.co.uk
<https://www.durdenandhunt.co.uk>

Temple Court
 Approx. Gross Internal Area 465 Sq Ft - 43.20 Sq M

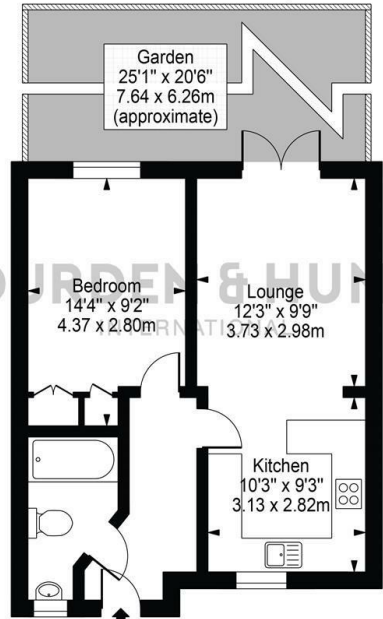

Ground Floor
 For Illustration Purposes Only - Not To Scale

This floor plan should be used as a general outline for guidance only and does not constitute in whole or in part an offer or contract. Any intending purchaser or lessee should satisfy themselves by inspection, searches, enquiries and full survey as to the correctness of each statement. Any areas, measurements or distances quoted are approximate and should not be used to value a property or be the basis of any sale or let.

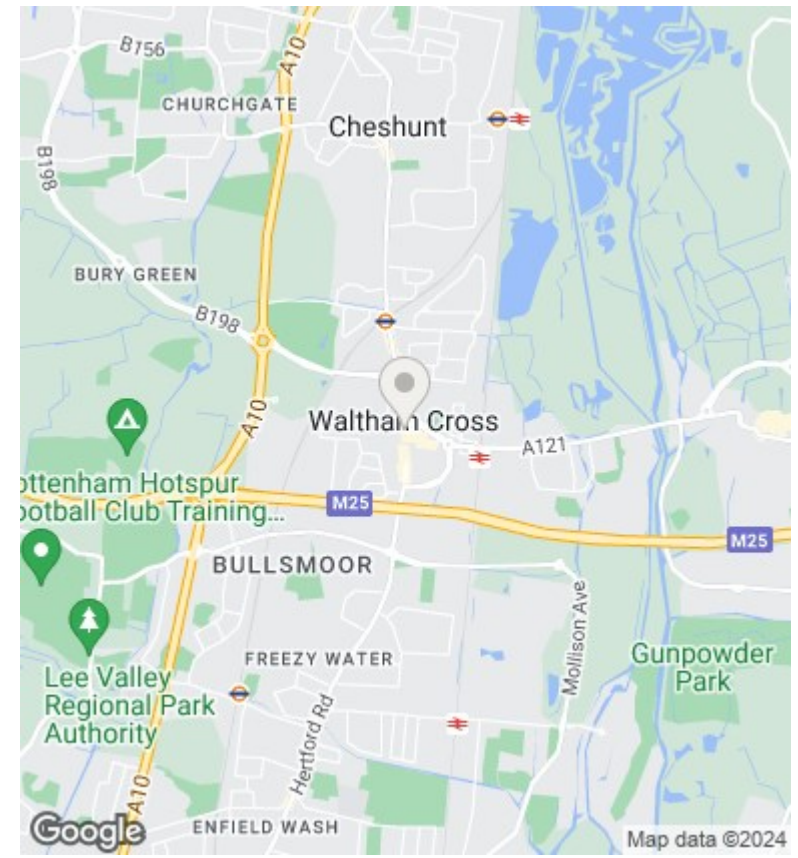

Viewings

Viewings by arrangement only.
 Call 01277282222 to make an appointment.

Council Tax Band

C

EPC Rating:

C

Energy Efficiency Rating		
	Current	Potential
Very energy efficient - lower running costs		
(92 plus) A		92
(81-91) B	75	
(69-80) C		
(55-68) D		
(39-54) E		
(21-38) F		
(1-20) G		
Not energy efficient - higher running costs		
England & Wales	EU Directive 2002/91/EC	