

# DURDEN & HUNT

INTERNATIONAL



## Alderwood Drive, Romford RM4

Offers In Excess Of £700,000

- Modern Kitchen with Pantry and Dining Area
- Downstairs Shower Room
- Garden with Patio and Decking Area
- Three Spacious Reception Rooms
- Three Bedrooms, Two with Fitted Wardrobes
- Private Driveway
- Separate Utility Room
- Family Shower Room
- Excellent Transport Links

309 High Road, Loughton, Essex, IG10 1AL  
0203 026 0160

[loughton@durdenandhunt.co.uk](mailto:loughton@durdenandhunt.co.uk)  
<https://www.durdenandhunt.co.uk/>

Alderwood Drive  
 Approx. Gross Internal Area 1629 Sq Ft - 151.37 Sq M

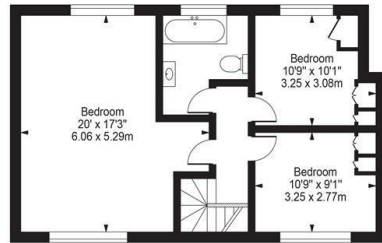

First Floor

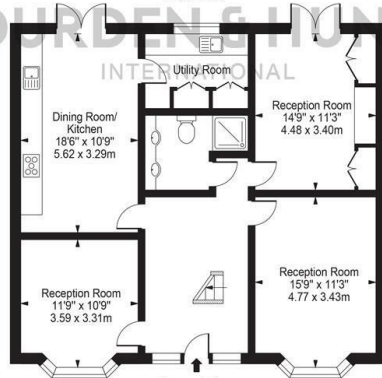

Ground Floor

For Illustration Purposes Only - Not To Scale

This floor plan should be used as a general outline for guidance only and does not constitute in whole or in part an offer or contract. Any intending purchaser or lessee should satisfy themselves by inspection, searches, enquiries and full survey as to the correctness of each statement. Any areas, measurements or distances quoted are approximate and should not be used to value a property or be the basis of any sale or let.

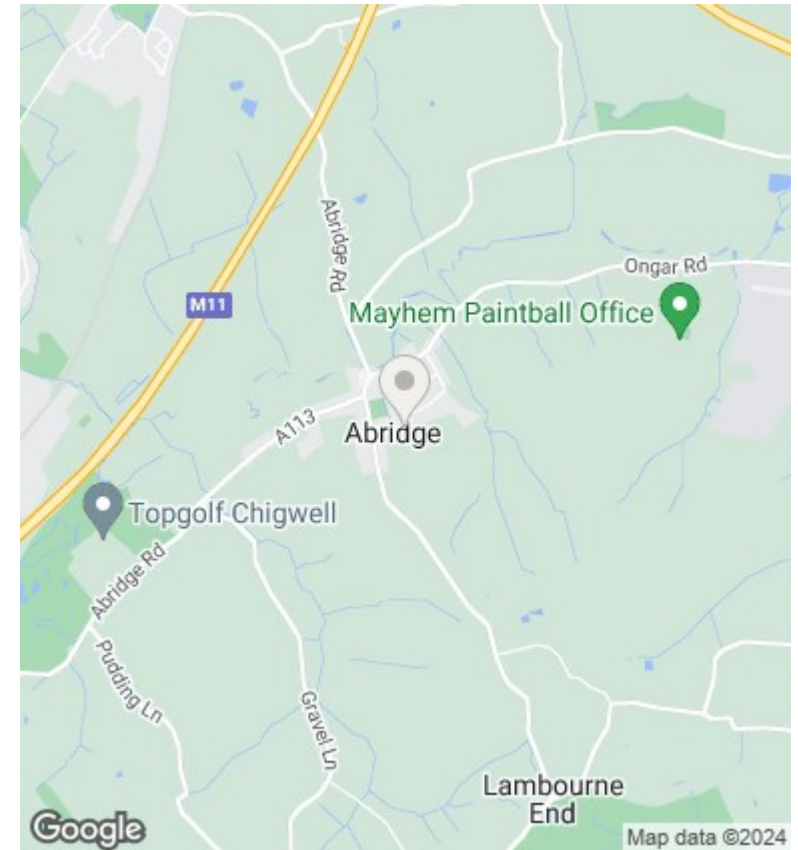

## Viewings

Viewings by arrangement only. Call 0203 026 0160 to make an appointment.

## Council Tax Band

F

## EPC Rating:

C

